



Comhairle Cathrach
Bhaile Átha Cliath
Dublin City Council

Planning and Property Development Department
Civic Offices
22/10/2019

To the Chairperson and Members of
The South East Area Committee

Meeting: 11 Nov 2019
Item No

With reference to the proposed transfer of the residue of a leasehold interest in a plot to the rear of 34 Sandford Road, Ranelagh, Dublin 6

An application has been received from Chester and Diana Reid, the owners of no 34 Sandford Road, Ranelagh, Dublin 6, to purchase a landlocked plot of ground measuring 24 sqm at the rear of their property which has been incorporated into their garden for over 20 years. The subject plot is shown outlined red on the attached map index no SM-2019-1046. Dublin City Council acquired a leasehold interest from Windale Limited in 1974 which is registered on Folio DN72418L.

The Chief Valuer reports that agreement has been reached with the applicant subject to the following Terms and Conditions which he considers to be fair and reasonable:

1. The subject plot comprises an area of 24 sq. metres and is shown indicatively outlined in red on the attached map ref SM- 2019-1046.
2. The Council will dispose of the subject plot comprising 24 sqm at €25 per sqm for the consideration of €600 (six hundred euro)
3. The Council will transfer the residue of its leasehold title in the subject plot.
4. The applicants will be responsible for their own legal fees in the matter and €1,500 (one thousand five hundred euro) plus VAT towards Dublin City Council legal fees
5. The applicant holds the freehold title or equivalent interest in their respective property.
6. The applicant is deemed to purchase the property with full knowledge of its actual state, condition, and structure, and will take it as it stands subject to any right of way, water, light, drainage or other easement, right or privilege and be familiar with its boundaries, fences and walls.

No agreement enforceable at law is created or is intended to be created until exchange of contracts has taken place.

Paul Clegg
Executive Manager

30/10/2019
Date

N: 731827.21

E: 716826.02

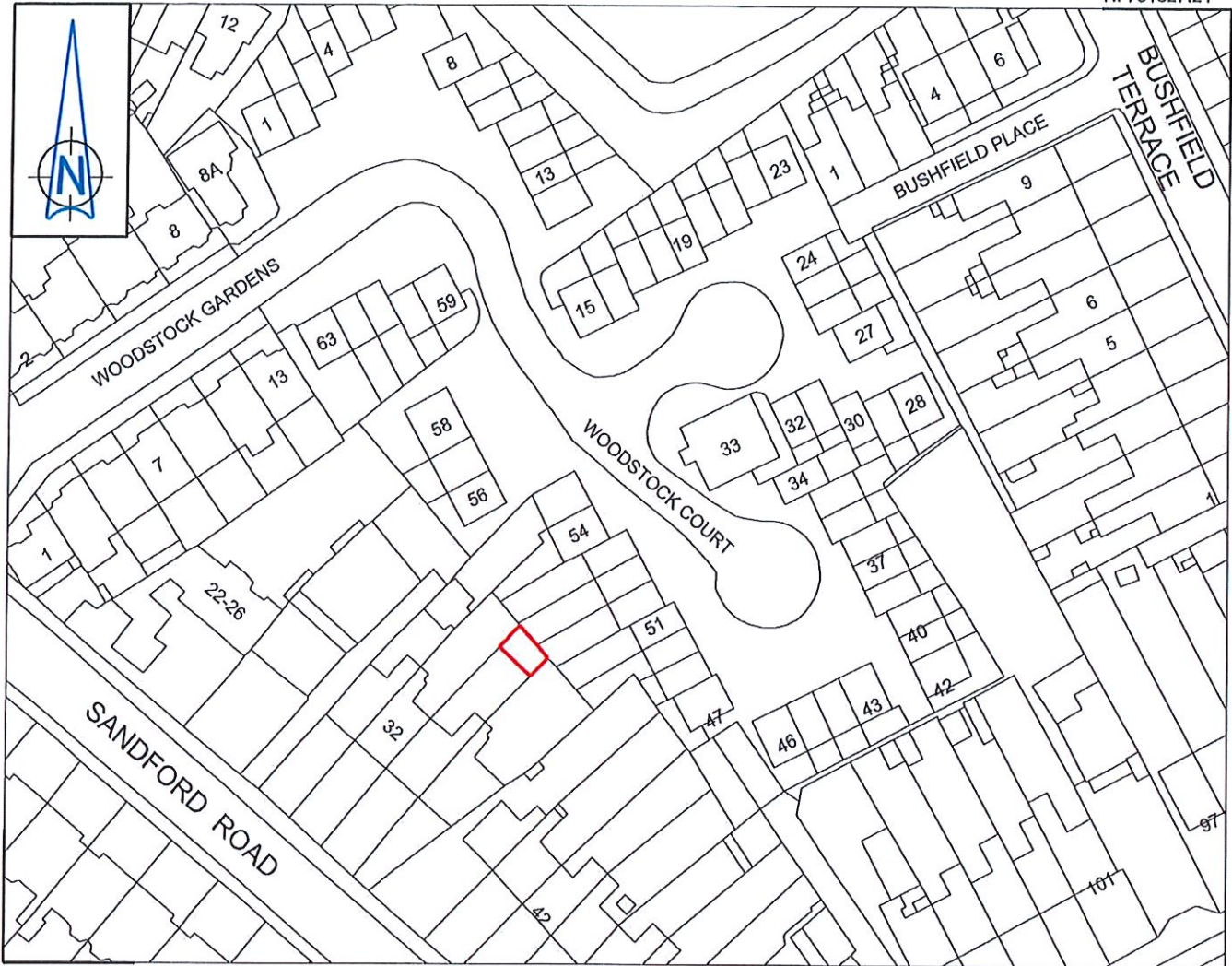

E: 716838.93

N: 731683.25

34 Sandford Road - Lands to rear of

Dublin City Council to Chester Reid & Diana Reid

Portion of Leasehold Title



Comhairle Cathrach
Bhaile Átha Cliath
Dublin City Council

An Roinn Comhshaoil agus Iompair
Rannán Suirbhéireachta agus Léarscáilthe
Environment and Transportation Department
Survey and Mapping Division

O.S REF

3329-01 & 3329-02

SCALE

1:1000

DATE

20-09-2019

**SURVEYED /
PRODUCED BY**
A-M Murphy

INDEX No

FOLDER
No

CODE

DWG
No

REV

FILE NO

SM-2019-1046-0204- C3 - 001 - A.dgn

THIS MAP IS CERTIFIED TO BE COMPUTER GENERATED BY
DUBLIN CITY COUNCIL FROM ORDNANCE SURVEY DIGITAL MAPBASE
SURVEY, MAPPING AND RELATED RESEARCH APPROVED

APPROVED

THOMAS CURRAN

ACTING MANAGER LAND SURVEYING & MAPPING
DUBLIN CITY COUNCIL

INDEX No.

SM-2019-1046

Dr JOHN W. FLANAGAN

CEng FIEI FICE
CITY ENGINEER