



With reference to the proposed Disposal of multiple plots to the rear of properties 11-17 Gortmore Drive, Finglas, Dublin 11.

When Dublin City Council proposed to construct 40 rapid build homes the owners of adjacent homes Nos. 11- 17 Gortmore Drive voiced objections. The concerns in the main related to the protection of an existing line of trees and the properties backing directly onto the site of the proposed development.

Following consultation it was proposed by the North West Area Office to reduce the number of rapid build homes to 39 and to construct a new boundary wall 7 metres from the existing rear boundaries of the properties to incorporate and therefore protect the line of existing trees which are now within the subject plots. In so doing the residents gain an additional plot each at the rear of their existing gardens which vary in size from 38- 65 sq m. New party fence divisions have also been constructed.

The land is owned in Fee Simple by Dublin City Council. The proposed sites are outlined red on the attached Maps SM- 2017-0399 to 0405. Agreement has now been reached for the disposal of the Council's interest in the plots subject to the following terms and conditions which are considered to be fair and reasonable:

1. That Dublin City Council disposes of the Council's interest with no consideration in the subject plots at no's 11-17 (Inclusive) Gortmore Drive, Finglas, Dublin 11 to the homeowners set out in the schedule below.

House Number	Applicant	SQM	Map Ref
11 Gortmore Drive	Elizabeth Kearney	48	SM-2017-0399
12 Gortmore Drive	David & Ann Perkins	41	SM-2017-0400
13 Gortmore Drive	Thomas Fitzpatrick	36	SM-2017-0401
14 Gortmore Drive	Maeve Deegan	38	SM-2017-0402
15 Gortmore Drive	Brigidine Sisters	38	SM-2017-0403
16 Gortmore Drive	Eamonn & Breda Redmond	65	SM-2017-0404
17 Gortmore Drive	Sandra & Thomas Devlin	61	SM-2017-0405

2. That the subject plots are shown outlined in red on the attached map Index No. SM-2017-0399 to 0405.
3. That Dublin City Council shall transfer the freehold title or equivalent in the subject plots.
4. The applicants shall be responsible for demolishing and disposing of the original existing rear walls and bear the cost of same.
5. That the applicants hold the freehold title or equivalent interest in their respective properties no's 11-17 Gortmore Drive, Finglas, Dublin 11.

6. Dublin City Council shall be responsible for its own legal fees in the matter.
7. The disposal shall be subject to any such covenants and conditions as the Law Agent in his discretion shall stipulate.

DCC acquired the fee simple in the property from Reps John Craigie in 1968 and are registered to DCC under Folio DN1894

No agreement enforceable at law is created or intended to be created until exchange of contracts has taken place.

This proposal was approved by the North West Area Committee at its meeting on 16 July 2019.

This report is submitted in accordance with the requirements of Section 183 of the Local Government Act, 2001.

Resolution to be adopted

“That Dublin City Council notes the contents of Report No. 244/2019 and assents to the proposal outlined therein”

Paul Clegg

A/Assistant Chief Executive

9th August 2019



17 GORTMORE DRIVE, FINGLAS, D11

(Land at rear of)

MAP FOR DISPOSAL

Dublin City Council to Sandra Devlin & Thomas Devlin

Area = 61.6 sqm



Comhairle Cathrach
Bhaile Átha Cliath
Dublin City Council

An Roinn Comhshaoil agus Iompair
Rannán Suirbhéireachta agus Léarscáilthe
Environment and Transportation Department
Survey and Mapping Division

O.S REF

3131-22

SCALE

1:1000

DATE

28.08.2017

SURVEYED /
PRODUCED BY

AA

INDEX No

FOLDER
No

CODE

DWG
No

REV

FILE NO

SM-2017-0405-_0204- C3 - 001 - A.dgn

THIS MAP IS CERTIFIED TO BE COMPUTER GENERATED BY
DUBLIN CITY COUNCIL FROM ORDNANCE SURVEY DIGITAL MAPBASE

SURVEY, MAPPING AND RELATED RESEARCH APPROVED

APPROVED

THOMAS CURRAN

ACTING MANAGER LAND SURVEYING & MAPPING
DUBLIN CITY COUNCIL

INDEX No.

SM-2017-0405-001

JOHN W. FLANAGAN

PhD CEng Eur Ing FIEI FICE

ACTING CITY ENGINEER

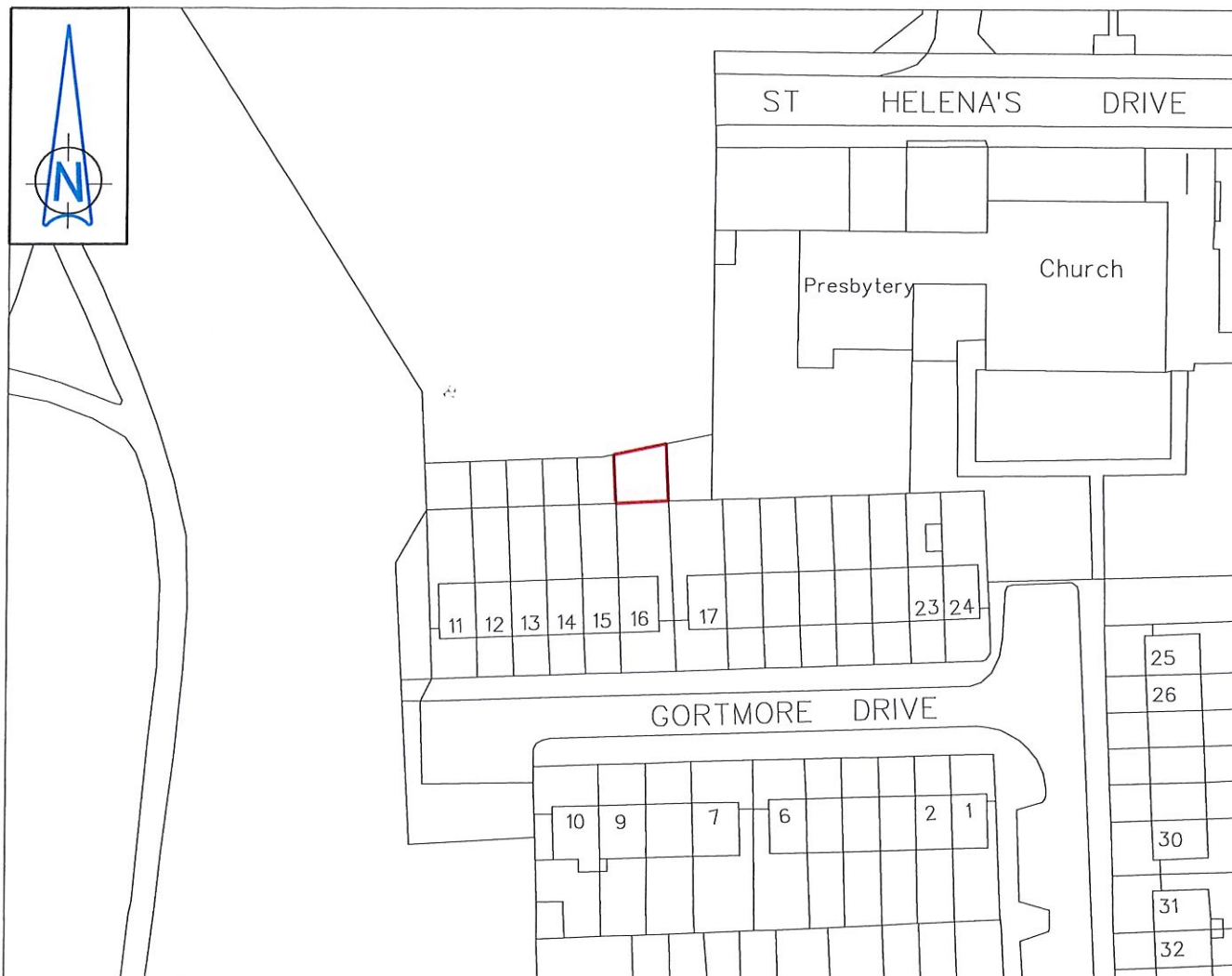

16 GORTMORE DRIVE, FINGLAS, D11

(Land at rear of)

MAP FOR DISPOSAL

Dublin City Council to Eamonn Redmond & Breda Redmond

Area = 65.0 sqm



Comhairle Cathrach
Bhaile Átha Cliath
Dublin City Council

An Roinn Comhshaoil agus Iompair
Rannán Suirbhéireachta agus Léarscáilthe
Environment and Transportation Department
Survey and Mapping Division

O.S REF

3131-22

SCALE

1:1000

DATE

28.08.2017

SURVEYED /
PRODUCED BY

AA

FILE NO

SM-2017-0404-_0204- C3 - 001 - A.dgn

INDEX No

FOLDER
No

CODE

DWG
No

REV

THIS MAP IS CERTIFIED TO BE COMPUTER GENERATED BY
DUBLIN CITY COUNCIL FROM ORDNANCE SURVEY DIGITAL MAPBASE
SURVEY, MAPPING AND RELATED RESEARCH APPROVED

APPROVED

THOMAS CURRAN

ACTING MANAGER LAND SURVEYING & MAPPING
DUBLIN CITY COUNCIL

INDEX No.

SM-2017-0404-001

JOHN W. FLANAGAN

PhD CEng Eur Ing FIEI FICE

ACTING CITY ENGINEER



15 GORTMORE DRIVE, FINGLAS, D11

(Land at rear of)

MAP FOR DISPOSAL

Dublin City Council to Brigidine Sisters

Area = 38.3 sqm



Comhairle Cathrach
Bhaile Átha Cliath
Dublin City Council

An Roinn Comhshaoil agus Iompair
Rannán Suirbhéireachta agus Léarscáilthe
Environment and Transportation Department
Survey and Mapping Division

O.S REF

3131-22

SCALE

1:1000

DATE

28.08.2017

SURVEYED /
PRODUCED BY
AA

INDEX No

FOLDER
No

CODE

DWG
No

REV

FILE NO

SM-2017-0403-_0204- C3 - 001 - A.dgn

THIS MAP IS CERTIFIED TO BE COMPUTER GENERATED BY
DUBLIN CITY COUNCIL FROM ORDNANCE SURVEY DIGITAL MAPBASE
SURVEY, MAPPING AND RELATED RESEARCH APPROVED

APPROVED

THOMAS CURRAN

ACTING MANAGER LAND SURVEYING & MAPPING
DUBLIN CITY COUNCIL

INDEX No.

SM-2017-0403-001

JOHN W. FLANAGAN
PhD CEng Eur Ing FIEI FICE
ACTING CITY ENGINEER



14 GORTMORE DRIVE, FINGLAS, D11

(Land at rear of)

MAP FOR DISPOSAL

Dublin City Council to Meave Deegan

Area = 38.5 sqm



Comhairle Cathrach
Bhaile Átha Cliath
Dublin City Council

An Roinn Comhshaoil agus Iompair
Rannán Suirbhéireachta agus Léarscáilithe
Environment and Transportation Department
Survey and Mapping Division

O.S REF

3131-22

SCALE

1:1000

DATE

28.08.2017

SURVEYED /
PRODUCED BY
AA

INDEX No

FOLDER
No

CODE

DWG
No

REV

FILE NO

SM-2017-0402-_0204- C3 - 001 - A.dgn

THIS MAP IS CERTIFIED TO BE COMPUTER GENERATED BY
DUBLIN CITY COUNCIL FROM ORDNANCE SURVEY DIGITAL MAPBASE
SURVEY, MAPPING AND RELATED RESEARCH APPROVED

APPROVED

THOMAS CURRAN

ACTING MANAGER LAND SURVEYING & MAPPING
DUBLIN CITY COUNCIL

INDEX No.

SM-2017-0402-001

JOHN W. FLANAGAN
PhD CEng Eur Ing FIEI FICE
ACTING CITY ENGINEER



13 GORTMORE DRIVE, FINGLAS, D11

(Land at rear of)

MAP FOR DISPOSAL

Dublin City Council to Thomas Fitzpatrick

Area = 36.3 sqm



Comhairle Cathrach
Bhaile Átha Cliath
Dublin City Council

An Roinn Comhshaoil agus Iompair
Rannán Suirbhéireachta agus Léarscáilthe
Environment and Transportation Department
Survey and Mapping Division

O.S REF

3131-22

SCALE

1:1000

DATE

28.08.2017

SURVEYED /
PRODUCED BY

AA

INDEX No

FOLDER
No

CODE

DWG
No

REV

FILE NO

SM-2017-0401-_0204- C3 - 001 - A.dgn

THIS MAP IS CERTIFIED TO BE COMPUTER GENERATED BY
DUBLIN CITY COUNCIL FROM ORDNANCE SURVEY DIGITAL MAPBASE

SURVEY, MAPPING AND RELATED RESEARCH APPROVED

APPROVED

THOMAS CURRAN

ACTING MANAGER LAND SURVEYING & MAPPING
DUBLIN CITY COUNCIL

INDEX No.

SM-2017-0401-001

JOHN W. FLANAGAN

PhD CEng Eur Ing FIEI FICE

ACTING CITY ENGINEER



12 GORTMORE DRIVE, FINGLAS, D11

(Land at rear of)

MAP FOR DISPOSAL

Dublin City Council to David Perkins & Ann Perkins

Area = 41.1 sqm



Comhairle Cathrach
Bhaile Átha Cliath
Dublin City Council

An Roinn Comhshaoil agus Iompair
Rannán Suirbhéireachta agus Léarscáilithe

Environment and Transportation Department
Survey and Mapping Division

O.S REF

3131-22

SCALE

1:1000

DATE

28.08.2017

SURVEYED /
PRODUCED BY
AA

FILE NO

SM-2017-0400-_0204- C3 - 001 - A.dgn

INDEX No

FOLDER
No

CODE

DWG
No

REV

THIS MAP IS CERTIFIED TO BE COMPUTER GENERATED BY
DUBLIN CITY COUNCIL FROM ORDNANCE SURVEY DIGITAL MAPBASE
SURVEY, MAPPING AND RELATED RESEARCH APPROVED

APPROVED

THOMAS CURRAN

ACTING MANAGER LAND SURVEYING & MAPPING
DUBLIN CITY COUNCIL

INDEX No.

SM-2017-0400-001

JOHN W. FLANAGAN

PhD CEng Eur Ing FIEI FICE

ACTING CITY ENGINEER



11 GORTMORE DRIVE, FINGLAS, D11

(Land at rear of)

MAP FOR DISPOSAL

Dublin City Council to Elizabeth Kearney

Area = 48.7 sqm



Comhairle Cathrach
Bhaile Átha Cliath
Dublin City Council

An Roinn Comhshaoil agus Iompair
Rannán Suirbhéireachta agus Léarscáilithe
Environment and Transportation Department
Survey and Mapping Division

O.S REF

3131-22

SCALE

1:1000

DATE

28.08.2017

SURVEYED /

PRODUCED BY
AA

FILE NO

INDEX No

FOLDER
No

CODE

DWG
No

REV

SM-2017-0399-_0204- C3 - 001 - A.dgn

THIS MAP IS CERTIFIED TO BE COMPUTER GENERATED BY
DUBLIN CITY COUNCIL FROM ORDNANCE SURVEY DIGITAL MAPBASE

SURVEY, MAPPING AND RELATED RESEARCH APPROVED

APPROVED

THOMAS CURRAN

ACTING MANAGER LAND SURVEYING & MAPPING
DUBLIN CITY COUNCIL

INDEX No.

SM-2017-0399-001

JOHN W. FLANAGAN

PhD CEng Eur Ing FIEI FICE

ACTING CITY ENGINEER