

PROPOSED PLAN  
SCALE BAR 1:200

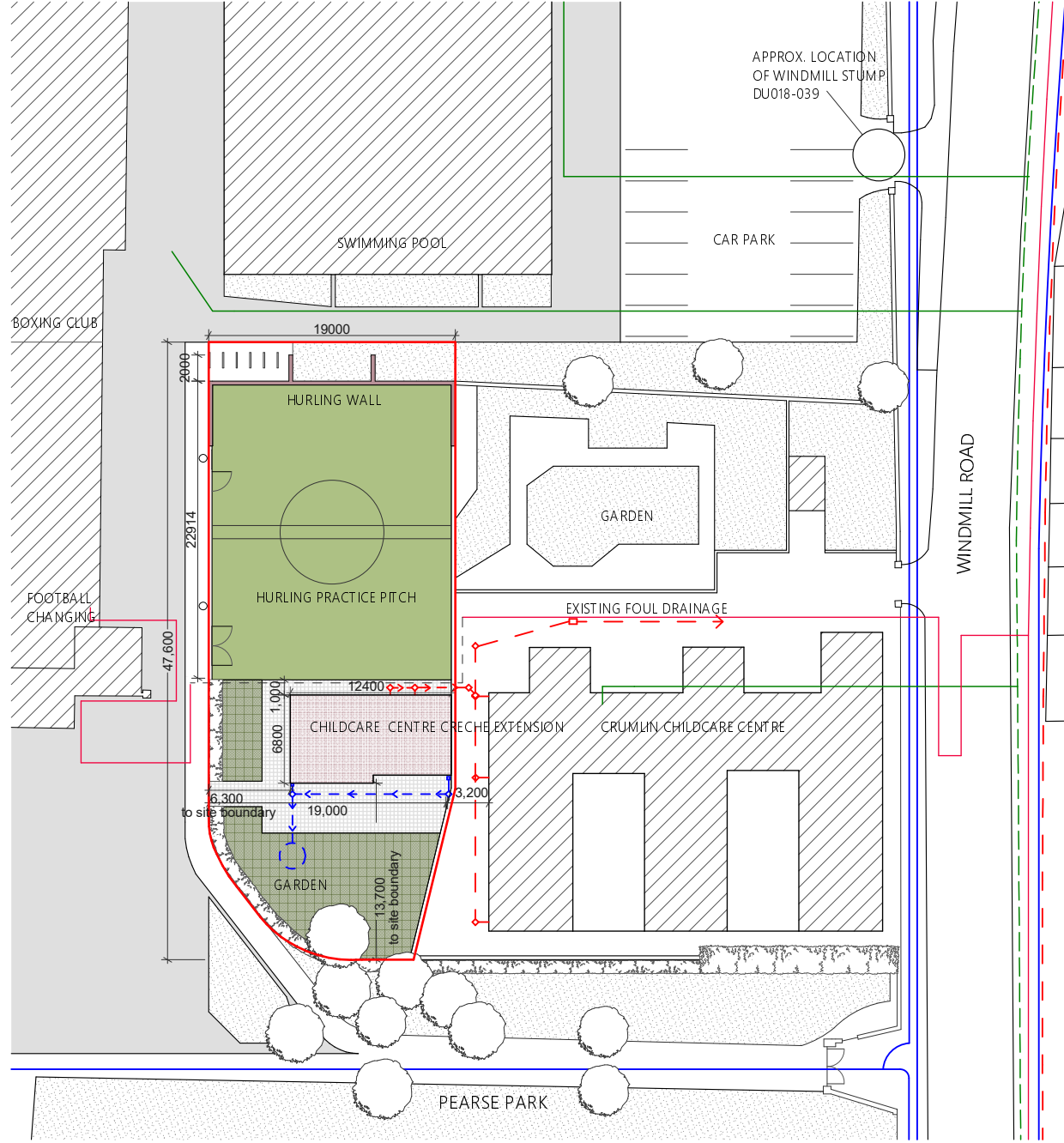

SITE LAYOUT MAP  
SCALE BAR 1:500

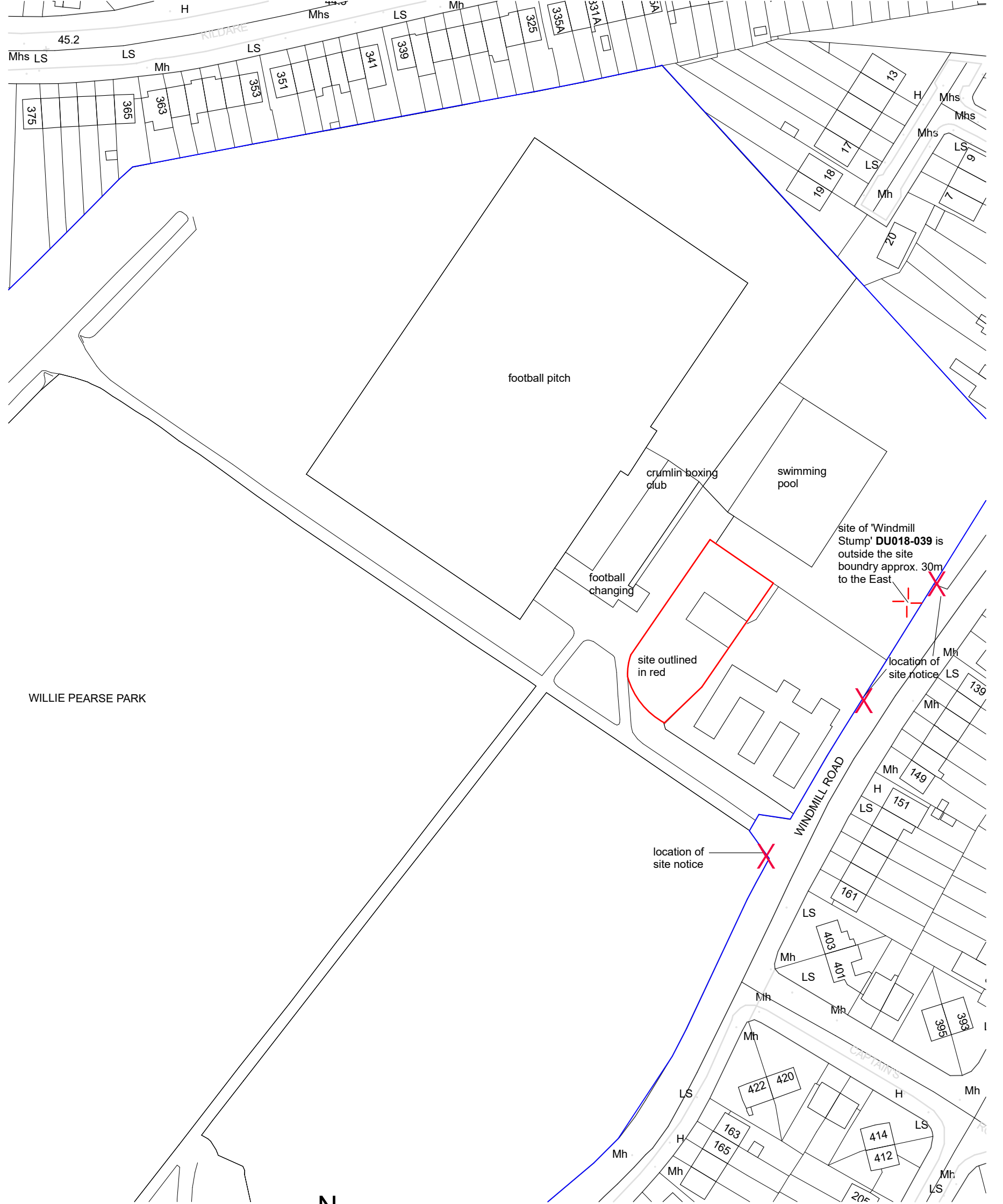

PEARSE PARK OS MAP  
SCALE BAR 1:1000

ISSUED FOR PART 8			
PROJECT PROPOSED HURLING WALL, PEARSE MEMORIAL PARK, CRUMLIN, DUBLIN 12			JOB. NO. 18 PRS
DRAWING PROPOSED PLANS			REVISION
DRAWN BY JC			P8
DRAWING NO. 201	SCALE 1:200, 1:500, 1:1000	DATE MAY 2018	

KEY	
LOCATION OF SITE NOTICE	X
SITE BOUNDARY LINE	—
OTHER LAND IN OWNERSHIP	—
PROPOSED NEW STRUCTURE	—
PROPOSED NEW BUILDING	—
PROPOSED HURLING PITCH	—
SURROUNDING BUILDINGS	—

GAS SERVICE UNDERGROUND PIPELINE	—
GAS INSERTED PIPELINE	—
MV/LV UNDERGROUND POWERLINE DIVERTED	—
MV/LV UNDERGROUND POWERLINE	—
IRISH WATER	—
PROPOSED FOUL DRAINAGE	—
PROPOSED SURFACE DRAINAGE	—
EXISTING FOUL DRAINAGE	—

DORMAN architects	
C 1 THE STEELWORKS FOLEY STREET DUBLIN 1 IRELAND	
TEL 01 855 9057 FAX 01 855 9059 email info@dorman.ie web www.dorman.ie	
REVISION	
CONFIRM DIMS ON SITE BEFORE FABRICATION OFF SITE. REFER ANY DISCREPANCIES TO ARCHITECT. DRAWINGS ARE NOT TO BE SCALED. USE FIGURED DIMENSIONS ONLY. THESE DRAWINGS ARE PROTECTED BY COPYRIGHT.	