



Comhairle Cathrach
Bhaile Átha Cliath
Dublin City Council

To the Chairperson and Members of the Central Area Committee

Proposed Alterations to Royal Canal Phase 4 Cycle Scheme

**Christopher K Manzira
Senior Transportation Officer
Sustainable Mobility and Projects
Environment & Transportation Department**

July 1st 2021

NOTICE

The Environment & Transportation Department would like to notify the Central Area Committee of Dublin City Council's intention to lodge an amending Part 8 application in July 2021 in relation to Phase 4 of the Royal Canal Greenway Cycle Scheme.

Phases 2, 3 and 4 of the Royal Canal Greenway, between Sheriff Street Upper, Dublin 1 and Ashtown, Dublin 15, were granted permission under Part VIII application number 2870/15.

The design objectives of the Royal Canal Greenway Scheme are:

- The development of a premium pedestrian and cycle route;
- The provision of public lighting;
- The provision of universal access; and
- The promotion of sustainable transport.

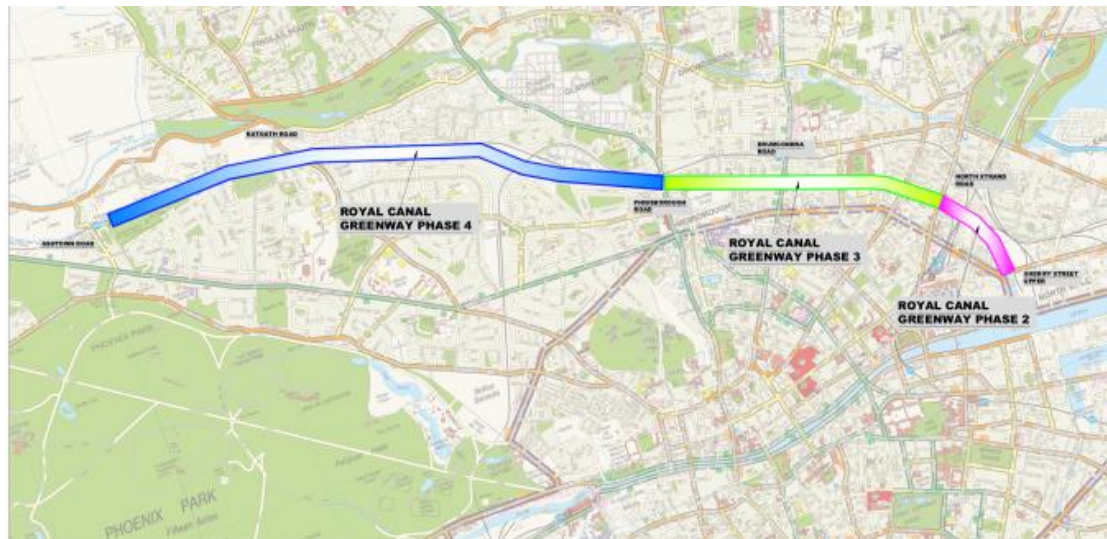

Fig. 1: Royal Canal Greenway Phases 2, 3 and 4

The following material changes are proposed:

- Narrowing of the canal to provide a wider towpath over three separate sections along the route

During the detailed design of Phase 4 of the scheme, which runs between Cross Gun Quay at Phibsborough and Ashtown, Dublin 15, it was established that a design solution involving widening of the canal towpath into the canal side would be preferable to acquiring land on the northern boundary of the route.

Further to discussions with Waterways Ireland, it is now proposed to widen the canal towpath on the canal side along three sections of the route. It is proposed that approximately 1km of the canal bank will be altered over three separate sections in order to provide adequate space for users of the greenway. This includes providing improved access to and from the Coke Oven Cottages.

The works proposed to the canal will allow for protection of the habitats corridors along the canal.

The sections where amendments are proposed are:

- 1) Section 1: 80.5 metres west of Ratoath Road to the rear of Campbell's Garage
- 2) Section 2: 346.7 metres west of Broombridge Road
- 3) Section 3: 591.1 metres from west of Coke Oven Cottages to the 6th lock

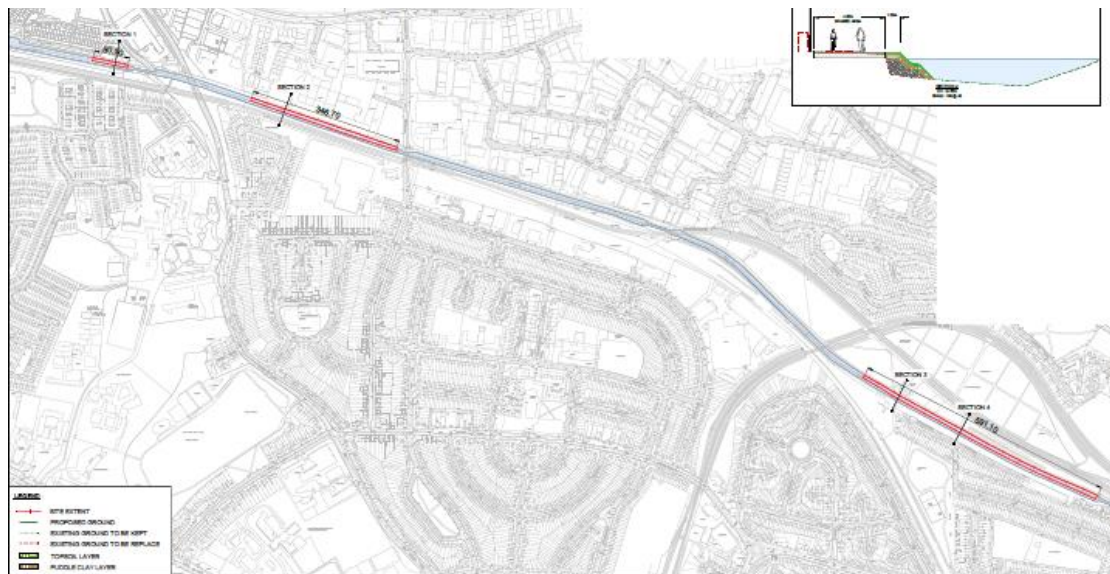

Fig. 2: Three sections along Royal Canal where it is proposed to widen the towpath by narrowing the canal.

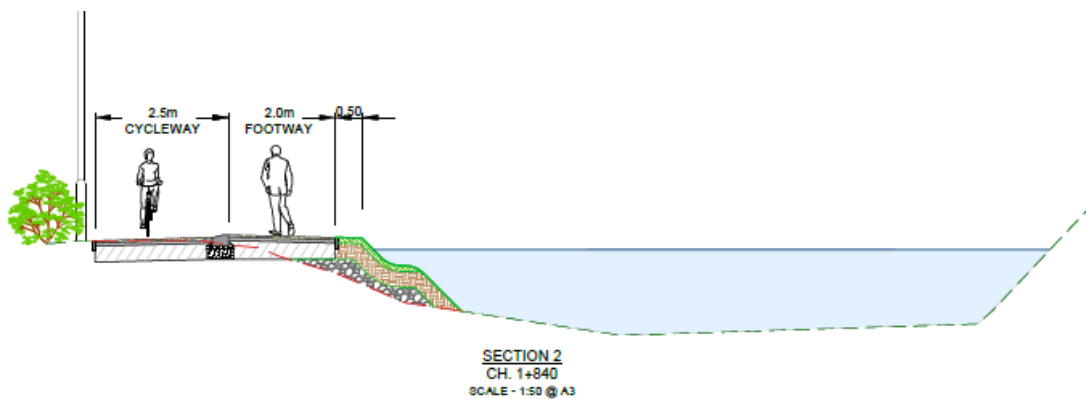

Fig. 3: Proposal for Section 2: West of Broombridge.



Fig. 4: Existing view of Section 3: Looking eastward from Coke Oven Cottages.

The changes outlined above require an amending Part 8 application. The works will be funded wholly by the National Transport Authority.

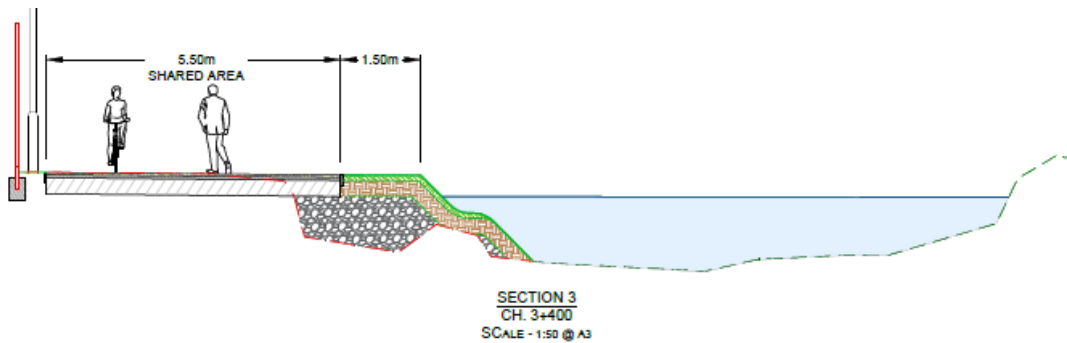

Fig. 5: Proposal for shared space along Section 3 of Royal Canal Greenway Phase 4 looking eastward from Coke Oven Cottages.

Attachments:

1. **2021.07.02 Royal Canal Greenway Phase 4 Locations of Proposed Amendments with Section Details.pdf**