



Comhairle Cathrach
Bhaile Átha Cliath
Dublin City Council

NORTH WEST AREA COMMITTEE

COISTE CHEANTAR AN IARTUAISCIRT

To each member of the North West Area Committee (Ballymun and Cabra/Finglas, Local Electoral Areas).

Notification to attend the monthly meeting of the above committee to be held in the North West Area, Council Chamber, Civic Offices, Main Street, Ballymun, Dublin 9 on Tuesday 15th March 2016 at **2.30p.m** to deal with the items on the attached Agenda.

Dated this Friday 11th March 2016

Dave Dinnigan

Area Manager

Contacts:
Bridget Gilbert/Mary Bellew
North West Area,
Finglas Civic Centre,
Mellowes Road,
Finglas.

Tel: 222 7878 / 222 5728

Fax: 834 6431 / 856 7016

E-mail: northwestarea@dublincity.ie
Bridget.gilbert@dublincity.ie; mary.bellew@dublincity.ie

NORTH WEST AREA COMMITTEE MEETING

AGENDA

TUESDAY 15th March 2016

1. Minutes of the North West Area Committee Meeting held on Tuesday 16th February 2016 **(Copy attached pages 4-8)**.
2. Questions to the Area Manager **(Copy attached pages 9-14)**.

Cabra Matters

3. Cabra Area Office Report, Fergus Synnott, Administrative Officer **(Report attached Pages 15-18)**.

Finglas Matters

4. Finglas Area Office Report, Aidan Maher, Assistant Area Manager **(Report attached pages 19-24)**.
5. Better Finglas Presentation, Joe Twomey, Dervla White, Better Finglas.
6. With reference to the proposed grant of a further licence for the rear of the premises 5 Cardiffsbridge Road, Finglas, Dublin 11 **(Report attached pages 25-27)**.

Motions:

7. **Motion in the name of Councillor Anthony Connaghan**

That the Manager confirms that any building project on the Scribblestown site is confined to the railed off area to the front of the estate and does not impinge on the current park/play area which runs adjacent to Scribblestown Lane. The current zoning map shows an encroachment onto this park and residents are worried that development could happen here.

Area Wide Matters

8. Allocation of 2016 Local Service Funding to the North West Area **(Report attached pages 28-30)**.
9. Works Programme 2016 **(Report attached pages 31-34)**.
10. Draft Tree Strategy Consultation, Marc Coyle, Arborist & Landscape Architect, Parks Service.
11. Metro Dublin Development, CEO Cormac Rabbitt, Metro Dublin **(Report attached pages 35-43)**
12. Traffic Service Requests, Status Report dated **(Report attached pages 44-67)**.

13. Public Domain Report, John Twamley, Public Domain Officer (**Report attached Pages 68-70**).
14. Sports & Recreation Report North West Area (**Report attached pages 71-72**).
15. Prioritising area motions submitted to City Council (**Report attached pages 73-74**).

Ballymun Matters

16. Information Session on submissions received on Ballymun Issue Papers for the LAP, Paul Clegg, Executive Manager, Pamela Connolly, Executive Planner, Planning & Property Development Department (**Report attached pages 75-93**).
17. Ballymun Area Office Report, Mary Taylor, Assistant Area Manager (**Report attached pages 94-103**).
18. With reference to the proposed grant of lease of 3 year licence of Workshop 3, & 4 Poppintree Neighbourhood Centre, Ballymun, Dublin 9, to Poppintree Environmental Project Limited. (**Report attached pages 104-106**).
19. Naming Proposal for Plaza on Ballymun Road, Dublin 9 – “**Cearnóg an tSeachtar Laoch**” (**Report attached pages 107-108**).

Motions:

20. **Motion in the name of Councillor Noeleen Reilly**

That the manager urgently looks at Traffic control at Poppintree Community Centre where it is very busy and residents living in Carton estate struggle to cross the road at times. A decision on the pedestrian crossing has been ongoing for a number of years now.

21. **Motion in the name of Councillor Andrew Montague**

That the Chief Executive ensure that the bus stop on the Swords Road opposite Omni, at the corner with Lorcan Road is kept clean. It's a particularly busy bus stop because of its proximity to the Omni. Residents say the bin often smells because it is not emptied often enough. It used to have a cigarette ashtray, but that was removed as it was never emptied, but recently the bin went on fire when a cigarette butt was put in the bin. This bus stop needs careful attention.

NORTH WEST AREA COMMITTEE MEETING

MINUTES

TUESDAY 16th February 2016

NWA/23/16 Minutes of the North West Area Committee Meeting held on Tuesday 19th January 2016.

ORDER: Agreed.

A special North West Area Committee Meeting will be held on 24th March at 3pm in the Finglas Civic Offices which will deal with a composite motion on Housing and Planning in Finglas.

Councillor Costello proposed that motions submitted to the City Council by the North West Area Committee be reviewed with the aim of prioritising the motions.

ORDER: Agreed.

NWA/24/16. Questions to the Area Manager (January)

ORDER: Noted. Replies circulated.

NWA/25/16. Nomination to the Cabra/Finglas Drug & Alcohol Task Force.

ORDER: Noted. Councillors invited to nominate a representative.

Cabra Matters

NWA/26/16. Cabra Area Office Report, Fergus Synnott, Administrative Officer.

ORDER: Noted.

NWA/27/16. Update on Dalymount Park Project, Brendan Kenny, Assistant Chief Executive, Jim Beggan, Senior Executive Officer, Community, Culture, Economic and Emergency Services.

ORDER: Noted.

NWA/28/16. Proposed Extinguishment of Public Right of Way over the laneway to the rear of 1-29 Kinvara Road, 3-55 Kinvara Avenue, Rear of 35-45 Kinvara Park.

ORDER: Recommend to City Council.

Finglas Matters

NWA/29/16. Finglas Area Office Report, Aidan Maher, Assistant Area Manager.

ORDER: Noted. Councillors welcomed a plan for a Men's Shed in Finglas and the proposal to locate it on the Kildonan Lands site. Councillors asked that they be informed when properties in An Riasc are being allocated.

NWA/30/16 With reference to the disposal of a plot of land to the rear of 47 McKee Avenue, Finglas, Dublin 11.

ORDER: Agreed.

Motions:

NWA/31/16. Motion in the name of Councillor Anthony Connaghan

Considering the housing crisis and scarcity of housing in the Dublin City Council area, this Area Committee directs the Manager to utilise the small vacant sites in the ownership of DCC at 2 Casement Grove, 307 Casement Road and 74-75 Fairlawn immediately to help reduce the housing list. Can the Manager investigate the possibility of 1 and 2 bed maisonette style housing to try and maximise the units per site.

ORDER: Sites at these locations will be part of the discussions at the Special Meeting on the 24th March.

NWA/32/16 Motion in the name of Councillor David Costello

That this council looks to support the retention of large retailers such as SUPERVALU in Finglas Village through a process consultation with retailers in relation to public domain improvements.

ORDER: Report to Councillor. Dublin City Council are anxious to keep anchor tenants in the village. The public domain in the area can be looked at in the context of a possible Local Environmental Improvement Plan.

NWA/33/16 Motion in the name of Councillor David Costello

That this council supports the establishment of a primary care service in the Finglas West/South area and would like to meet with the HSE to discuss their Plans and timelines.

ORDER: Report to Councillor.

NWA/34/16 Motion in the name of Councillor David Costello

Please provide the report in relation to communications between DCC and Tuath housing in relation to An Riasc as promised in the report to my motion last month. The delay in receiving this report is unacceptable.

ORDER: Deirdre Ni Raghallaigh, Senior Executive Officer, Housing Department provided details on the background context to the site's acquisition.

NWA/35/16 Motion in the name of Councillor David Costello

That this council supports the development of a family resource centre for Finglas West, Modelled on the good work carried out in St. Helena's.

ORDER: Report to Councillor.

Area Wide Matters

NWA/36/16 The Team Dublin Clean-up 2016, Brian Hanney, Waste Management Division.

ORDER: Noted.

NWA/37/16 Community Grants Scheme 2016.

ORDER: Noted

NWA/38/16 Traffic Service Requests, Status Report dated 16th February 2016.

ORDER: Noted.

NWA/39/16 Minutes of the Traffic Advisory Group (TAG) Meeting dated

ORDER: Noted.

NWA/40/16 Planning Enforcement Report October to December 2015, Fiacra Worrall, Assistant Enforcement Officer

ORDER: Noted.

NWA/41/16 Public Domain Report, John Twamley, Public Domain Officer

ORDER: Noted. John Twamley was invited to attend the next Drumcondra/Glasnevin Community Forum, Iona Residents Association Meeting and Ellenfield Resident Associations Meeting

NWA/42/16 Housing Allocation Report 2016 – Current Waiting Lists Statistics and 2015 Total Lettings Report.

ORDER: Noted.

NWA/43/16 Sports & Recreation Report North West Area

ORDER: Noted.

Motions:

NWA/44/16 **Motion in the name of Councillor Anthony Connaghan**

That the Manager provides up to date details for street sweeping in the Northwest Area. The schedule is supposed to be once every 12 weeks but a quick search on many streets (two examples provided) throughout the area it looks like the real frequency is once every 12 months.

ORDER: Motion taken with Presentation from Brian Hanney, Waste Management Division. Street cleaning is carried out every 12 weeks in accordance with Dublin City Council policy. The website was not being updated regularly to reflect this. This issue will soon be rectified.

Ballymun Matters

NWA/45/16 Presentation on proposed Ó' Cualann Cohousing Alliance CLG's plans for the co-op sites in Ballymun – Hugh Brennan, O' Cualann; Joe Kennedy and Tim Crowley, Housing Alliance.

ORDER: The Councillors welcomed the scheme. Report from O' Cualann Cohousing Alliance to be circulated to members.

NWA/46/16 Ballymun Area Office Report, Mary Taylor, Assistant Area Manager

ORDER: Noted

NWA/47/16 With reference to the proposed grant of lease of Workshop 1, Poppintree Neighbourhood Centre, Ballymun, Dublin 11 to Quinns Convenience Store Limited

ORDER: Deferred. Dave Dinnigan to arrange a meeting with Paul Clegg, Planning and Property Management and Planning Enforcement to discuss the issues with this tenancy.

NWA/48/16 With reference to the proposed grant of lease of Workshop 2, Poppintree Neighbourhood Centre, Ballymun, Dublin 11 to Garridebs Limited.

ORDER: Agreed to recommend to City Council.

Motions

NWA/49/16 **Motion in the name of Councillor Noeleen Reilly**

That this committee calls on the manager to remove the Ban on HAP for homeless families in Ballymun. I am consistently getting this response in relation to queries regarding families staying in hotels.

“However, I am pleased to confirm that the household is eligible for the “Housing Assistance Payment” (HAP) scheme which will greatly assist in accessing the private rental market. This means that they are eligible to be considered for one month’s advance deposit and one month rent in advance with differential rent payable to Dublin City Council”

For Homeless families in Ballymun this is not an adequate response as there is a ban in place. How many Ballymun families who were staying in Emergency accommodation last year found accommodation through HAP?

ORDER: Agreed. Mary Taylor will liaise with DCU and DIT and ask that they undertake social research on the implications of removing the ban on HAP in Ballymun. The new Chair of the Ballymun Town Civic Alliance is Deiric O’Bróin.

NWA/50/16 **Motion in the name of Councillor Noeleen Reilly**

That the Dublin Northwest Area Committee recognises the work youngballymun has done in the area over the last ten years in Early Childhood development and intervention. We call on the Minister for Children and Youth Affairs to cease all plans to close youngballymun and not only

continue to fund the programme in Ballymun but to look at rolling it out in other communities.

ORDER: A letter will be sent from the North West Area Committee requesting that the Minister retain youngballymun.

NWA/51/16 Motion in the name of Councillor Andrew Montague

That the manager addresses the issue of dog dirt in Poppintree Park. It's a great park for dog owners, but it needs to be kept clean for all the children that play in the park.

ORDER: Report to Councillor

NWA/52/16 Emergency Motion in the name of Councillors David Costello and Anthony Connaghan

That the Northwest Area Committee formally recognises Kildonan Lands Development Group and their efforts to draft a master plan for the area.

ORDER: Agreed. Report to Councillor

Attendance:

NWA Councillors:

ORDER:

Áine Clancy, Anthony Connaghan, Emma Murphy, Paul McAuliffe, Noeleen Reilly, Cathleen Carney Boud, David Costello, Seamus McGrattan, Andrew Montague.

Officials:

Dave Dinnigan, Area Manager, Mary Taylor (Senior Executive Officer), Aidan Maher (Senior Executive Officer), Donal Barron (Area Housing Manager – Ballymun), Catherine Quinlan (Senior Staff Officer), Derek Healy, Area Housing Manager, Fergus Synnott (Administrative Officer – Cabra), John Twamley (Public Domain Officer), Bridget Gilbert (Senior Staff Officer), Mary Bellew (Staff Officer), Neil O'Donoghue (Traffic Engineer, NWA), Brid Brosnan (Parks and Landscape Services), Fiacra Worrell, Planning Enforcement, Helen Smirnova, Traffic, Deirdre Ni Raghallaigh, Senior Executive Officer, Housing Department, Jim Beggan, Senior Executive Officer, Community, Culture, Economic and Emergency Services., Brian Hanney, Senior Executive, Officer, Waste Management Division.

Consultants: Ó'Cualann Cohousing Alliance CLG - Hugh Brennan, O'Cualann; Joe Kennedy and Tim Crowley,

Apologies: Councillors Teresa Keegan, Noel Rock, Cieran Perry and Andrew Keegan

**Councillor Áine Clancy
Chairperson**

The meeting concluded at 17.30

Questions to the Area Manager

North West Area Committee

Meeting 15th March 2016

Q .1 Councillor Anthony Connaghan

To ask the Manager to arrange for repair to the flat roof at (details supplied).

Q .2 Councillor Anthony Connaghan

To ask the Manager to arrange for a full inspection of the report damp problems at (details supplied).

Q .3 Councillor Anthony Connaghan

To ask the Manager to arrange for a full inspection of the heating system at (details supplied).

Q .4 Councillor Anthony Connaghan

To ask the Manager,

What is considered good housing policy with regard to housing ratios between public and private in areas? What size area would be used for determining these ratios? And can the Manager provide stats of ratios for the different Local Electoral Area's in Cabra/Finglas and the Ballymun ward please?

Q .5 Councillor Anthony Connaghan

To ask the Manager

if the HSE has been in contact with DCC recently (since An Bord Pleanála rejected the Mellows Rd/Ave site) in relation to a possible site for a Primary Health Care Centre. Can the Manager provide details of any negotiations please?

Q .6 Councillor Anthony Connaghan

To ask the Manager to arrange for an inspection of (details supplied).

Q .7 Councillor Anthony Connaghan

To ask the Manager to arrange for the green verge outside of (details supplied).

Q .8 Councillor Anthony Connaghan

To ask the Manager to arrange for an inspection of (details supplied).

Q .9 Councillor Anthony Connaghan

To ask the Manager to arrange for an inspection and repair of a roof at (details supplied).

Q .10 Councillor Anthony Connaghan

To ask the Manager to arrange for a full inspection of the drains and sewage system at (details supplied).

Q .11 Councillor Cathleen Carney Boud

To ask the Manager to confirm a date for public consultation to commence for (details supplied).

Q .12 Councillor Cathleen Carney Boud

To ask the Manager to consider resurfacing the footpath at (details supplied).

Q .13 Councillor Cathleen Carney Boud

To ask the Manager to provide an update on the three houses in (details supplied).

Q .14 Councillor Cathleen Carney Boud

To ask the Manager to arrange for the trees on the green in (details supplied).

Q .15 Councillor Cathleen Carney Boud

To ask the Manager to install traffic lights at (details supplied).

Q .16 Councillor Cathleen Carney Boud

To ask the Manager to re-examine the problem at the pedestrian lights crossing at (details supplied).

Q .17 Councillor Cathleen Carney Boud

To ask the Manager if there are any plans to refurbish or upgrade the maisonettes in (details supplied).

Q .18 Councillor Cathleen Carney Boud

To ask the Manager to arrange for attic insulation to be installed at (details supplied).

Q .19 Councillor Cathleen Carney Boud

To ask the Manager to arrange for repairs to the road surface outside (details supplied).

Q .20 Councillor Cathleen Carney Boud

To ask the Manager to consider measures to prevent motorised bikes driving up through the walkway at (details supplied).

Q .21 Councillor Cathleen Carney Boud

To ask the Manager to arrange for the instalment of a front grate at (details supplied).

Q .22 Councillor Teresa Keegan

To ask the Manager if he will arrange that (details supplied) be included as a location for the next schedule of tree pruning.

Q .23 Councillor Teresa Keegan

To ask the Manager to the trees at (details supplied) to be pruned back.

Q .24 Councillor Teresa Keegan

To ask the Manager to arrange for tree pruning and leaf sweeping at the following location (details supplied).

Q .25 Councillor Teresa Keegan

To ask the Manager to arrange for tree pruning at the following location (details supplied).

Q .26 Councillor Teresa Keegan

To ask the Manager to arrange for tree pruning at the following location (details supplied).

Q .27 Councillor Teresa Keegan

To ask the Manager to outline the outcome of previous investigations into the persistent flooding at (details supplied).

Q .28 Councillor Teresa Keegan

To ask the Manager if he will arrange for an inspection of the roads in the following locations (details supplied).

Q .29 Councillor Teresa Keegan

To ask the Manager to arrange for street cleaning to take place on roads and footpaths at (details supplied).

Q .30 Councillor Teresa Keegan

To ask the Manager to arrange for a dog litter bin to be installation at (details supplied).

Q .31 Councillor Teresa Keegan

To ask the Manager to arrange for the roads and footpaths in the Shandon area to be inspected as residents complain that they are in a very poor state.

Q .32 Councillor Emma Murphy

To ask the Manager if bollards could be installed at (details supplied).

Q .33 Councillor Emma Murphy

To ask the Manager if there is a possibility of having yellow lines outside homes on (details supplied).

Q .34 Councillor Emma Murphy

To ask the Manager could bollards between (details supplied) be replaced with railings.

Q .35 Councillor Emma Murphy

To ask the Manager could the trees on the green at (details supplied) be replaced.

Q .36 Councillor Emma Murphy

To ask the Manager can the “Children at Play” signs be replaced on (details supplied).

Q .37 Councillor Emma Murphy

To ask the Manager can some of the roots be removed from the tree at (details supplied) and the path replaced.

Q .38 Councillor Emma Murphy

To ask the Manager for the timeframe for the door at (details supplied).

Q .39 Councillor Emma Murphy

To ask the Manager if there is any land in the (details supplied) area that has been identified for housing.

Q .40 Councillor Emma Murphy

To ask the Manager if there is an update on (details supplied) on the transfer list.

Q .41 Councillor Emma Murphy

To ask the Manager is the paths in (details supplied) could be examined as some are in need of repair.

Q .42 Councillor Emma Murphy

To ask the Manager of the possibility of a dog park in (details supplied).

Q .43 Councillor Seamus McGrattan

To ask the Manager to arrange for a new front and back door to be fitted at (details supplied).

Q .44 Councillor Seamus McGrattan

To ask the Manager to arranged for a downstairs toilet and bathroom to be constructed at (details supplied).

Q .45 Councillor Seamus McGrattan

To ask the Manager to allow wheelchair access at (details supplied)

Q .46 Councillor Seamus McGrattan

To ask the Manager to include (details supplied) in the insulation programme.

Q .47 Councillor Seamus McGrattan

To ask the Manager to remove the litter bin outside (details supplied).

Q .48 Councillor Seamus McGrattan

To ask the Manager to install bollards at (details supplied) to prevent cars parking on the path.

Q .49 Councillor Seamus McGrattan

To ask the Manager to provide traffic calming measures at (details supplied).

Q .50 Councillor Seamus McGrattan

To ask the Manager to review recent traffic accidents at (details supplied).

Q .51 Councillor Seamus McGrattan

To ask the Manager to review the sequence of traffic lights at (details supplied).

Q .52 Councillor Seamus McGrattan

To ask the Manager to provide additional tree planting at (details supplied).

Q .53 Councillor Seamus McGrattan

To ask the Manager to repair the speed ramps on (details supplied).

Q .54 Councillor Noeleen Reilly

To ask the Manager to examine the traffic lights at (details supplied).

Q .55 Councillor Noeleen Reilly

To ask the Manager to examine the traffic control at (details supplied) as cars are constantly driving the wrong way.

Q .56 Councillor Noeleen Reilly

To ask the Manager to repair the footpaths at (details supplied).

Q .57 Councillor Noeleen Reilly

To ask the Manager to examine the hill at the rear of (details supplied).

Q .58 Councillor Noeleen Reilly

To ask the Manager to on the status of the 25 apartments in (details supplied).

Q .59 Councillor Noeleen Reilly

To ask the Manager to provide an update on the development at (details supplied).

Q .60 Councillor Noeleen Reilly

To ask the Manager to arrange a cleanup of the hedges at (details supplied).

Q .61 Councillor Noeleen Reilly

To ask the Manager to provide kissing gates on the laneway between (details supplied).

Q .62 Councillor Noeleen Reilly

To ask the Manager for an update on the development lands at (details supplied).

Q .63 Councillor Noeleen Reilly

To ask the Manager for an update on the Pyrite in (details supplied).

Q .64 Councillor Andrew Montague

To ask the Manager to arrange for a tree to be planted outside 10 Glencloy Road in this planting season to replace the tree that was removed.

Q .65 Councillor Andrew Montague

To ask the Manager when will the homes in (details supplied) be insulated?

Q .66 Councillor Paul McAuliffe

To ask the Manager to repair the broken footpath outside (details supplied) be repaired.

Q .67 Councillor Paul McAuliffe

To ask the Manager to repair the pavement outside (details supplied).

**The Chairman and Members of
North West Area Committee.**

Meeting: 15th March 2016

Item No: 3

Cabra Area Office Report

MAIN DEVELOPMENTS

Broome Lodge

Works have now started.

Dalymount Park

Dublin City Council has published its outline plans for the re-development of Dalymount Park which will also include the provision of community facilities.

Liam Whelan Bridge

The new rails on the bridge will be up in the next two weeks. LUAS are still waiting on a reply in relation to the safety aspect of putting cladding on the bridge.

Drainage works are ongoing throughout the cutting. Works are starting on the repair works to the great western railway walls this month. Work has also commenced on the foundations for the depot building at Broombridge. LUAS are waiting on the design for the boundary walls and hope to hold a meeting with residents in the coming weeks.

LUAS officers visited St Finbarrs Boy's National School on Kilkiernan Road on Friday 4th March and had site safety talks with 5th and 6th class students as part of Engineers Ireland Week.

Shandon Boundary wall

Works are under way on the Shandon Boundary Wall Replacement Project. Transport Infrastructure Ireland (TII) intends to replace the existing boundary treatment with a full height cavity block wall; the new wall will replicate the height of the existing boundary.

Waterways Ireland

Following the retirement of the Area Engineer, Sean Barry, Waterways Ireland has advised that due to budgetary constraints he will not be replaced. Because of this and other non-replacements there will be a cutback in the support Waterways Ireland are able to deliver in terms of management, maintenance, event support, community liaison and development of the both Royal and Grand Canals. Until they have some level of replacement they will not be in a position to provide support to the level that was done over the last few years.

COMMUNITY & DEVELOPMENT

The Cabra 1916 Proclamation Commemoration Event.

The event will take place in Cabra Parkside Community & Sports Centre on Tuesday 15th March from 11am to 1pm. Most of the schools are organising their own celebration that morning and inviting parents to attend. Some of the pupils have put together their own proclamations for the present day and will read them as part of the celebrations. Scoil Mhuire and Gael Scoil Bharra have agreed to allow their pupils to participate in the community event from 11- 12 noon. They will then return to take part in their school celebrations.

There will be traditional music, poetry and a reading of the 2016 Proclamation, by Coláiste Mhuire, and a member of the Irish United Nations Veterans Association as Bearla agus as Gaeilge, 1916 Short Drama, Historical Talk, Traditional music of the time.

Canon Burke House

The Cabra 1916 Commemoration Committee has submitted an application for permission to hang a banner depicting the Proclamation and its signatories on the gable wall of Canon Burke Sheltered Housing Complex during the period 13th March 2016 to 30th April 2016 inclusive. The Executive Manager of the Housing & Residential Services Department, having considered this application and all supporting documentation submitted with the proposal, has given approval for the erection of the banner.

1916 Walk & Talks Programme

The next walk in the north west area will take place on Saturday 16th April. Starting at 11a.m, meeting outside St Peters Church and will take in the Phibsborough area. It will be led by Pat Liddy, and will finish outside Mountjoy Prison. The community staff have organised for local community groups to provide complimentary refreshments following the walk.

The Mount Bernard Park project will commence shortly. The community staff and the Play Officer will set up meetings with the community to discuss possibilities for improving the facilities and improving opportunities for creative play in the Park.

Dublin City Good Citizen Awards 2016

These awards recognise special people in their communities who through giving their time and efforts freely make a difference to the quality of living in their neighbours. We are encouraging people to nominate their neighbours, friends, colleagues that they think their good work deserves being acknowledged.

HOUSING UPDATE

January - February 2016

Estate Management

No of Anti social complaints per 1997 act Drug Related	1
No of Anti social complaints per 1997 act <u>Not</u> Drug Related	13
No of other Complaints	16
Total Complaints	30

No of Anti Social Interviews per 1997 act	3
No of Other Interviews	6
Total Interviews	9

No of Requests for mediation	0
No of Complaints referred to central unit for Action	1
No of Section 20 Evictions	0
No of excluding Orders applied for by Tenant	0
No of Excluding orders applied for by DCC	0
No of surrender of Tenancies due to Anti Social Behaviour	0
No of Notice to Quits sent to Central Unit	0
No of Court Orders Granted	0
No of Appeals / Judicial Reviews Challenges	0
No of Warrants executed (Evictions)	0

Housing Allocations

Category	Housing	Transfers
Bands 2 & 3	1	0
Medical	0	0
Welfare	1	0
Homeless	0	0
Travellers	0	0
De-tenanting	0	0
Maintenance Grounds	0	0
Surrendering Larger	0	0
Unable to afford	0	0
Total	2	0

Senior Citizens Allocations

Category	Housing	Transfers
Bands 2 & 3	1	0
Medical	0	0
Welfare	0	0
Homeless	0	0
Travellers	0	0
De-tenanting	0	0
Maintenance Grounds	0	0
Surrendering Larger	0	0
Unable to afford	0	0
Financial Contribution	0	0
Total	1	0

Voids as follows:-

- 4 Houses
- 7 Senior Citizen Units
- Maisonettes
- Apartment

Aidan Maher
Asst Area Manager

To the Chairman and Members of
The North West Area Committee

Meeting: 15th March 2016

Item No: 4

Finglas Area Office Report

HOUSING UPDATE

January – February 2016

Estate Management

No of Anti social complaints per 1997 act Drug Related	3
No of Anti social complaints per 1997 act Not Drug Related	16
No of other Complaints	8
Total Complaints	27

No of Anti Social Interviews per 1997 act	7
No of Other Interviews	5
Total Interviews	12

No of Requests for mediation	0
No of Complaints referred to central unit for Action	1
No of Section 20 Evictions	0
No of excluding Orders applied for by Tenant	0
No of Excluding orders applied for by DCC	0
No of surrender of Tenancies due to Anti Social Behaviour	0
No of Notice to Quits sent to Central Unit	0
No of Court Orders Granted	0
No of Appeals / Judicial Reviews Challenges	0
No of Warrants executed (Evictions)	0

Housing Allocations

Category	Housing	Transfers
Bands 2 & 3	0	0
Medical	0	0
Welfare	0	0
Homeless	0	0
Travellers	0	0
De-tenanting	0	0
Maintenance Grounds	0	0
Surrendering Larger	0	0
Unable to afford	0	0
Total	0	0

Senior Citizens Allocations

Category	Housing	Transfers
Bands 2 & 3	1	3
Medical	0	0
Welfare	0	1
Homeless	3	0
Travellers	0	0
De-tenanting	0	0
Maintenance Grounds	0	0
Surrendering Larger	0	0
Unable to afford	0	0
Financial Contribution	0	0
Total	4	4

Voids Report

There are currently 4 vacant housing units in the Finglas Area

Address	Type of unit	Date of vacancy	Remarks
110 Abbotstown Avenue	House	29/11/2015	
78 Clancy Avenue	House	23/10/2015	On Offer
171 Kippure Park	House	30/09/2015	On offer
37 Plunkett Crescent	House	13/12/2015	Works in progress

There are currently 13 vacant senior citizens units in the Finglas area

Address	Type of Unit	Date of vacancy	Remarks
24 Brookville Court	1 bed	18/01/2016	On offer
22 Clareville Court	bedsit	10/6/2014	Homeless/on offer
46 Clareville Court	2 bed	02/10/2015	On offer
57 Clareville Court	1 bed	22/11/2015	On offer
62 Clareville Court	1 bed	16/11/2015	On offer
61 Clareville Court	1 bed	05/01/16	On offer
16 Kildonan Court	1 bed	07/01/2016	On offer
22 Mellowes Court	1 bed	23/09/2015	Homeless/on offer
39 Mellowes Court	bedsit	12/5/2015	On offer
2 Merville Court	1 bed	14/01/2016	

Rents Update

The Finglas Area Office continues to provide a rent assessment service for tenants living in the Finglas area.

Finglas Rent Assessment Update	
Assessments	140
Permission To Resides	9
Refunds	6

Rapid Build Housing

Delivery of 22 Rapid Build Housing Units (Modular Housing) in Poppintree, Ballymun, Dublin 11.

The delivery of 22 units of Rapid Build Housing in Poppintree is close to full completion. The 22 houses are two-storey units, with three bedrooms and will provide temporary accommodation for families who are experiencing homelessness and who are currently accommodated in commercial hotels by the local authority, on an emergency basis.

Work is ongoing with Dublin City Council's Homeless Central Placement Service (CPS) to assess and appropriately place families in the new units in Poppintree. The CPS are working with families to ensure suitability of placement, considering key elements such as vicinity to local schools and existing family supports.

Initiation of competition for further 131 Rapid Build Housing Units.

Dublin City Council initiated a competition for 131 Rapid Build Housing Units, on Wednesday 2nd March 2016.

In order to facilitate optimum market participation in the competition, Dublin City Council will look for expressions of interest with individual completion dates for specific sites. This will take into consideration the specific number of units to be built on each site.

There are four sites selected and located in the Dublin City Council administrative area, they include;

1. **Drimnagh** – site will commence work in the beginning of April 2016
2. **Belcamp, Malahide Road** – site will commence work in the beginning of July 2016
3. **Ballyfermot** – site will commence work in the beginning of April 2016
4. **Finglas** – site will commence work in the beginning of April 2016

The intended timelines of this competition are working towards the completion of all units by Autumn 2016.

The four Dublin local authorities are working towards the further delivery of a further 350 units approximately across the Dublin region to address the temporary accommodation needs of families in commercial hotels. Further detail in relation to this will be provided.

Housing Allocation Directive for Homeless Priority Households.

The Dublin local authorities continue to implement the ministerial directive which requires that 50% of allocations are utilised for homeless households and other vulnerable groups.

Tusla

A Homelessness Liaison Officer has recently been appointed with Tusla, and has the remit of co-ordinating child and family resources to dedicated supported family accommodation settings, particularly in relation to child protection. The Homelessness Liaison Officer links with the Dublin Region Homeless Executive around access for children and families to Family Resource Centres. It also provides guidance for Home School Community Liaison and School Completion Staff on helping children and families experiencing homelessness to maintain regular school attendance. School Completion Programmes have been asked to prioritise homeless children for services such as breakfast and homework clubs.

An Riasc

Tuath Housing has carried out interviews with prospective tenants for the first fourteen homes at An Riasc. Letters of offer will be sent to the successful applicants within the next two weeks. It is proposed to have the first six tenants in their homes by the second week in April and the remaining eight to follow two weeks later.

The second phase is due to be completed May/June.

Finglas South Safety Forum

The Finglas South Safety Forum meeting took place on 22nd February in St. Helena's Family Resource Centre. Local issues were discussed including the green area at Scribblestown and a request for a pedestrian crossing at the entrance to Tolka Valley Park.

Kippure Park

There are ongoing complaints about a gang of youths gathering in the Kippure Park area causing a nuisance to residents. A number of tenants were interviewed in December and were asked to make sure their children were not part of this gang. In recent reports some of the same names were given as still causing trouble in this area and also some new names were given. The Area Office is now in the process of writing to the tenants whose children were named as part of this gang and will interview them. A decision will then be made as to what action, if any, will be taken in each case.

Staff Changes

Derek Healy has taken up the position of Area Housing Manager for the Finglas area replacing Brian Byrne. He can be contacted on 222 5410.

COMMUNITY & SOCIAL DEVELOPMENT

Summer Projects

Dublin City Council Community and Social Development team in conjunction with Crosscare have held a number of meetings with summer projects committees with a view to organising Finglas Summer Project 2016.

These meetings will continue over the coming months to support the development of appropriate Summer Project Programmes for the Finglas area.

Positive Ageing Events 2016

The Finglas Positive Ageing Committee has met to discuss a programme of events for this year's positive ageing weeks. Activities will take place over two weeks commencing Monday 26th September 2016.

Events will include the annual senior ball, over 55's table quiz, over 55's pool tournament, afternoon tea dance and a series of talks.

Preparation meetings will continue over the coming months.

Pavee Point/Triple P

The Community and Social Development Team supported Pavee Point to deliver the Triple P Programme. Triple P gives parents simple tips to help manage the big and small problems of family life. Problems like toddler tantrums and teenage rebellion.

The programme commenced on Wednesday 9th March 2016 at 10.00a.m and will continue to run monthly until Wednesday 1st June 2016 in the Finglas West Community Hub.

International Women's Day

Holistic Day

The Community and Social Development Section supported the Fingal Centre Holistic day which took place on Tuesday 8th March at the Fingal Centre, Cardiffsbridge Road from 11a.m.-1.00p.m. The Marie Keating Foundation was present and provided information on Breast Cancer Awareness. Mindfulness and pampering also took place as part of the event.

Cumann na mBan Lecture

As part of the 1916 centenary events and to celebrate International Women's Day the Community & Social Development Section held a lecture on Cumann Na mBan and the role of women in the rising. This event took place on Thursday 10th March in the Finglas Civic Centre with over forty people in attendance.



Environmental/Resident Engagement

In conjunction with the Community and Social Development Section, Global Action Plan will be facilitating a planting workshop/information session for resident committees within the Finglas Area. The main aim of this workshop is to encourage residents groups to look towards developing their planting ideas and encourage the groups to think about sustainable planting projects. All residents groups in Finglas will be sent an invitation to attend the project. This event will take place on Wednesday 13th April 2016 at 7.00p.m in the Finglas Civic Offices. For further information please contact Niamh Reilly on (01) 222 5405.

Age Friendly Cities

A meeting of North West Area City Alliance took place on Tuesday 1st March 2016. Issues discussed included the spending of the Social Inclusion Budget to highlight various needs, concerns and opportunities for the older people in the North West Area.

The North West Area Older Person Council is due to meet again on Wednesday 6th April 2016, in the Finglas Civic Offices, Mellows Road. The group will look to extrapolate and prioritise a number of items from their action plan for 2016.

Finglas Festival 2016

The Finglas Festival will take place in early July. The Festival will be on a smaller scale than last year. Dublin City Council will support the Festival by providing resources to the Festival committee and by running a number of cultural events which will be included in the Festival programme.

Finglas Men's Shed

An inaugural meeting of Finglas Men's Sheds will be held in the Fingal Centre on Tuesday 15th March 2016 at 6.00p.m. This meeting will be facilitated by Men's Sheds Ireland and Dublin City Council, Community and Social Development team.

Aidan Maher

Assistant Area Manager

**To: The Chairman and Members of
North West Area Committee**

Meeting: 15th March 2016

Item No. 6

**With reference to the proposed grant of a further licence for the rear of the premises 5
Cardiffsbridge Road, Finglas, Dublin 11.**

The City Council is the owner of the property No. 5 Cardiffsbridge Road, Finglas, Dublin 11. By way of Agreement dated 25th November 2010 the rear of the premises which is more particularly delineated on Map Index No. PD2007-0236 was licensed by Dublin City Council to Finglas Childcare Limited for a period of 5 years from 8th September 2010 and subject to an abated licence fee of €250 per month.

This licence expired on 7th September 2015 and Finglas Childcare Limited has applied for a further licence.

Accordingly it is proposed to grant a further licence of the rear of No. 5 Cardiffsbridge Road, Finglas, Dublin 11 which said property is more particularly delineated on Map Index No. PD2007-0236 to Finglas Childcare Limited subject to the following terms and conditions:

1. The licence fee shall be the sum of €5,500 (five thousand five hundred euro) per annum.
2. So long as the premises shall be used solely as a childcare facility this fee shall be abated to €3,000 (three thousand euro) per annum payable quarterly in advance.
3. The proposed licence shall be for five years commencing on 8th September 2015.
4. The licence can be terminated by either party on giving the other one months notice in writing.
5. The licensee shall be responsible for all rates, taxes and other outgoings.
6. The licensee shall keep its part of the premises in good condition and repair during the term of the licence.
7. The licensee shall indemnify the City Council against any and all claims for compensation, which may arise from their use of the property.

8. On termination of the licence, the licensee shall be responsible for the removal of all their materials from the premises.
9. Nothing herein contained is intended to create or shall be taken as creating a relationship of Landlord and Tenant between the licensor and the licensee. For the avoidance of doubt, the licensee will sign a Deed of Renunciation.
10. The licence will be subject to any terms and conditions deemed appropriate by the Council's Law Agent in agreements of this type.

Paul Clegg
Executive Manager

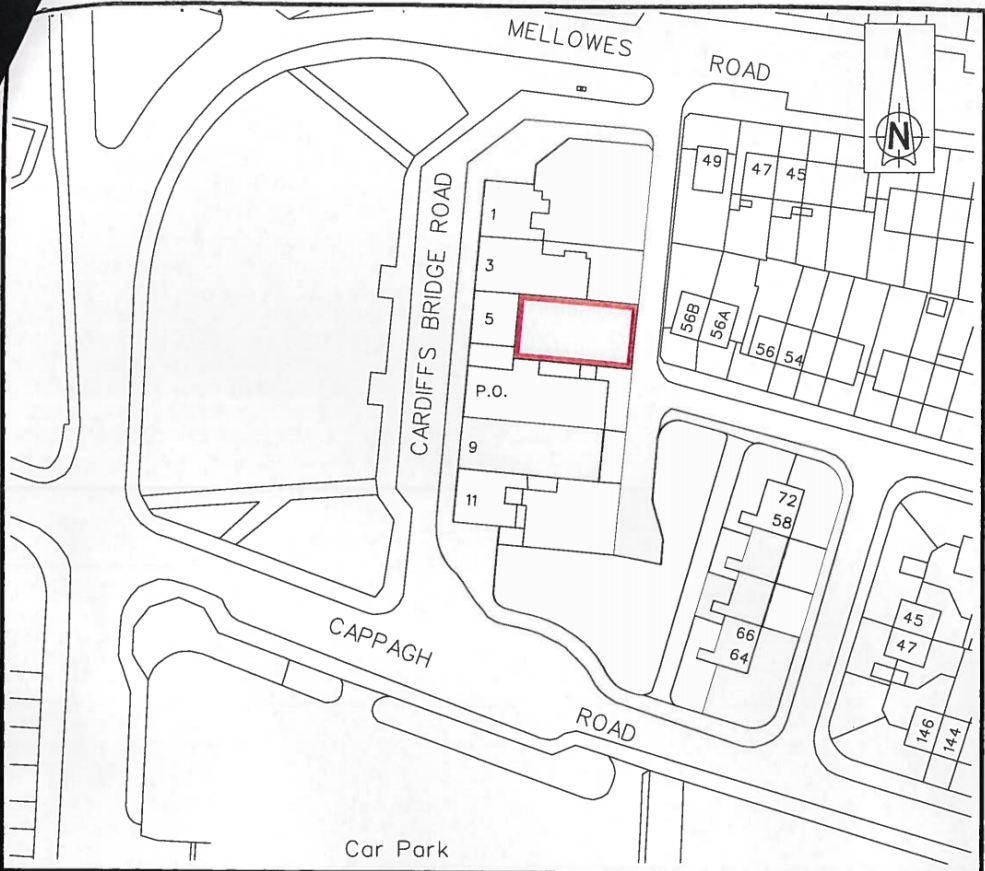

**CARDIFFSBRIDGE ROAD- PREMISES No. 5 (REAR OF)
 DUBLIN CITY COUNCIL TO FINGLAS CHILDCARE LTD
 GRANT OF 5 YEAR LICENCE**

Area: 290 sq m



DUBLIN CITY COUNCIL
Comhairle Cathrach Bhaile Atha Cliath
DEVELOPMENT DEPARTMENT
An Roinn Forbartha

M. PHILLIPS CITY ENGINEER	<i>Date</i>	<i>By</i>	<i>Revisions :</i>	SCALE	INDEX No.
	22-07-2010	TC	Term of Lease changed		
	22-07-2010	TC	Survey and Mapping Ref 2010-0448	1:1000	PD2007-0236

**To the Chairman and Members of
the North West Area Committee**

Meeting: 15th March 2016

Item No: 8

Re: Allocation of 2016 local service funding to the North West Area

Finglas/Cabra LEA

Location	Project/Works	Estimated Cost
Ashtown roundabout, Cabra Cross and Navan Road junction	Repairs and junction enhancements	€10,000
Berryfield Drive laneway	Facilitate extinguishment	€7,000
Blackhorse Avenue	Contribution to Poor Man's Well Restoration Project Roads	€5,000
Cabra (Convent View; Broombridge and Canon Burke)	CCTV in senior citizens complexes	€30,000
Cabra / Finglas laneways	Public domain enhancements	€10,000
Cardiffsbridge Road	Appoint consultant to develop a landscaping / environmental Improvement plan	€30,000
Clean Up Equipment	For residential / clean up groups (incl. Royal Canal Volunteer Group)	€5,000
Dunsink Avenue and Dunsink Road	Widening of vehicular access to houses	€110,000
Fergal's Lane	Environmental enhancement	€10,000
Faussagh Avenue	Commence Enhancement Project: gates to laneways with extinguished RoW; upgrade CCTV; investigate development of a civic space in front of Broome Lodge – 50% co funded by Parks Phase 1 in 2016: Install gates; upgrade CCTV. Phase 2 in 2016: Commence landscaping / environmental Improvement plan	€25,000 €40,000
Finglas Civic Centre	Install stop pads/ ramps to prevent cars hitting the bollards while parking.	€5,000
Finglas CCTV	Contribution to additional CCTV - co funded by An Garda Síochána and local businesses	€20,000
Finglas Leisure Complex	Upgrade 2 pitches for multi-purpose use - co funded by CCEES	€5,000
Gaelscoil Úí Earcáin	Installation of bollards	€5,000
Homestead Court Mellowes Park	Planting at entrance Repair paths	€2,000 €2,000
Merville Court	Fit railing at top of wall	€6,000

Phibsborough Centre	Precinct upgrade	€5,000
Pinehurst Estate	Upgrade of the surface of the wall facing the Maple Shopping Centre	€5,000
Ratoath Estate	Improvement works to entrance	€12,000
St Attracta Road	Cluster of trees at junction if agreed with residents	€3,000
Finglas Village	1916 project for a green space to be agreed with Parks	€5,000
Valeview Gardens	Fit railing at top of wall along row of houses	€10,000
FINGLAS / CABRA LEA SUB-TOTAL		€367,000

Ballymun LEA

Location	Project/Works	Estimated Cost
Ballymun Courts	Environmental Schemes	€30,000
Ballymun Main Street	Car Park upgrade	€20,000
Cearnóg an tSeachtar Laoch	Development (year 1)	€100,000
Coultry Park	Removal of canopy structure due to anti-social activity	€15,000
Drumcondra	Environmental Scheme	€10,000
Griffith Park	New gate Railings	€10,000 €10,000
Johnstown Park	Improve accessibility	€20,000
Magenta Hall	Conifer removal, hedge planting and shrub planting	€10,000
Mobhi Road-Botanic Ave shops	Public realm enhancements	€50,000
Poppintree Park	Provide gates at Northway, Holywell, Belcare, wheelchair access to pond Area and boundary improvement, fountain for pond water feature, drainage of mounded area boundary, Memory Grove Planting Scheme	€25,000
Rediscovery Centre	Paving	€30,000
Silloge Gardens	Resurfacing	€30,000
St. Alphonsus' Road Upper / Iona	Environmental Scheme	€10,000
Whitehall	Environmental Scheme Study	€25,000
BALLYMUN LEA SUB-TOTAL		€395,000

Overall NW Area Actions

Location	Project/Works	Estimated Cost
Specific age friendly project	(to be scoped out)	€5,000
Area Offices	1916 Commemoration events hosted by the Area Offices	€10,000
Area Offices	Miscellaneous Funding for community engagement during the year – projects supported/run by voluntary/sporting groups and approved by Asst Area Managers	€20,000

Neighbourhood parks	Pilot to encourage responsible dog ownership and interaction with DogsTrust Enhance distance and route markings and signage	€5,000 €5,000
Housing Estates	Essential improvements	€10,000
Hanging Baskets	Replacement programme	€20,000
Griffith Hall and Mellow Springs	Repairs to community buildings	€30,000
Miscellaneous Public Domain enhancements	Miscellaneous environmental enhancements during the year approved by Asst Area Managers	€20,000
Traffic Control Boxes	Paint	€5,000
Support cycling	Provide bike racks	€5,000
	OVERALL NWA SUB-TOTAL	€135,000

Recurring annual Expenditure:

Christmas , Summer Halloween	Events – additional funding	€20,000
	RECURRING SUB-TOTAL	€20,000

*

SUMMARY

Finglas / Cabra LEA	€367,000
Ballymun LEA	€395,000
Overall NWA	€135,000
Recurring Expenditure	<u>€ 20,000</u>
OVERALL TOTAL	€17,000

Dave Dinnigan
Area Manager

**The Chairman and Members of
North West Area Committee.**

Meeting: 15th March 2016

Item No: 9

2016 NORTH WEST AREA WORKS PROGRAMME

ROADS MAINTENANCE			
Location	Proposed Works	Amount €	Comments
Finglas Road	Improvements	190,000	Regional Carriageway
Cabra Road	Improvements	140,000	Regional Carriageway
Subtotal (Regional Carriageway Improvements)		€330,000	
Ratoath Road	Improvements	110,000	Local Carriageway
Shanard Road	Improvements	90,000	Local Carriageway
Walsh Road (road closure)	Improvements	70,000	Local Carriageway
Sillogue Avenue	Improvements	75,000	Local Carriageway
Subtotal (Local Carriageway Improvements)		€345,000	
Location	Proposed Works	Amount €	Comments
Dunsink Avenue	Improvements	76,000	Local Footpath
Plunkett Avenue	Improvements	28,000	Local Footpath
Sillogue Road	Improvements	50,300	Local Footpath
Glasanaon Road	Improvements	72,000	Local Footpath
Abbotstown Road	Improvements	70,000	Local Footpath
Casement Drive	Improvements	25,000	Local Footpath
Mobhi Road	Improvements	50,000	Local Footpath

Subtotal (Footway)	€371,300	
Proposed Works – Contract Other	Amount €	Comments
Traffic Ramps Upgrade	150,000	
Subtotal	€150,000	
Miscellaneous Direct Labour	365,000	Local
Street Name Plates	5,000	Local
Winter Maintenance	15,000	Local
Incident Response Unit	5,000	Local
Various Location Gullies	10,000	Local
Subtotal (Other Works – Local)	€400,000	
Miscellaneous Direct Labour	365,000	Regional
Street Name Plates	5,000	Regional
Winter Maintenance	15,000	Regional
Incident Response Unit	5,000	Regional
Various Location Gullies	10,000	Regional
Subtotal (Other Works – Regional)	€400,000	
Total Road Maintenance Expenditure	€1,996,300	
TRAFFIC MANAGEMENT		
Location	Proposed Works	Amount €
Balbutcher Lane/Beclare Park	Junction Plateau & Buildout	45,000
Glencorp Road	1 No X Ramp	5,000
Abbotstown Avenue/Abbotstown Road	Standard mini Roundabout	6,000

Marewood Crescent	2 No X Engineered Traffic Calming	10,000
Dunmanus Road/Faussagh Avenue	Engineered Traffic Calming	16,000
Carrig Road	2 No X Ramps	10,000
Coultry Drive	1 No X Ramp	5,000
Balbutcher Lane/Cartron Terrace/Cartron Drive	Engineered Traffic Calming	10,000
Stormanstown Road	1 No X Ramp	5,000
Tolka Valley near St. Helena's Road	1 No X Ramp/Crossing	30,000
Total Traffic Expenditure		€142,000

PARKS IMPROVEMENT PROGRAMME

Location	Proposed Works	Amount €
Magenta Hall OS	Conifer Removal, Hedge Planting and shrub planting	10,000
Coultry Park	Removal of canopy structure due to anti-social activity	10,000
Albert College Park	Paths renewal (300m approx)	20,000
Balcurris Park	Remove damaged Sleepers and replacement with gravel	7,000
Poppintree Park	Provide gates at Northway, Holywell, Belclare, Wheelchair access to pond area and boundary Improvement Fountain for pond water feature Drainage of mounded area boundary Memory Grove Planting scheme	25,000
Silloge Park	Shed Door Repair; Tee improvement; drainage of greens	20,000
Tolka Valley Pitch/Putt	Drainage on Par 3 course,	4,000
Tolka Valley Park	3 swing gates	10,000

	Finglaswood Bridge foundation reinforcement	40,000
Mellowes Park	Path Improvements	2,000
Forrestwood/Sallowood	Shrub removal and grassing	4,000
Meakstown Allotments	Storage Improvements	4,000
Griffith Park	Phased upgrading of boundary railings –on-going	20,000
Mount Bernard Park	Provision of additional play items	60,000
Total Parks Expenditure		€236,000

Dave Dinnigan
Executive Manager

**To the Chairman and Members of
the North West Area Committee**

Meeting: 15th March 2016

Item No: 11

Metro Dublin Metro Dublin Development

**Presentation to the
Dublin City Council
North West Area Committee
15/3/2016**

A. PROGRESS METRO DUBLIN DEVELOPMENT

Dublin City Council Planning SPC	Motion: that they <i>"would like to see the City Council explore the potential for cooperation between Metro Dublin & Dublin City Council to secure the potential benefits of Metro Dublin for the City"</i> , Nov. 2015
An Bord Pleanála	Commenced Statutory Pre-Application Consultations for a Railway Order, Oct. 2015.
Dublin City Council Transport and Traffic SPC	Motion: <i>"that the Minister undertakes substantive engagement"</i> with Metro Dublin and <i>"engage with it properly"</i> , Feb. 2014.
Fingal County Council Director of Operations	stated that they are <i>"happy to assist Dublin City Council in their evaluation of Metro Dublin"</i> , Jan. 2014.
Oireachtas Joint Committee on Transport	stated that our <i>"knowledge and many skills that are appropriate for the building of a Metro"</i> and that our <i>"knowledge could be harnessed for the development of the Dublin Metro system"</i> , O'Reilly Report 2005.

B. SOME QUESTIONS AND ANSWERS

1. Does Metro Dublin conflict with other transport proposals?

Metro Dublin boosts the utility/business cases for DART Underground and for Bus Rapid Transit schemes.

For instance, should DART Underground precede then platform to platform access will be available to/from the DART Heuston Station to Dublin City University, Dublin Institute of Technology, Dublin Airport and St James's Hospital, and to/from the DART Christchurch Station to O'Connell Street, Croke Park stadium, Whitehall, Beaumont Hospital and to Terenure and Rathfarnham.

Metro Dublin upgrades the TII (RPA) Metro North Luas to full metro, thus, boosting operation quality and reducing operation costs by at least 15% and power consumption by 10%.

2. Why are the Adamstown and the Blanchardstown lines included?

To underpin high usage of public transport Metro Dublin needs the availability of a 'critical-mass of public transport infrastructure'. This will facilitate Irish Rail to run high frequency/quality services on these lines and on the rest of the Development (all lines need to be used to their maximum).

3. Are their conflicts with the existing intercity rail services?

No. Metro Dublin track layout is such that its services are run on grade separated (bridged-over) tracks from the Irish Rail intercity trains – conflicts are thus avoided.

4. Is purchase of state land required for stations?

All land portfolios associated with the Development will be in the ownership/control of the State. Land 'way-leaves' will be limited to construction, maintenance and access to stations.

5. What is the Metro Dublin Development?

It is a world-class integrated public transport development that serves both Dublin and the country. It can be seen to hit many of the buttons for proper planning and sustainable development in Dublin. It has 59 stations. Works involve the upgrade of existing lines 28 km, new lines 17 km on surface and 45 km in tunnel.

6. How does it serve Dublin?

It efficiently extends and integrates the existing public transport services, see maps overleaf. It joins up the city and national railways.

Compared to the shelved metro plans, vast additional areas are served, patronage is significantly increased. It connects Dublin city centre with its suburbs of *Adamstown, Ashbourne, Ballymun, Blanchardstown, Castleknock, Clondalkin, Croke Park, Dublin Airport, Finglas, Dublin City University, Dublin Institute of Technology, Greencastle, Harold's Cross, Howth Junction/Donaghmede, Harolds Cross, Malahide, Rathfarnham, Swords, Terenure and Whitehall* and major traffic generators, such as the Dublin Institute of Technology, Dublin City University, Dublin Airport, Beaumont Hospital and the St James's/New National Children's Hospitals.

7. What are the benefits of the Metro Dublin Development?

It delivers on the long accepted social, economic and environmental case for a metro in Dublin. Major benefits include:

- Quality of life improvements and the ability to enhance Dublin as a residential and investment location;
- An affordable world-class public transport system that integrates and enhances existing public transport services.

8. Does Metro Dublin expect the involvement of Dublin Local Authorities?

Yes (just as cities authorities world-wide are part and parcel of their public transport delivery) and is now exploring the scope for partnership collaboration and/or co-operation to secure potential benefits.

9. How can the Local Authorities get involved?

They can be involved through the State Authorities (Public Private Partnership Arrangements) Act 2002. The Act provides certainty as to the powers of Irish State authorities to enter into Partnerships and gives local authorities the power to enter into joint ventures. It strikes a balance between the needs and interests of the public sector, and ultimately those of the Exchequer, and the private sector. (Source: the Department of Public Expenditure and Reform.)

10. What are the advantages of Local Authorities involvement?

An extensive and affordable metro can be in operation in 2021 (as against a single metro line in 2027), which can be seen to have a profoundly positive impact on the proper planning and sustainable development of Dublin and a positive impact on the country.

11. Has the Metro Dublin Development the team and finance lined up to deliver?

Metro Dublin’s capability and credibility to complete the proposed development is fully supported by its core development team, financiers and track record.

Its core development team met with the An Bord Pleanála Pre-Application Consultations Board last October. Its core development team are world leaders in terms of metro fast delivery, low outcome/final all-in cost and quality. They have delivered extensive high quality metro projects similar to the Metro Dublin Development many times. They participated as the management team of the Madrid Regional Government in all phases of implementation of its new metro infrastructure, since its initial conception to commissioning to commercial operation.

Its core team will take the Metro Dublin Development through its delivery - from the start of its development and due process to procurement to contract to commissioning. Their ability, experience and delivery record fits the Metro Dublin development needs - to do everything through EU procurement methods, to procure fast, appoint contractors, and supervise delivery and commissioning the full development – (see Slide at meeting).

The Metro Dublin financial team have the capability to provide the finance to fund the development, and the Metro Dublin track record included the bona fide development proposal which it developed with a Japanese Consortium and presented to the Taoiseach and his Cabinet Committee on Infrastructure and Public Private Partnerships. The Japanese Consortium built the Dublin Port Tunnel.

12. What is the context of the Development?

The context of the Development is that it is introduced:

- Under the Transport (Railway Infrastructure) Act 2001 and the Planning and Development (Strategic Infrastructure) Act 2006 – they facilitate ‘any person’ to make an application for a Railway Order;
- Under Government policy and objectives to deliver sustainable infrastructure, as promoted by the Government and the EU. They set out to attract private proposals that address the deficit of investment for sustainable urban public transport infrastructure;
- To ameliorate the situation where major infrastructure projects were developed and then shelved. This situation is widely recognised as one that provides justification for entering into direct discussions with State Authorities;
- In an open transparent and value for money competitive manner that is open to scrutiny, debate and criticism. For instance, EU tenders will be used for all contracts; and
- To exploit unique innovative methods that improve benefits, reduce costs – all of which are in the public interest.

13. What would be the burdens on public bodies?

At this stage it suffices to say here that the Metro Dublin sees that the Development and operation will at all times accrue net income for the Exchequer and the Local Authorities.



Finally, I would like to thank the Committee for extending an invitation to present the Metro Dublin Development today and hopefully we can go on with you to explore the scope for partnership collaboration and co-operation to secure potential benefits for Dublin.

DUBLIN – NEW URBAN RAILWAY NETWORK

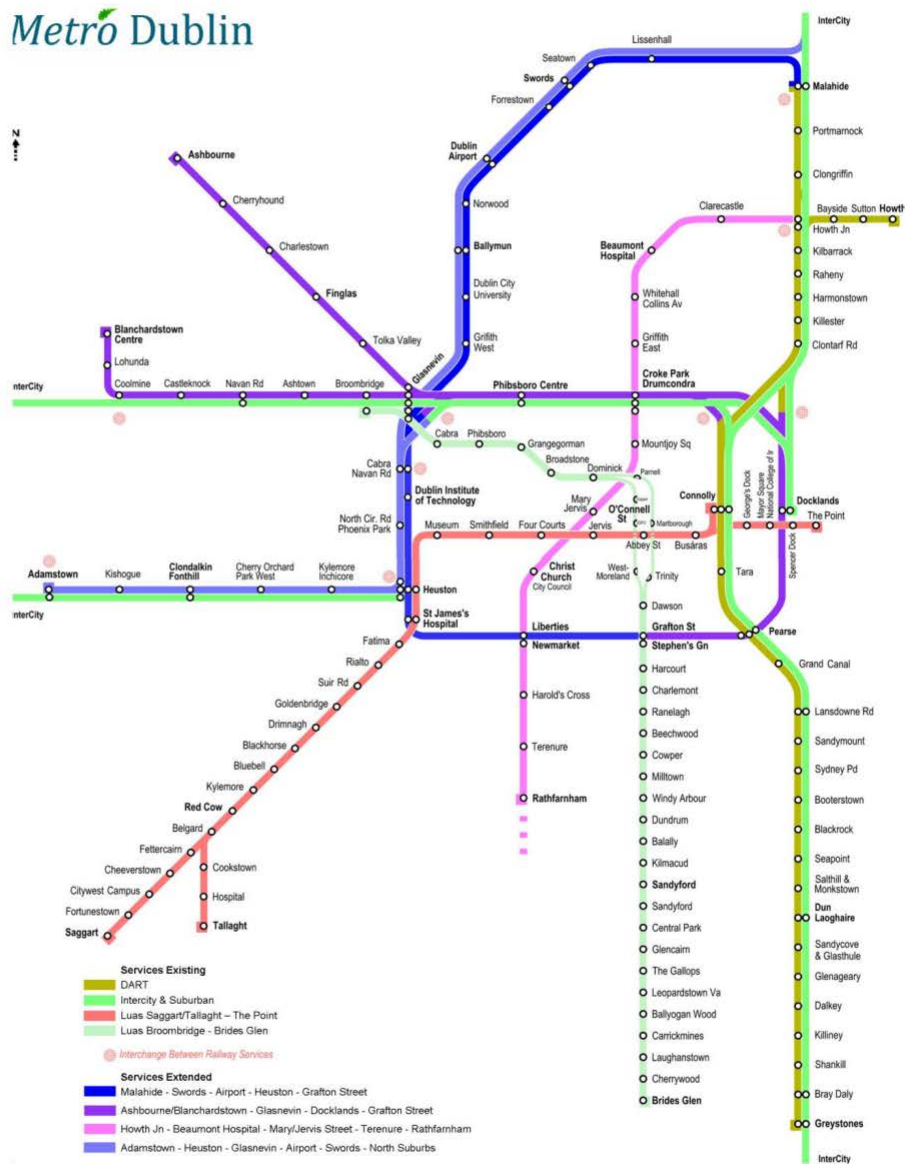

Note: Map is Indicative - station stops, etc, subject to ongoing revision

Cormac Rabbitt
CEO Metro Dublin

@MetroForDublin
info@MetroDublin.ie

DUBLIN – NEW URBAN RAILWAY NETWORK

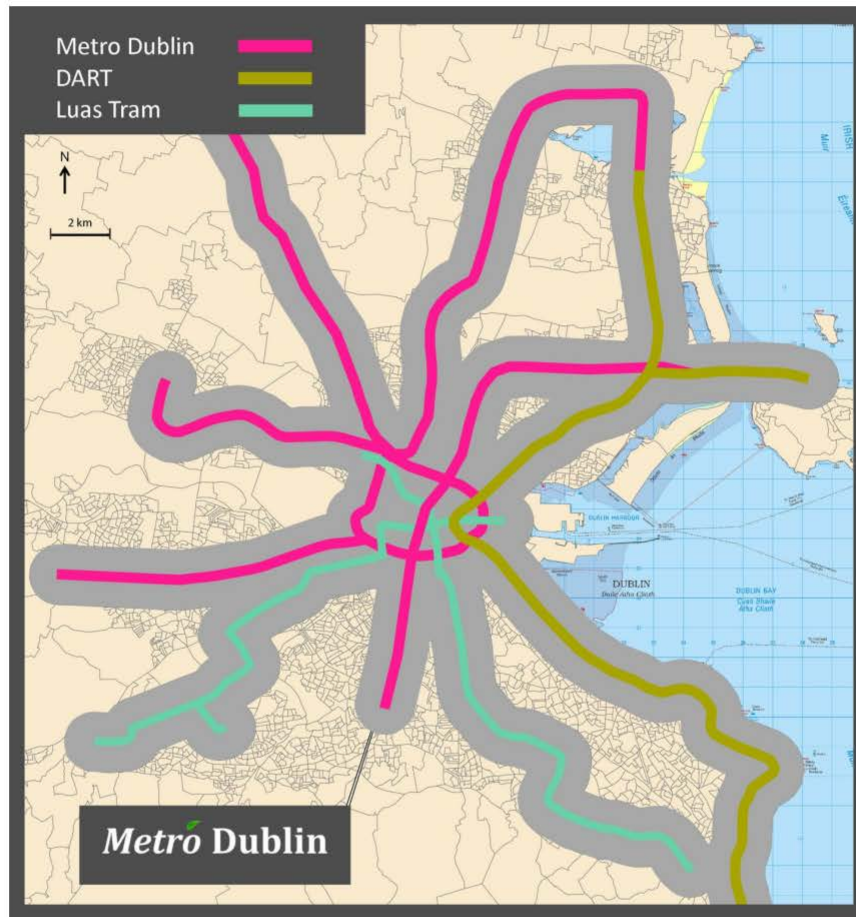

Cormac Rabbitt
CEO Metro Dublin

@MetroForDublin
info@MetroDublin.ie

METRO



Creating and delivering a metro for Dublin's future

Metro Dublin is a new mass rapid transit network to serve Ireland's capital city and the country. **Cormac Rabbitt**, Managing Director of the scheme, explains for *Eurotransport* why and how Metro Dublin propose to create and deliver a cost effective transit metro network for Dublin's future

Metro Dublin will extend to 92km with 57 stations when eight shared stops are included. Works will involve the upgrade of 28km of existing lines, 17km of new surface lines and 45km of tunnels. It will run on grade separated tracks from the Irish Rail intercity trains. The network could best be seen as an extended Dublin urban railway network, as shown in **Figure 1** on page 59.

For development purposes, Metro Dublin is divided into six contract sections as shown in **Figure 2** on page 60, with the existing DART line marked '7'. The sections are:

1. Glasnevin/Heuston/Docklands – 7.2km
2. Malahide/Swords/Glasnevin – 21.2km

3. Adamstown/Heuston/Phibsboro – 15.8km
4. Blanchardstown/Glasnevin/Docklands – 13.5km
5. Ashbourne/Finglas/Glasnevin – 17.2km
6. Howth Jn/O'Connell St/Rathfarnham – 17.1km

What's different about Metro Dublin is its gestation in a private initiative with a relatively low all-in capital cost when compared to previous proposals.

First, a rhetorical question – what could a new low all-in capital cost metro mean for you? If you are a supplier of metro systems I think that it could mean a lot. For example, if two metro lines can be built for the

price of one (with better technology and management methods) than the ongoing supplier market will grow significantly for you.

Back in 1998, Metro Dublin, along with others, successfully lobbied the Government to undertake an independent examination between underground metro and over-ground tram options. Government consultants recommended the tram option. The Government rejected their recommendation and favoured a metro, because they believed that a planned Sandyford Line extension southwards to Lahaunstown (which is now a large urban development) and northwards to Dublin Airport needed a full metro.

This explains why Dublin's Sandyford and Tallaght tram lines did not join – a decision based on sound principles of planning. A similar situation arose in Vienna in the early 1970s when they started to build a super-tram system, parts of which were underground. Halfway through the project they abandoned it in favour of a metro system. The reasons given for this were: a) to preserve Vienna's dignity; b) to retain the atmosphere of the old city; and c) the realisation that the super-tram would be inadequate to deal with traffic problems.

Two years later, from a presentation that we made with a Japanese consortium to the Irish Cabinet Committee for Infrastructure and Public

Private Partnerships, the Government taking account of our estimated costs decided to proceed to upgrade the Sandyford Green Line to a full metro and to continue it northward from Ranelagh under the city centre to Dublin Airport and Swords (Plan).

In 2002, the Irish Railway Procurement Agency (RPA) came up with a modification of the Plan, calling it Metro North, to build a line just from Stephen's Green (1km north of Ranelagh) to the Airport and Swords. Their plan was for a 14km tram metro line with 6km of it underground and with 14 stations, of which seven were underground, at an estimated all-in cost with funding requirements over 15 years of €4.88 billion with a capital estimate of €3.89 billion in the then current money value.

Looking back on this now I just couldn't fathom it as Madrid had then recently completed an all underground 11.1km, 13 stations underground extension to its Line 7 – see Figure 3 on page 61, at a cost of €424 million. The cost included all design, procurement, construction and management related costs. The line was built in four contract sections, which enabled the works to be completed, from signing of contract to operation, in 28 months. My conclusion was that the RPA's estimate for their Metro North was questionably significantly larger than the outcome cost of Line 7.

To understand why, I travelled to Madrid and met Professor Manuel Maynar Melis, Director General of Transportation in Madrid. He showed me his new MetroSur Line 12, which has 40.5km underground with 28 stations which he had almost completed. Its all-in final cost excluding financing interest and fees was €1.86 billion and took 35 months to complete.

Again, I made a comparison and my calculations were that the RPA Metro North Capital estimate was questionably more than what Madrid incurred. The reason why the cost of Line 12 was so much lower than Dublin (and other metro systems), I concluded, was the skills that the management team had to manage the system delivery in a short timeframe, and definitely nothing to do with ground conditions as Dublin's substrata for metro construction is better than Madrid's.

I think that an important point to note here is that the Madrid Metro is built to one of the highest standards in the world. For example, a good comparative measure of quality is that, in 2010, the combined number of escalators and lifts in the New York, London, Moscow and Tokyo metro systems were respectively 88% and 40% that of Madrid.

My next step was to request the Irish Parliament Joint Committee on Transport to examine the situation. They brought over a Metro de Madrid delegation and then commissioned a Consultant's Report (O'Reilly) resulting in the estimate cost of Dublin's Metro North being reduced by some 30% and a recommendation that my (trading as Metro Dublin) 'undoubted knowledge and many skills that are appropriate for the building

Works will involve the upgrade of 28km of existing lines, 17km of new surface lines and 45km of tunnels

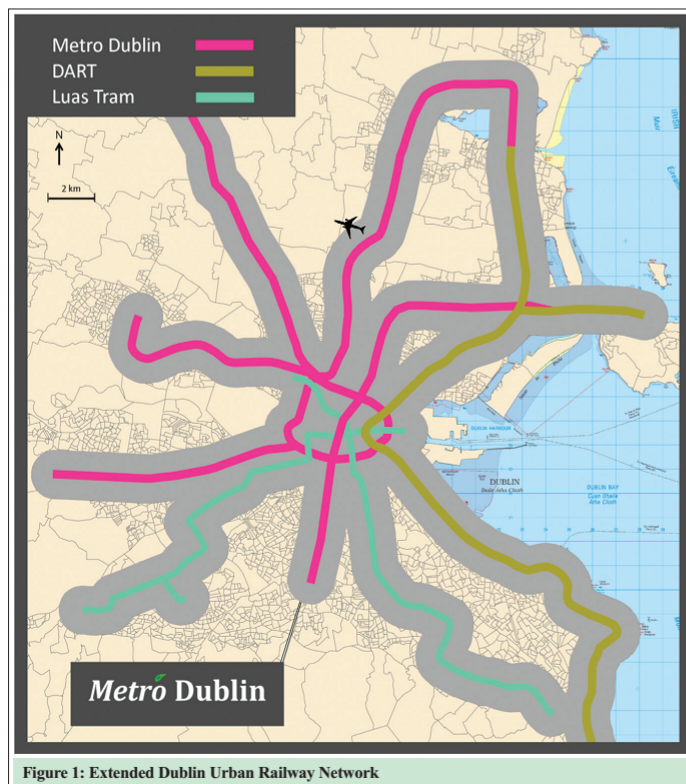

Figure 1: Extended Dublin Urban Railway Network

METRO

of a Metro...could be harnessed for the development of the Dublin Metro system'.

Railway Orders (final planning permissions) were granted for the RPA's Metro North, in 2010, to build a 16.5km metro (with 10km of it in tunnel) and 14 stations with a capital estimate of €2.5 billion, and to DART Underground for a 7.6km line with six stations with a capital estimated of €3.5 billion – a figure that included additional works on other lines to make it work. The estimated timescale to construct both was six years. In September 2015, both of these schemes were sent back to the drawing boards with the expectation now that only Metro North will open in 2027.

In the foregoing environment (time-line, estimated cost and that only one part of the city would have a new metro line), Metro Dublin recently stepped back into the breach and met with the Irish Planning Board as a prospective applicant for a Railway Order and

In Ireland, development proposals are encouraged and facilitated within the Transport (Railway Infrastructure) Act, 2001

the Dublin City Council Planning Strategic Planning Committee passed a motion to "...explore the potential for cooperation between Metro Dublin and Dublin City Council to secure the potential benefits of Metro Dublin for the City...".

In Ireland, development proposals are encouraged and facilitated within the Transport (Railway Infrastructure) Act, 2001. The act provides that 'any person' may apply for a railway order. A late Government Minister invited the private sector "to take part in the upgrading of the transport system" and "play a part in developing a more modern transportation system for the city and country."

It is widely accepted in Ireland and in other countries that there is a strong case for a Government to consider a private initiative in circumstance such as:

- When major infrastructure projects are developed and then shelved (as happened Dublin's Metro North and DART Underground Developments)
- Under probity of open market requirements as promoted by the Government and the EU and in particular to address the deficit of investment in environmental transport infrastructure
- Where innovative proven ideas with unique elements and intellectual property rights that are in the public interest can be

introduced in an open, transparent and value for money competitive manner

- Where it serves a 'public interest' and Government policy, objectives and strategy to deliver sustainable infrastructure
- Where developments include unique elements that provide justification for entering into direct discussions with the State Authorities and Agencies
- Can be delivered through a transparent and competitive process.

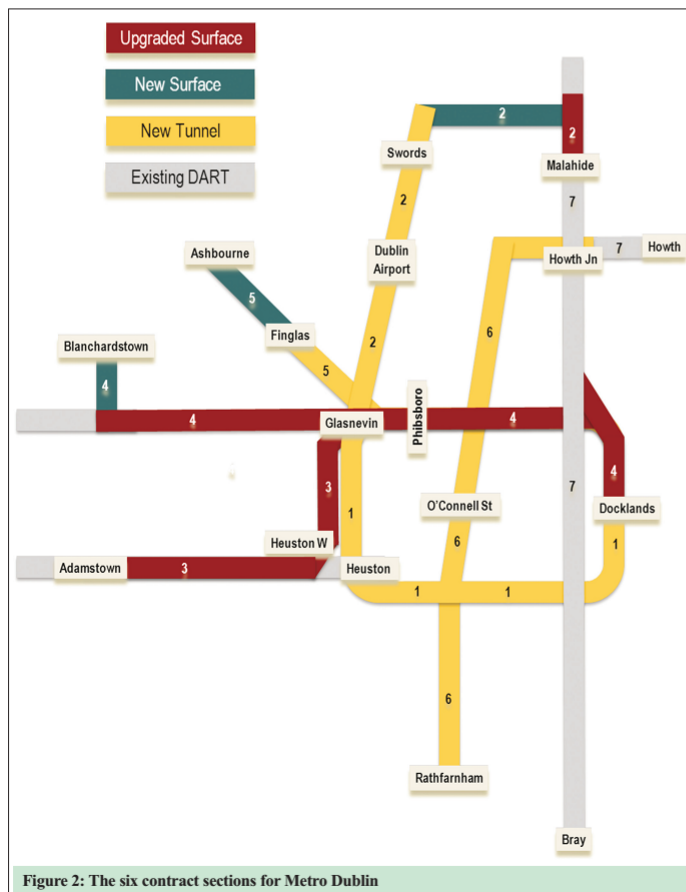

Figure 2: The six contract sections for Metro Dublin

Metro Dublin's application for a Railway Order is being developed through the consultative and developmental process set out in Irish Acts and Regulations – a process that is open to scrutiny, debate and criticism. The development works will be transparent through the utilisation of the competitive EU e-tender procurement processes for Multiple Framework Contracts, and divided into nine 'contract groups' to facilitate construction completion over 35 months.

Through such processes, Metro Dublin fits in with the Government's priority to achieve value-for-money outcomes. It will provide fair and equal opportunities for private and public sector participants to partake through open competitive tenders.

On the question of land acquisition, Metro Dublin needs, for most of its development, only to acquire the necessary way-leave land rights to enable its construction, ongoing maintenance and access to stations.

As stated already, the Metro Dublin Development does not conflict with the existing rail services. It runs on grade separated (bridged-over) tracks from the Irish Rail intercity trains and can be seen as complementary to the plans for the Irish Rail DART Underground and the Swiftway bus rapid transit systems. (For instance for people who know Dublin; should DART Underground proceed then platform-to-platform access could be available from the DART Heuston Station directly to the development's stations at the Dublin Institute of Technology, Dublin City University, Dublin Airport and St James's Hospital (and the New Children's Hospital), and from the DART Christchurch Station to O'Connell Street, Croke Park Stadium (capacity 82,300), Beaumont Hospital, Terenure and Rathfarnham).

Metro Dublin with consortium members will fund and bridge-finance the development and after at least two years of metro operation will bring part, or all, of it to market. Metro Dublin has a core team that has capability and credibility to complete its metro development in 2020/2021.

The State, local government and semi-state sector's main contributions are expected to come in the form of permits, licenses, and assets. The European Union is anticipated to provide finance through the European Investment Bank (EIB) which can be repaid from Local Authority planning development levies (system to do so is already activated), income from railway associated property developments, naming rights, etc. Some of the cash flows from the forgoing are projected to purchase part of the development (asset) over a period of 20 years. The metro is likely to be eligible for funds ear-marked for key railway infrastructure as a cross-border rail project that provides a link to Ireland's major international airport and to help reduce carbon emissions.

The European guidelines for the State aid to railway undertakings (OJ: C 184 of 22.7.2008) state that where infrastructure use is open to all potential users in a fair and non-discriminatory manner, and access to that infrastructure is charged for at a rate in accordance with community legislation in force, the Commission considers that public financing of the infrastructure does not constitute State aid. If such financing is considered to constitute aid, it may nevertheless be authorised if the infrastructure in question meets the needs of transport coordination.

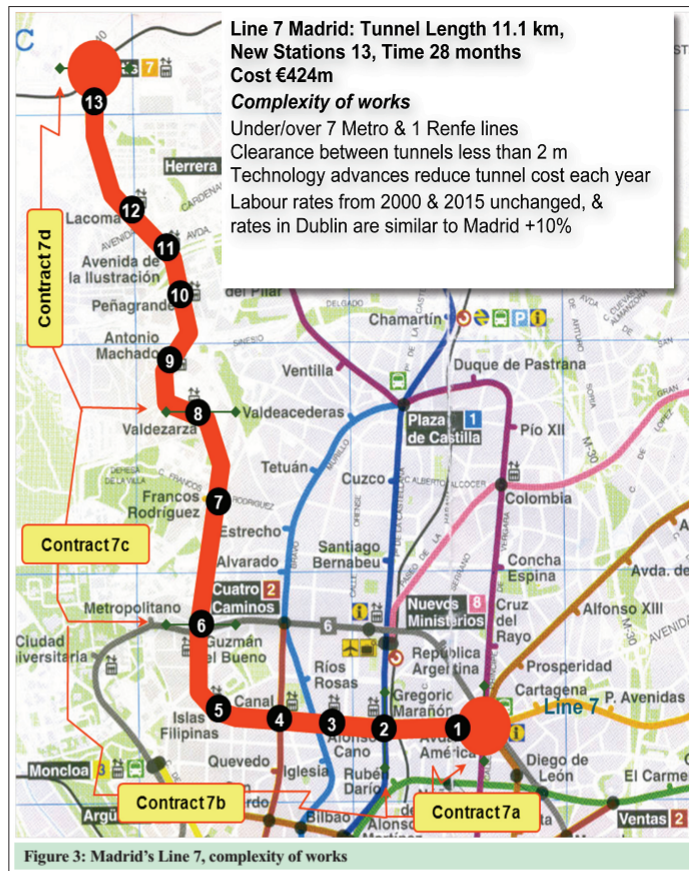

Figure 3: Madrid's Line 7, complexity of works

The European Union is anticipated to provide finance through the European Investment Bank (EIB) which can be repaid from Local Authority planning development levies

The state is a significant holder of land on and near the Metro Dublin lines. It owns this land directly/indirectly through Local Authorities, NAMA (Docklands) and state companies like CIÉ/Irish Rail, Dublin Airport Authority, etc. Metro Dublin will open up these lands for more intensive development and considerably add to their values and exchequer cash flow. It will, for instance, help supply the high quality, well-located office locations that the Irish Industrial Authority says are necessary to continue to attract and maintain Foreign Direct Investment and rates for Local Authorities. This along with the underpinning of business rates, increased property transaction taxes such as capital gains and stamp duty taxes mean that the Exchequer will be in positive cash flow during all stages of the development construction and operation.



Cormac Rabbitt has a Bachelor of Civil and a Master of Industrial Engineering Degrees from the National University of Ireland. He has track record of taking initiatives that helped influence the Irish Government to alter and to proceed with development of motorways and railway, such as building motorways instead of local by-passes to many of Ireland's towns and villages, the realignment of significant sections of motorways away from contentious areas that enabled them to be delivered ahead of their listed position and at lower costs. He also played a pioneering role in developing plans that influenced the Irish Government's decision to develop a metro in Dublin.

The Chairman and Members of
North West Area Committee.

Meeting: 15th March 2016

Item No: 12.

Traffic Service Requests,
Status Report at 15th February 2015,
North West Area Committee Meeting, 15th March 2016

**Traffic Advisory Group (TAG) Service Request
Statistics**

*Total TAG Requests received 01/01/15 to 15/02/16	342
.....of which completed	

No. Requests received since previous report (i.e. between 16/01/16 and 15/02/16).	106
Total Requests received and currently open on Sharepoint since 1 st January, 2013	320

**Breakdown of Requests currently open on
Sharepoint**

Stage 1	9
Stage 2	254
Stage 3	4
Stage 4	38
Stage 5	15

**Non TAG Service Requests
Statistics**

Total Non- TAG Requests received since 2015	676
.....of which Requests Completed	459
Total Requests currently received and open on Sharepoint since 1 st January, 2013	287

Traffic Advisory Group Status Reports

Explanation of Stages:

- Stage 1 - Set up file, Assignment to Engineer, etc
- Stage 2 - Assessment, Site surveys, review statutory orders, etc
- Stage 3 - Consultations, with Garda, Dublin Bus, Luas, NTA, Local residents / businesses, etc
- Stage 4 - Decision, TAG group, statutory orders, etc
- Stage 5 - Implementation, signs, lines, construction, signal changes, certifications, etc

Item	Ref	Road	Post-code	Topic	Request Description	Date Rec'd	SR Status
1	6328	RIVER ROAD (NW-EA)	D15	Speed Ramps	additional Ramp around the corner from Pelletstown Manor.	25/02/2013	Stage 3
2	6358	SHANGAN ROAD (NW-EA)	D11	Traffic Lights	At junction of Balbutcher Lane and Balcurris Road	04/03/2013	Stage 2
3	6375	BALBUTCHER LANE (NW-EA)	D11	Traffic Lights	at junction of Sillogue Road.	28/02/2013	Stage 5
4	6706	BALCURRIS ROAD (NW-EA)	D11	Pedestrian Refuge Island	At pedestrian lights at rear of Ballymun Shopping Centre facing Plunkett Tower	27/03/2013	Stage 5
5	7855	CARRIG ROAD (NW-EA)	D13	Speed Ramps	between Knowth & Druid Court.	26/06/2013	Stage 5
6	7941	KILKIERAN ROAD (NW-EA)	D7	Traffic Calming	at the junction of Kilkiernan Road and Killala Road.	09/07/2013	Stage 5
7	8014	SHANTALLA DRIVE (NW-EA)	D9	Bollards	request for bollards outside Mace shop request also for re-instatement of section of pathway worn away from cars parking & Driving & for grass verge	17/07/2013	Stage 5
8	8218	RIVER ROAD (NW-EA)	D15	Speed Ramps	on the Finglas side of the bend at Pelletstown Manor.	01/08/2013	Stage 3
9	8263	IONA ROAD (NW-EA)	D9	Traffic Island	Request for traffic island or build out at the junction of Crawford Avenue.	08/08/2013	Stage 5
10	8385	CRANOQUE ROAD (NW-EA)	D11	Speed Ramps	Appeal to S.R 6320 - Reps for Ramps on Cranogue Road	19/08/2013	Stage 2

Item	Ref	Road	Post-code	Topic	Request Description	Date Rec'd	SR Status
11	8665	OLD CABRA ROAD (NW-EA)	D7	Traffic Calming	Request for traffic calming measures at the junction of North Circular Road/Old Cabra Road/Prussia Street, at Hanlon's Corner.	12/09/2013	Stage 2
12	8673	SAINT PATRICK'S ROAD (NW-EA)	D9	No Left Turn	Request for no left turn from St. Patrick's Road onto Whitworth Road, during morning peak.	12/09/2013	Stage 4
13	8772	SAINT PATRICK'S ROAD (NW-EA)	D9	No Left Turn	Request for no left turn from St. Patrick's Road onto Whitworth Road, during morning peak.	20/09/2013	Stage 4
14	8810	COULTRY DRIVE (NW-EA)	D9	Speed Ramps	close to No. 27.	07/10/2013	Stage 5
15	9050	JAMESTOWN ROAD (NW-EA)	D11	Pedestrian Crossing	at the Jamestown Road roundabout.	11/10/2013	Stage 2
16	9052	JAMESTOWN ROAD (NW-EA)	D11	Pedestrian Crossing	at the Jamestown Road roundabout.	20/05/2013	Stage 2
17	9302	BALCURRIS ROAD (NW-EA)	D11	Traffic Lights	Request for Traffic Lights and at the junction of Balcurris Road and Balbutcher Lane.	08/11/2013	Stage 2
18	9683	BALBUTCHE R LANE (NW-EA)	D11	Traffic Calming	at its junction with Carton Terrace/Carton Drive.	02/12/2013	Stage 5
19	9694	CAPPAGH ROAD (NW-EA)	D11	Cul-De-Sac	to turn Cappagh Road into a cul-de-sac between Nos. 190-262.	02/12/2013	Stage 4
20	9767	CAPPAGH ROAD (NW-EA)	D11	No Entry	'No Entry' opposite Nos. 265 Cappagh Road in the section between property Nos. 186-272.	04/12/2013	Stage 4
21	9921	CRAWFORD AVENUE (NW-EA)	D9	Buildout	near the junction of Iona Road.	06/12/2013	Stage 5
22	9930	BALBUTCHE R LANE (NW-EA)	D11	Traffic Lights	at the junction of Balcurris Road, adjacent to old Ballymun Shopping centre car park.	20/12/2013	Stage 2
23	10199	GRIFFITH AVENUE (NW-EA)	D9	3 Tonne Limit	for traffic travelling westwards from Swords Road junction.	13/01/2014	Stage 4
24	10580	FAUSSAGH AVENUE (NW-EA)	D7	Traffic Calming	update on traffic calming request at this junction	11/02/2014	Stage 2
25	10792	BALBUTCHE R LANE (NW-EA)	D11	Traffic Lights	at the Balcurris Road junction.	21/02/2014	Stage 2

Item	Ref	Road	Post-code	Topic	Request Description	Date Rec'd	SR Status
26	11377	KEMPTON WAY (NW-EA)	D7	Speed Ramps	on the road.	26/03/2014	Stage 2
27	11475	SKREEN ROAD (NW-EA)	D7	Traffic Lights	at the junction of Navan Road.	01/04/2014	Stage 2
28	11485	MILLBOURNE AVENUE (NW-EA)	D9	Pay & Display & Permit Parking	on the road.	01/04/2014	Stage 4
29	11583	CHURCH AVENUE (NW-EA)	D9	Engineer Query	parking provision at the Glasnevin Educate Together National School.	03/04/2014	Stage 2
30	11723	BALBUTCHER LANE (NW-EA)	D11	Roundabout	Roundabout at junction of Balbutcher Lane, Jamestown Rd adjacent to Fás Centre, Poppintree & Willows FC	11/04/2014	Stage 2
31	11921	MILLMOUNT AVENUE (NW-EA)	D9	Buildout		24/04/2014	Stage 4
32	12043	COLLINS DRIVE (NW-EA)	D11	Zebra Crossing	at the junction of Glasaree Road.	29/04/2014	Stage 2
33	12052	COULTRY ROAD (NW-EA)	D9	Zebra Crossing	at Gaelscoil Bhail Munna.	29/04/2014	Stage 2
34	12144	LEIX ROAD (NW-EA)	D7	Double Yellow Lines	resident at corner house on 7 Leix Rd cannot exit her home sometimes due to cars parking on footpath and blocking her vision	06/05/2014	Stage 2
35	12227	BALBUTCHER LANE (NW-EA)	D11	Traffic Lights	at Carton Close/ Carton Court/Carton Road.	12/05/2014	Stage 2
36	12405	STORMANSTOWN ROAD (NW-EA)	D11	Speed Ramps	additional ramp on the road.	12/05/2014	Stage 5
37	12406	BALLYGALL ROAD EAST (NW-EA)	D11	Cycle Track	on both sides of the road.	12/05/2014	Stage 2
38	12611	SAINT HELENA'S ROAD (NW-EA)	D11	Pedestrian Crossing	south of Tesco's	26/05/2014	Stage 2
39	12612	SAINT HELENA'S ROAD (NW-EA)	D11	Pedestrian Crossing	at the junction of Tolka Valley Road.	26/05/2014	Stage 2
40	12644	SAINT PATRICK'S	D9	No Left Turn	from St. Patrick's Road onto Whitworth Road, during	29/05/2014	Stage 2

Item	Ref	Road	Post-code	Topic	Request Description	Date Rec'd	SR Status
		ROAD (NW-EA)		(Rescind)	morning peak.		
41	1264 6	SAINT PATRICK'S ROAD (NW-EA)	D9	Traffic Calming	on the road.	29/05/2014	Stage 2
42	1269 2	SAINT CANICES ROAD (NW-EA)	D11	Traffic Lights	request for traffic lights at the junctin of St Canices Rd and Ballymun Rd	04/06/2014	Stage 2
43	1290 6	FINGLAS ROAD (NW-EA)	D11	Disabled Parking Bay (General)	and rescindment of Pay and Display Parking at the parking bay nearest the pedestrian lights to facilitate the Museum.	23/06/2014	Stage 2
44	1309 4	DUNMANUS ROAD (NW-EA)	D7	Parking Prohibition	on Dunmanus Road at Rowan Hamilton Court.	07/07/2014	Stage 5
45	1322 5	BLACKHORSE AVENUE (NW-EA)	D7	Traffic Lights	at the Ashtown Gate.	18/07/2014	Stage 2
46	1322 6	JAMESTOWN ROAD (NW-EA)	D11	Pedestrian Crossing	at the Jamestown Road roundabout.	18/07/2014	Stage 2
47	1331 6	PROSPECT SQUARE (NW-EA)	D9	Pay & Display & Permit Parking	on Prospect Square and on St. Teresa Road and St. Teresa Place.	16/07/2014	Stage 4
48	1333 7	CLAREMONT COURT (NW-EA)	D11	Pedestrian Crossing	on Claremont Court at the junction of Fingals Road.	22/07/2014	Stage 2
49	1366 4	NAVAN ROAD (NW-EA)	D7	Bus Lane	from the Old Cabra Road to Nephin Road junction, outbound.	18/08/2014	Stage 4
50	1379 6	CABRA DRIVE (NW-EA)	D7	Parking Prohibition	North west side. from the corner of No. 23 to Old Cabra Road and rescindment of stat no. 18270 (no parking). To be reviewed by Area Engineer.	28/08/2014	Stage 4
51	1388 1	RIVER ROAD (NW-EA)	D11	Speed Ramps	request for ramp @ 'slow' marking beside Pelletstown Manor from Finglas side, River Road	05/09/2014	Stage 2
52	1397 0	SWORDS ROAD (NW-EA)	D9	Traffic Lights	at the exit to Elmhurst Nursing Home on Swords Road.	05/09/2014	Stage 2
53	1403 2	RIVER ROAD (NW-EA)	D15	Speed Ramps	On River Road, near Pelletstown Manor.	16/09/2014	Stage 3
54	1405 9	PINEWOOD AVENUE (NW-EA)	D11	Speed Ramps	on the road	15/09/2014	Stage 2

Item	Ref	Road	Post-code	Topic	Request Description	Date Rec'd	SR Status
55	14166	MILLBOURNE AVENUE (NW-EA)	D9	Parking Prohibition	on the road.	18/09/2014	Stage 4
56	14544	GRIFFITH AVENUE (NW-EA)	D11	Traffic Calming	between Ballymun Road and Ballygall Road East.	06/10/2014	Stage 2
57	14545	BALLYBOGGAN ROAD (NW-EA)	D11	Pedestrian Refuge Island	at the junction of Ballyboggan Road and Broombridge Road.	06/10/2014	Stage 5
58	14626	RATOATH ROAD (NW-EA)	D7	Traffic Calming	on Cabra and Finglas ends of the road.	21/10/2014	Stage 2
59	14627	FAUSSAGH AVENUE (NW-EA)	D7	Traffic Calming	on the road.	21/10/2014	Stage 2
60	14628	NEPHIN ROAD (NW-EA)	D7	Traffic Calming	on the road.	21/10/2014	Stage 2
61	14630	HAZELCROFT ROAD (NW-EA)	D11	Traffic Calming	at the junction of Hazelcroft Road and Fairlawn Road.	21/10/2014	Stage 2
62	14631	FAIRLAWN ROAD (NW-EA)	D11	Traffic Calming	request for traffic calming on the road.	21/10/2014	Stage 2
63	14750	IONA CRESCENT (NW-EA)	D9	Stop Sign	'Stop' <u>or</u> 'Yield' Sign at the junction of Iona Villas.	13/10/2014	Stage 2
64	14798	RATOATH ROAD (NW-EA)	D11	Pedestrian Crossing	at the entrance to Colaiste Mhuire.	14/10/2014	Stage 2
65	15106	FAUSSAGH AVENUE (NW-EA)	D7	Traffic Calming	on the road.	10/11/2014	Stage 2
66	15210	SILLOGE AVENUE (NW-EA)	D11	School Warden Crossing Box	Request for School Warden Crossing Boxes and pedestrian barriers at both existing School Warden Crossing points to provide extra safety and visibility for School Wardens	11/11/2014	Stage 4
67	15215	BALBUTCHE R LANE (NW-EA)	D11	Pedestrian Crossing	At the Community Centre, near Carton Road.	04/11/2014	Stage 2
68	15220	VENTRY PARK (NW-EA)	D7	Children Crossing Sign	at Ventry Playground.	18/11/2014	Stage 2
69	15231	BROOMBRIDGE ROAD (NW-EA)	D7	Double Yellow Lines	on the corners from 121/123 Broombridge Road to 353 Bannow Road.	18/11/2014	Stage 2
70	15352	ALBERT COLLEGE LAWN (NW-	D9	Pay & Display & Permit	Request for parking restriction as above.	12/11/2014	Stage 2

Item	Ref	Road	Post-code	Topic	Request Description	Date Rec'd	SR Status
		EA)		Parking			
71	1547 3	VILLA PARK GARDENS (NW-EA)	D7	Double Yellow Lines	at the footpath dishing opposite the Credit Union.	25/11/2014	Stage 2
72	1549 0	IONA ROAD (NW-EA)	D9	Engineer Query	Request to investigate dangerous junction and slow down traffic at above.	20/11/2014	Stage 4
73	1554 1	KILDONAN ROAD (NW-EA)	D11	Yellow Box (Extend)	Dublin Bus request yellow box be enlarged as current size box restricts movement turning from Kildonan Road onto Mellowes Road.	25/11/2014	Stage 2
74	1555 6	SHANTALLA ROAD (NW-EA)	D9	One-Way System	at the service road at the shops.	26/11/2014	Stage 2
75	1560 9	WHITWORTH ROAD (NW-EA)	D9	Speed Ramps	to replace the Speed Cushions with Speed Ramps.	26/11/2014	Stage 2
76	1578 7	SYCAMORE PARK (NW-EA)	D11	Engineer Query	NWAC 16/12/14 - to arrange for a traffic inspection at the junction of Sycamore Park and Sycamore Road especially at peak times such as the morning school run. Can the Manager arrange for a pelican crossing and/or double yellow lines at the junction please	16/12/2014	Stage 2
77	1584 5	SYCAMORE PARK (NW-EA)	D11	Engineer Query	Request for traffic inspection of the junction of Sycamore Park and Sycamore Road.	16/12/2014	Stage 2
78	1584 6	SYCAMORE PARK (NW-EA)	D11	Pedestrian Crossing	Request for Pelican Crossing at the junction of Sycamore Park and Sycamore Road.	16/12/2014	Stage 2
79	1584 7	SYCAMORE PARK (NW-EA)	D11	Double Yellow Lines	at the junction of Sycamore Park and Sycamore Road.	16/12/2014	Stage 2
80	1585 4	BALLYMUN ROAD (NW-EA)	D9	Loading Bay	at the shops, at The Grapevine Off Licence.	15/12/2014	Stage 2
81	1586 6	SHANTALLA ROAD (NW-EA)	D9	Disabled Parking Bay (General)	outside The Haven Pharmacy, 2, Shantalla Road.	12/12/2014	Stage 2
82	1587 2	SAINT PATRICK'S PARADE (NW-EA)	D9	Double Yellow Lines	on the road.	18/12/2014	Stage 2
83	1598 7	SAINT MOBHI BOITHIRIN	D9	Parking Prohibition	opposite Nos. 1-3.	19/12/2014	Stage 2

Item	Ref	Road	Post-code	Topic	Request Description	Date Rec'd	SR Status
		(NW-EA)					
84	1607 1	OLD FINGLAS ROAD (NW- EA)	D11	School Warden	To relocate the existing School Warden to the pedestrian gate of St. Brigid's GNS.	12/01/2015	Stage 2
85	1615 3	BERRYFIELD ROAD (NW- EA)	D11	Children Crossing Sign	on the road.	20/01/2015	Stage 2
86	1615 7	BOTANIC VILLAS (NW- EA)	D9	Double Yellow Lines	on one side of Botanic Villas between Nos. 120 and 124 Botanic Road.	20/01/2015	Stage 2
87	1616 9	THE RISE (NW-EA)	D9	Continuous White Line (Rescind)	at the Ballymun Road junction.	16/01/2015	Stage 2
88	1625 1	THE RISE (NW-EA)	D9	Continuous White Line (Rescind)	Remove continuous white line from The Rise, Glasnevin at junction with Ballymun Road.	20/01/2015	Stage 2
89	1625 9	ULSTER STREET (NW-EA)	D7	Double Yellow Lines (Extend)	on Ulster Street at Coonaught Street junction.	20/01/2015	Stage 2
90	1645 9	CARNLOUGH ROAD (NW- EA)	D7	Traffic Calming	on the road.	02/02/2015	Stage 2
91	1651 9	VILLA PARK GARDENS (NW-EA)	D7	Parking Prohibition	Request for Double Yellow Lines or Single Yellow Line.	04/02/2015	Stage 3
92	1652 9	CONNAUGHT STREET (NW-EA)	D7	Speed Ramps	on the road.	05/02/2015	Stage 2
93	1653 5	FAUSSAGH AVENUE (NW-EA)	D7	Speed Cushions	Speed cushions for Faussagh Ave, before completion of O' Reilly Bridge flyover.	03/02/2015	Stage 2
94	1654 4	GLASANAON ROAD (NW- EA)	D11	Pedestrian Crossing	at Gaelscoil Ui Earcain.	05/02/2015	Stage 2
95	1659 2	IONA ROAD (NW-EA)	D9	Pay & Display & Permit Parking	On the un-named road that connects Iona Road to Lindsay Road.	05/11/2014	Stage 2
96	1661 5	SHANDON PARK (NW- EA)	D7	Disabled Parking Bay (Residentia l)	outside No. 21.	10/02/2015	Stage 5
97	1669 4	RATOATH ROAD (NW- EA)	D7	Continuous White Line	and rescindment of broken white line at the new bridge.	13/02/2015	Stage 4

Item	Ref	Road	Post-code	Topic	Request Description	Date Rec'd	SR Status
98	16697	RATOATH ESTATE (NW-EA)	D7		Motion 5 NWAC 17/12/15	17/02/2015	Stage 4
99	16704	BALBUTCHER LANE (NW-EA)	D11	Pedestrian Crossing	at the Poppintree Sports Centre.	17/02/2015	Stage 2
100	16705	PROSPECT SQUARE (NW-EA)	D11	Pay & Display & Permit Parking	on the road.	17/02/2015	Stage 4
101	16706	MILLMOUNT AVENUE (NW-EA)	D9	Pay & Display & Permit Parking		17/02/2015	Stage 4
102	16726	WALSH ROAD (NW-EA)	D9	Traffic Calming	request for additional traffic calming.	16/02/2015	Stage 2
103	16788	CARTON TERRACE (NW-EA)	D11	Pedestrian Crossing	Carton Terrace/Balbutcher Lane at the Poppintree Community Centre.	18/02/2015	Stage 2
104	16812	SKREEN ROAD (NW-EA)	D7	Parking Prohibition	on the road.	20/02/2015	Stage 2
105	16875	FAUSSAGH ROAD (NW-EA)	D7	Speed Ramps	on the road.	05/02/2015	Stage 2
106	16876	FAUSSAGH AVENUE (NW-EA)	D7	Speed Ramps	on the road.	07/02/2015	Stage 2
107	16889	DRUMCONDRA ROAD UPPER (NW-EA)	D9	No Right Turn	from Millmount Avenue onto Drumcondra Road.	24/02/2015	Stage 2
108	17007	RATOATH ROAD (NW-EA)	D7	Traffic Calming	from the roundabout at Drumcliffe Road up to Cabra cross.	02/03/2015	Stage 2
109	17010	SYCAMORE ROAD (NW-EA)	D11	Traffic Calming	on the road.	02/03/2015	Stage 2
110	17190	GLASANAON ROAD (NW-EA)	D11	Pedestrian Crossing	outside the Gael Scoil.	03/03/2015	Stage 2
111	17259	CARNLOUGH ROAD (NW-EA)	D7	Traffic Calming	on the road.	24/03/2015	Stage 2
112	17311	COOLATREE PARK (NW-EA)	D9	Speed Ramps	on the road.	23/03/2015	Stage 2
113	17529	VICTORIA LANE (NW-EA)	D9	Parking Prohibition	on Victoria Lane, the laneway to the rear of Nos. 2-48, Botanic Avenue and Nos. 1-55,	25/03/2015	Stage 2

Item	Ref	Road	Post-code	Topic	Request Description	Date Rec'd	SR Status
					Hollybank Road.		
114	1770 7	QUARRY ROAD (NW-EA)	D7	Engineer Query	NWAC 21/04/15 - review of possible solutions to tackle the illegal parking at the pedestrian entrance to Homestead Court on Quarry Road	21/04/2015	Stage 5
115	1778 5	KEMPTON GROVE (NW-EA)	D7	Double Yellow Lines	Opposite No. 6.	22/04/2015	Stage 2
116	1779 8	FINGLAS ROAD (NW-EA)	D11	Yellow Box	inbound at the pedestrian crossing at the junction of Ballyboggan Road.	23/04/2015	Stage 2
117	1780 0	FINGLAS ROAD (NW-EA)	D11	No U Turn	outbound at the junction of Ballyboggan Road, preventing a U Turn onto the inbound lane.	23/04/2015	Stage 2
118	1782 6	CRAWFORD AVENUE (NW-EA)	D9	Disabled Parking Bay (Residential)	outside No. 12. Pay and Display and Permit Parking will have to be rescinded.	24/04/2015	Stage 5
119	1803 7	GROVE WOOD (NW-EA)	D11	Traffic Calming	on the road.	07/05/2015	Stage 2
120	1807 8	COOLATREE PARK (NW-EA)	D9	Stop Sign	and rescindment of 'Yield' Sign on Coolatree Park at the junction of Coolgreena Road.	08/05/2015	Stage 2
121	1807 9	COOLGREENA ROAD (NW-EA)	D9	School Ahead Sign	on Coolgreena Road and Coolatree Park.	08/05/2015	Stage 2
122	1808 2	BEAUMONT ROAD (NW-EA)	D9	No Right Turn	from Beaumont Road onto Coolgreena Road, during morning peak.	08/05/2015	Stage 2
123	1808 7	THE PADDOCK (NW-EA)	D7	Traffic Calming	Request for a ramp at entrance/exit to estate.	11/05/2015	Stage 2
124	1815 3	RIVER ROAD (NW-EA)	D11	Traffic Calming	at the bend.	19/05/2015	Stage 2
125	1815 4	MCKEE PARK (NW-EA)	D11		at entrance.	19/05/2015	Stage 2
126	1815 6	BLACKHORSE AVENUE (NW-EA)	D7	Zebra Crossing	at the Cabra Gate entrance to Phoenix Park.	19/05/2015	Stage 2
127	1815 9	RATOATH ROAD (NW-EA)	D11	Continuous White Line	on the road at the new bridge.	19/05/2015	Stage 4

Item	Ref	Road	Post-code	Topic	Request Description	Date Rec'd	SR Status
128	18160	HOME FARM ROAD (NW-EA)	D9	Double Yellow Lines	outside the garage of property no. 29.	19/05/2015	Stage 2
129	18161	WALSH ROAD (NW-EA)	D9	Pedestrian Crossing	facing Griffith Park.	19/05/2015	Stage 2
130	18163	CREMORE CRESCENT (NW-EA)	D11	Double Yellow Lines	at entrance.	19/05/2015	Stage 2
131	18195	GLASANAON ROAD (NW-EA)	D11	Parking Prohibition	outside Nos. 154-208.	15/05/2015	Stage 2
132	18265	NAVAN ROAD (NW-EA)	D7	Yellow Box	on the road.	15/05/2015	Stage 4
133	18268	SAINT MOBHI ROAD (NW-EA)	D9	Yellow Box	on the road.	15/05/2015	Stage 4
134	18409	FINGLAS PLACE (NW-EA)	D11	Traffic Calming	on the road.	28/05/2015	Stage 2
135	18421	WILLOW PARK CRESCENT (NW-EA)	D11	Pedestrian Crossing	at the shops.	29/05/2015	Stage 2
136	18422	WILLOW PARK CRESCENT (NW-EA)	D11	Pedestrian Refuge Island (Rescind)	at the shops.	29/05/2015	Stage 2
137	18423	WILLOW PARK CRESCENT (NW-EA)	D11	Speed Ramps	on the inner road along the adjoining green area.	29/05/2015	Stage 2
138	18424	WILLOW PARK ROAD (NW-EA)	D11	Double Yellow Lines	at the junction of Willow Park Crescent.	29/05/2015	Stage 2
139	18489	BALLYGALL PARADE (NW-EA)	D11	Road Closure (Rescind)	at the western end of the road.	15/06/2015	Stage 2
140	18545	IONA PARK (NW-EA)	D9	Disabled Parking Bay (Rescind Residential)	outside No. 14.	08/06/2015	Stage 4
141	18622	SAINT PATRICK'S PARADE (NW-EA)	D7	Traffic Calming	on the road.	16/06/2015	Stage 2
142	18624	VALEVIEW CRESCENT	D11	Speed Ramps	request for speed ramps on Valeview Crescent.	16/06/2015	Stage 2

Item	Ref	Road	Post-code	Topic	Request Description	Date Rec'd	SR Status
		(NW-EA)					
143	18630	SAINT PATRICK'S PARADE (NW-EA)	D9	One-Way System	on the road.	16/06/2015	Stage 2
144	18653	GROVE WOOD (NW-EA)	D11	Speed Ramps	on the road.	08/06/2015	Stage 2
145	18705	WILLOW PARK CRESCENT (NW-EA)	D11	3.5 Tonne Limit	on the road.	29/05/2015	Stage 4
146	18715	FARNHAM DRIVE (NW-EA)	D11	Pedestrian Crossing	crossing to the pitches.	16/06/2015	Stage 4
147	18716	GROVE WOOD (NW-EA)	D11	Speed Ramps	on the road.	16/06/2015	Stage 2
148	18741	DALCASSIAN DOWNS (NW-EA)	D11	Double Yellow Lines	between 4 & 5, and 90 & 91 Dalcassian Downs.	15/06/2015	Stage 4
149	18766	FITZMAURICE ROAD (NW-EA)	D11	Pedestrian Crossing	Pedestrian crossing at the shops on Fitzmaurice Rd, at junction with Ballygall Rd East.	17/06/2015	Stage 2
150	18767	FITZMAURICE ROAD (NW-EA)	D11	Children Crossing Sign	Children Crossing sign at shops on Fitzmaurice Rd, at junction with Ballygall Rd East.	17/06/2015	Stage 2
151	18808	SAINT TERESA ROAD (NW-EA)	D9	Disabled Parking Bay (Residential)	outside No. 7.	22/06/2015	Stage 4
152	18831	DRUMCONDRA ROAD LOWER (NW-EA)	D9	Stop Sign	and rescindment of 'Yield' Sign on the cycle lane at the entrance to the Archbishop's House.	22/06/2015	Stage 2
153	18851	CABRA DRIVE (NW-EA)	D7	No Parking	request for No Parking/Double Yellow Lines on the north west corner of the entrance road to Cabra Drive from the Old Cabra Road	24/06/2015	Stage 2
154	18857	LINDSAY ROAD (NW-EA)	D9	Yellow Box (Extend)	at junction of Hart's Rd/Lindsay Rd.	23/06/2015	Stage 2
155	18878	LINDSAY ROAD (NW-EA)	D9	Speed Ramps	Request for additional speed ramps on above road	24/06/2015	Stage 2

Item	Ref	Road	Post-code	Topic	Request Description	Date Rec'd	SR Status
156	18913	SHANDON PARK (NW-EA)	D7		Request for Children crossing sign at above locations and also Shandon Gardens	24/06/2015	Stage 2
157	18957	BOTANIC ROAD NW-EA)	D9	Yellow Box	Request for yellow box at junction of the Smurfit site on Botanic Road	30/07/2015	Stage 2
158	19020	BLACKHORSE AVENUE (NW-EA)	D7	Pedestrian Crossing	in the vicinity of Cabra Gate entrance to the Phoenix Park.	03/07/2015	Stage 2
159	19029	WALSH ROAD (NW-EA)	D9	Speed Ramps	Request for additional speed ramps	06/07/2015	Stage 2
160	19062	SAINT EITHNE ROAD (NW-EA)	D7	Speed Ramps	Request from Clare Johnson NWAO Area Office for ramps on behalf of residents.	07/07/2015	Stage 2
161	19079	FINGLAS PLACE (NW-EA)	D11	Road Closure	at one end of the road.	28/05/2015	Stage 2
162	19152	KEMPTON AVENUE (NW-EA)	D7	Traffic Calming	at the entrance to the Kempton Estate off the Navan Road	21/07/2015	Stage 2
163	19153	BROOMBRIDGE ROAD (NW-EA)	D7	Double Yellow Lines	At the junctions of Broombridge Road, Kilkieran Road and Ventry Road.	21/07/2015	Stage 2
164	19155	CARNLOUGH ROAD (NW-EA)	D7	Parking Prohibition	to examine the corners of Carnlough Road for illegal parking	21/07/2015	Stage 2
165	19172	NAVAN ROAD (NW-EA)	D5	Single Yellow Line	in the vicinity of No. 52	21/07/2015	Stage 2
166	19184	PLUNKETT ROAD (NW-EA)	D11	Speed Ramps	Speed ramps requested for Plunkett Road	16/07/2015	Stage 2
167	19275	GLASANAON ROAD (NW-EA)	D11	Pedestrian Crossing	at Gaelscoil Ui Earcain.	16/07/2015	Stage 2
168	19384	OFFALY ROAD (NW-EA)	D7	Double Yellow Lines	Requesting double yellow lines at the junction of Offaly Road & Dowth Avenue	24/07/2015	Stage 2
169	19433	DRUMCONDRA ROAD UPPER (NW-EA)	D9	Yellow Box	at the entrance to the Nest Creche/Skylon Hotel.	30/07/2015	Stage 2
170	19493	OLD CABRA ROAD (NW-EA)	D7	Continuous White Line	for continuous white line in front of the bus stop opposite No. 79a.	05/08/2015	Stage 4
171	19496	BLACKHORSE AVENUE (NW-EA)	D7	Traffic Calming	Requesting traffic calming measures be put in place at the entrance to Phoenix Park	21/07/2015	Stage 4

Item	Ref	Road	Post-code	Topic	Request Description	Date Rec'd	SR Status
172	1951 2	BALLYGALL ROAD WEST (NW-EA)	D11	Double Yellow Lines	At the rear of St. Canice's Church.	05/08/2015	Stage 2
173	1951 4	CLUNE ROAD (NW-EA)	D11	Speed Ramps		05/08/2015	Stage 2
174	1954 6	WALSH ROAD (NW-EA)	D9	Speed Ramps	For additional speed ramps on the road.	06/08/2015	Stage 2
175	1962 5	DRUMCONDRA ROAD UPPER (NW-EA)	D9	Yellow Box	Outside the northern vehicular entrance to St. Patrick's College.	13/08/2015	Stage 2
176	1965 3	CLAUDE ROAD (NW-EA)	D9	Disabled Parking Bay (Rescind Residential)	Remove disabled parking bay o/s 26 Claude Rd.	13/08/2015	Stage 4
177	1966 6	THE THATCH ROAD (NW-EA)	D9	Yellow Box (Rescind)	Requesting that yellow lines be removed from in front of ESB Boxes across from Thatch Road	14/08/2015	Stage 2
178	1969 4	KINVARA DRIVE (NW-EA)	D7	Traffic Calming	Traffic calming measures for Kinvara Drive.	17/08/2015	Stage 2
179	1969 9	GRIFFITH DOWNS (NW-EA)	D9	Engineer Query		17/08/2015	Stage 4
180	1972 5	FINGLAS PARK (NW-EA)	D11	Traffic Calming	on the long straight section.	15/09/2015	Stage 2
181	1972 6	WOODHAZEL WAY (NW-EA)	D11	Traffic Calming	at the junction of Woodhazel Way and Woodhazel Close.	15/09/2015	Stage 2
182	1975 5	HAMPSTEAD PARK (NW-EA)	D9	Traffic Calming	Request for traffic calming measures	21/08/2015	Stage 2
183	1983 5	WALSH ROAD (NW-EA)	D9	Cul-De-Sac	Request for northern ends of above roads to be blocked off (cul de sacs to be put in place).	26/08/2015	Stage 2
184	1983 9	DARGLE ROAD (NW-EA)	D9	Loading Bay	Convert easternmost P&D parking space into a Loading Bay.	26/08/2015	Stage 2
185	1985 9	GLASILAWN AVENUE (NW-EA)	D11	Loading Bay	Outside 19 Glasilawn Avenue, Dublin 11	27/08/2015	Stage 2
186	1990 7	BOTANIC AVENUE (NW-EA)	D9	Yellow Box	Yellow Boxes for Botanic Avenue.	31/08/2015	Stage 2

Item	Ref	Road	Post-code	Topic	Request Description	Date Rec'd	SR Status
187	1990 8	BOTANIC AVENUE (NW-EA)	D9	Filter Light	Filter light for junction of Saint Mobhi Rd & Botanic Ave.	31/08/2015	Stage 2
188	1991 0	RATOATH ROAD (NW-EA)	D7	School Ahead Sign	request for school ahead signs to be placed on Ratoath Road in Cabra , two schools - Saint Catherines and Saint Dominics	01/09/2015	Stage 2
189	1991 1	RATOATH ROAD (NW-EA)	D7	Yellow Box	Request for a yellow box to be placed at the entrance of Ratoath estate.	01/09/2015	Stage 2
190	1992 7	LORCAN ROAD (NW-EA)	D9	Pedestrian Crossing	Install pedestrian lights at corner of Lorcan Rd.	01/09/2015	Stage 2
191	1992 8	SWORDS ROAD (NW-EA)	D9	Pedestrian Crossing	Pedestrian crossing, or warning sign, at slip road from McDonalds in OMNI Centre onto the Swords Rd.	01/09/2015	Stage 2
192	1993 3	BEAUMONT ROAD (NW-EA)	D9	Yellow Box	Request for yellow box to be reinstated - Ellenfield on to the Beaumont Road at Lanigan's Funeral Home.	02/09/2015	Stage 4
193	1994 9	RATOATH ROAD (NW-EA)	D7	Yellow Box	Request for yellow box at top end of above road at Cabra Cross	02/09/2015	Stage 2
194	2004 4	LEINSTER STREET NORTH (NW-EA)	D7	Disabled Parking Bay (Rescind General)	Requesting that disabled parking bay be removed outside 18/20 Leinster Street	09/09/2015	Stage 4
195	2006 1	GLEBE VIEW (NW-EA)	D11	Traffic Calming	Request for traffic calming measures in Glebe View off Church Street as motorists speeding into the cul de sac causing dangerous situations for residents.	10/09/2015	Stage 2
196	2006 2	ALBERT COLLEGE LAWN (NW-EA)	D9	Pay & Display & Permit Parking	on the road.	04/09/2015	Stage 2
197	2014 9	BEAUMONT ROAD (NW-EA)	D9	Yellow Box	request to re-instate previously rescinded Yellow Box from front of Lanigans Funeral Home, 21 Beaumont Road (near Yellow Road junction).	11/09/2015	Stage 4
198	2017 4	BOTANIC AVENUE (NW-EA)	D9	Traffic Calming	reps for review of traffic management on Botanic Avenue	15/09/2015	Stage 2
199	2018 1	SAINT FINBAR ROAD (NW-EA)	D7	Children Crossing Sign	on the road.	07/09/2015	Stage 2

Item	Ref	Road	Post-code	Topic	Request Description	Date Rec'd	SR Status
200	2018 4	WALSH ROAD (NW-EA)	D9	Pedestrian Crossing	Pedestrian Crossing for Walsh Rd, near entrance to Griffith Park.	15/09/2015	Stage 2
201	2018 5	DRUMCONDRA ROAD LOWER (NW-EA)	D9	Bus Lane	on the bridge over the Tolka, outbound.	15/09/2015	Stage 2
202	2018 6	ALBERT COLLEGE LAWN (NW-EA)	D9	Pay & Display & Permit Parking	on the road.	15/09/2015	Stage 2
203	2018 8	GLENTIES DRIVE (NW-EA)	D11	Children Crossing Sign	on the road.	15/09/2015	Stage 2
204	2018 9	GLENTIES DRIVE (NW-EA)	D11	Speed Ramps	on the road.	15/09/2015	Stage 2
205	2019 0	TOLKA VALLEY ROAD (NW-EA)	D11	Roundabout	at the junction of Ratoath Road.	15/09/2015	Stage 2
206	2023 2	ABBEY DRIVE (NW-EA)	D7	Double Yellow Lines	from the bend at Ashington Park	16/09/2015	Stage 2
207	2023 5	WALSH ROAD (NW-EA)	D9	Traffic Calming	Request for Traffic calming measures put in place	16/09/2015	Stage 2
208	2025 6	LEINSTER STREET NORTH (NW-EA)	D7	Pay & Display & Permit Parking (extension of area)		17/09/2015	Stage 2
209	2027 8	SILLOGE ROAD (NW-EA)	D11	Pedestrian Crossing	Request for pedestrian crossing at Holy Spirit school	21/09/2015	Stage 2
210	2031 7	DINGLE ROAD (NW-EA)	D7	Traffic Calming	Request for speed ramps or traffic calming measures on Dingle Road	21/09/2015	Stage 2
211	2037 9	BALLYMUN ROAD (NW-EA)	D9	Disabled Parking Bay (General)	Request by Cllr to have a disabled parking bay outside the Supervalu shop on Ballymun road.	23/09/2015	Stage 2
212	2038 4	BEAUMONT ROAD (NW-EA)	D9	Yellow Box	outside Lanagans Funeral Directors	24/09/2015	Stage 4
213	2038 5	CABRA GROVE (NW-EA)	D7	Double Yellow Lines	at the junction of Cabra Grove and Cabra Road.	24/09/2015	Stage 2

Item	Ref	Road	Post-code	Topic	Request Description	Date Rec'd	SR Status
214	20487	DRUMCONDRA ROAD LOWER (NW-EA)	D9	Cycle Track	request in irish by crm for cycle track after Fagans Pub to the bridge in Drumcondra (R Tolka)	30/09/2015	Stage 2
215	20494	DANE ROAD (NW-EA)	D11	Speed Ramps	Request for speed ramps on St Josephs Way, off Dane road, beside Cairn Court	30/09/2015	Stage 2
216	20516	SHANGAN AVENUE (NW-EA)	D11	Double Yellow Lines	Request for double yellow lines around the Whiteacre Park Estate	01/10/2015	Stage 2
217	20522	GLASANAON ROAD (NW-EA)	D11	Double Yellow Lines	Request for double yellow lines outside Gaelscoil ui Earcain	01/10/2015	Stage 2
218	20568	PHIBSBOROUGH ROAD (NW-EA)	D7	Yellow Box	Request for yellow box at entrance to Bective Square Apartment complex at junction with Phibsborough road	05/10/2015	Stage 2
219	20630	SCRIBBLESTOWN AVENUE (NW-EA)	D11	Traffic Calming	within the Scribblestown Estate.	20/10/2015	Stage 2
220	20634	CHURCH AVENUE (NW-EA)	D9	Double Yellow Lines	Outside No. 3 Church Avenue. Cars visiting Bon Secours Hospital parking on Church Avenue.	07/10/2015	Stage 2
221	20677	THE THATCH ROAD (NW-EA)	D9	Double Yellow Lines	at entrance beside No.13.	20/10/2015	Stage 2
222	20683	SCRIBBLESTOWN ROAD (NW-EA)	D11	Traffic Calming	in the Estate.	20/10/2015	Stage 2
223	20685	VALLEY PARK ROAD (NW-EA)	D11	Speed Ramps	at entrance.	20/10/2015	Stage 2
224	20704	DELVILLE ROAD (NW-EA)	D11	Stop Sign	at the junction of Delville Road and St Pappin's Road.	20/10/2015	Stage 2
225	20706	RATOATH ROAD (NW-EA)	D7	Right Turn Filter Light	from Ratoath Road onto Navan Road.	20/10/2015	Stage 2
226	20707	BOTANIC AVENUE (NW-EA)	D9	Double Yellow Lines	at the junction of Botanic Avenue with St. Itas Terrace, Botanic Road.	20/10/2015	Stage 2
227	20709	SCRIBBLESTOWN ROAD (NW-EA)	D11	Speed Ramps	on the road.	20/10/2015	Stage 2
228	20711	HOME FARM ROAD (NW-EA)	D9	Cycle Track	between Homefarm Road and Griffith Avenue.	20/10/2015	Stage 2

Item	Ref	Road	Post-code	Topic	Request Description	Date Rec'd	SR Status
229	20729	KINVARA AVENUE (NW-EA)	D8	Pedestrian Crossing	Request from area office from Navan Rd community council for pedestrian lights at Kinvara Avenue and Ashtown Grove.	12/10/2015	Stage 2
230	20786	GRIFFITH DOWNS (NW-EA)	D9	Engineer Query	turning right onto the yellow box	13/10/2015	Stage 4
231	20792	GRIFFITH DOWNS (NW-EA)	D9	Engineer Query	Request from Roisin Shortall to have yellow box and exiting Griffith Downs looked at as it causes a danger to residents exiting and turning right.	13/10/2015	Stage 4
232	20793	KEMPTON WAY (NW-EA)	D15	Speed Ramps	on the road	13/10/2015	Stage 2
233	20794	COLLINS AVENUE (NW-EA)	D11	Yellow Box	to review traffic at the pedestrian lights at junction of Collins Avenue and Ballymun Road.	20/10/2015	Stage 2
234	20801	TOLKA COTTAGES (NW-EA)	D11	Disabled Parking Bay (Residential)	outside No. 12.	15/10/2015	Stage 4
235	20847	SCRIBBLESTOWN AVENUE (NW-EA)	D11	Traffic Calming	In Scribblestown Estate.	16/10/2015	Stage 2
236	20848	PARKGATE STREET (NW-EA)	D8	Loading Bay	Outside 25 Parkgate Street, Dublin 8.	16/10/2015	Stage 2
237	20868	CONNAUGHT STREET (NW-EA)	D7	Disabled Parking Bay (Residential)	To determine whether the road is high demand or not in relation to the level of parking occupancy for the provision of a bay outside No. 37. Pay and Display and Permit Parking will have to be rescinded.	19/10/2015	Stage 2
238	20916	OLD FINGLAS ROAD (NW-EA)	D11	School Warden	To relocate the existing School Warden to the pedestrian gate of St. Brigid's GNS.	06/10/2015	Stage 2
239	20963	FERGUSON ROAD (NW-EA)	D9	Speed Ramps (Rescind)	on the road.	20/10/2015	Stage 2
240	20984	CLAREMONT COURT (NW-EA)	D11	Double Yellow Lines	from 5m after the junction with Finglas Rd, in towards the first residence on Claremont Court.	22/10/2015	Stage 2

Item	Ref	Road	Post-code	Topic	Request Description	Date Rec'd	SR Status
241	2099 1	NAVAN ROAD (NW-EA)	D7	No Parking	Request to disallow parking outside crèche at 351a Navan Rd.	22/10/2015	Stage 2
242	2105 7	COLLINS AVENUE (NW-EA)	D9	Yellow Box	at the exit of Whitehall Church at Collins Avenue.	27/10/2015	Stage 2
243	2107 6	MANNIX ROAD (NW-EA)	D9	Cul-De-Sac	To make Mannix Road a Cul-de-Sac, between the rear entrance to Mannix Road and the Hollybank Road entrance.	28/10/2015	Stage 2
244	2109 4	GLASNEVIN AVENUE (NW-EA)	D9	Pedestrian Crossing	To review the Pedestrian Crossings at the junction of Glasnevin Avenue/Collins Avenue/Ballymun Road.	28/10/2015	Stage 2
245	2109 6	ALBERT COLLEGE PARK (NW-EA)	D9	Double Yellow Lines	at the junction of Collins Avenue Extension.	28/10/2015	Stage 2
246	2109 7	OLD FINGLAS ROAD (NW-EA)	D11	School Warden	at St. Mary's Faith Secondary School.	28/10/2015	Stage 2
247	2110 0	SAINT PAPPIN ROAD (NW-EA)	D11	Parking Prohibition	at the western junction of Dean Swift Road and St. Pappin's Road.	28/10/2015	Stage 2
248	2110 7	OLD CABRA ROAD (NW-EA)	D7	Traffic Calming	To review the traffic calming measures on the road.	27/10/2015	Stage 2
249	2112 1	SKREEN ROAD (NW-EA)	D7	Traffic Lights	at the junction of Navan Road.	28/10/2015	Stage 2
250	2112 2	GLENBEIGH ROAD (NW-EA)	D7	Double Yellow Lines	at the junction of Old Cabra Road.	28/10/2015	Stage 2
251	2118 1	OLD FINGLAS ROAD (NW-EA)	D11	Pedestrian Crossing	at the entrance to St. Mary's School.	29/10/2015	Stage 2
252	2121 9	CLAREMONT COURT (NW-EA)	D11	Double Yellow Lines	at the entrance to Claremont Court.	02/11/2015	Stage 2
253	2125 0	RATOATH ROAD (NW-EA)	D7	Pedestrian Crossing	outside Colaiste Mhuire.	03/11/2015	Stage 2
254	2773 6	COULTRY ROAD (NW-EA)	D11	Zebra Crossing	at Gael Scoil Ballymun.	17/11/2015	Stage 2
255	2773 7	DRUMCONDRA ROAD UPPER (NW-EA)	D1		on Drumcondra Road Upper at the junction with The Village.	17/11/2015	Stage 2

Item	Ref	Road	Post-code	Topic	Request Description	Date Rec'd	SR Status
		EA)					
256	2773 8	FINGLAS PARK (NW- EA)	D11	Traffic Calming	on the road.	17/11/2015	Stage 2
257	2773 9	WOODHAZEL CLOSE (NW- EA)	D11	Traffic Calming	at the junction of Woodhazel Close and WoodhazelWay.	17/11/2015	Stage 2
258	2774 0	YELLOW ROAD (NW- EA)	D9	Stop Sign	on Yellow Road at the junction with The Thatch Road.	17/11/2015	Stage 2
259	2774 1	SANTRY AVENUE (NW-EA)	D9	Traffic Lights	at the junction of Santry Avenue and Forrestwood Estate.	17/11/2015	Stage 2
260	2774 4	RATOATH ROAD (NW- EA)	D7	Pedestrian Crossing	on Ratoath Road at the Scoil.	17/11/2015	Stage 2
261	2774 8	GLASAREE ROAD (NW- EA)	D11	Children Crossing Sign	Requesting 'Children at Play sign' be erected on Glasaree Road	09/11/2015	Stage 2
262	2775 4	BELCLARE AVENUE (NW-EA)	D11	Traffic Calming	at No. 13.	10/11/2015	Stage 2
263	2776 1	CREMORE DRIVE (NW- EA)	D11	Caution Children Sign	Request for Caution children crossing sign on above road	11/11/2015	Stage 2
264	2778 0	PROSPECT WAY (NW- EA)	D9	Bus Lane	Relocate the Bus Lane to the middle lane.	10/11/2015	Stage 2
265	2780 3	IONA ROAD (NW-EA)	D9	Disabled Parking Bay (Residentia l)	outside No. 78. Pay and Display and Permit Parking will have to be rescinded.	16/11/2015	Stage 4
266	2782 5	RIVER ROAD (NW-EA)	D15	Double Yellow Lines	on the bend.	12/11/2015	Stage 2
267	2786 4	GROVE WOOD (NW- EA)	D11	Speed Ramps	on the road.	17/11/2015	Stage 2
268	2786 6	DRUMCLIFFE ROAD (NW- EA)	D7	Caution Children Sign	Request for Children Crossing sign at Drumcliffe swale	13/11/2015	Stage 2
269	2787 5	RATOATH ROAD (NW- EA)	D11	Zebra Crossing	at Colaiste Mhuire.	16/11/2015	Stage 2
270	2797 9	BOTANIC ROAD NW- EA)	D9	Yellow Box (Extend)	To include the bus lane at the junction of Lindsay Road.	18/11/2015	Stage 2

Item	Ref	Road	Post-code	Topic	Request Description	Date Rec'd	SR Status
271	28005	PROSPECT ROAD (NW-EA)	D9	Yellow Box	on Prospect Road/Finglas Road, having crossed from Lindsay Road.	23/11/2015	Stage 2
272	28007	SHANLISS GROVE (NW-EA)	D11	Children Crossing Sign	at entrance near junction with Shanliss Avenue.	17/11/2015	Stage 2
273	28095	KILSHANE ROAD (NW-EA)	D11	Traffic Calming	at the bend at No. 11.	25/11/2015	Stage 2
274	28133	BOTANIC ROAD NW-EA)	D9	No Right Turn	from Botanic Avenue onto St. Mobhi Road, during evening peak hours.	26/11/2015	Stage 2
275	28152	HOME FARM ROAD (NW-EA)	D9	Loading Bay	outside Homepharm Pharmacy, No. 45a.	24/11/2015	Stage 2
276	28154	HOME FARM ROAD (NW-EA)	D9	Disabled Parking Bay (General)	outside Homepharm Pharmacy, No. 45a.	24/11/2015	Stage 2
277	28158	MCKEE AVENUE (NW-EA)	D11	Double Yellow Lines (Extend)	on either side of the entrance to Heath Square.	26/11/2015	Stage 2
278	28197	CONYNGHAM ROAD (NW-EA)	D8	Pay & Display Parking (Rescind)	along Longmeadow Apartments.	30/11/2015	Stage 2
279	28205	CLAREMONT COURT (NW-EA)	D11	Double Yellow Lines	at the entrance.	27/10/2015	Stage 2
280	28341	LINDSAY GROVE (NW-EA)	D9	Parking Prohibition	at the Prospect Road, end of the road.	17/11/2015	Stage 2
281	28367	GROVE PARK CRESCENT (NW-EA)	D10	Speed Ramps	on the road.	15/12/2015	Stage 2
282	28368	GROVE PARK DRIVE (NW-EA)	D11	Speed Ramps	on the road.	15/12/2015	Stage 2
283	28369	SHANOWEN CRESCENT (NW-EA)	D9	Parking Prohibition	in the cul-de-sac.	15/12/2015	Stage 2
284	28370	GALLAUN ROAD (NW-EA)	D11	Stop Sign	Stop/Yield sign at the back of Poppintree Sports Complex and Gallaun Road.	15/12/2015	Stage 2
285	28372	GLASILAWN AVENUE (NW-EA)	D11	Loading Bay	on the road.	15/12/2015	Stage 2
286	28373	LINDSAY ROAD (NW-	D9	Traffic Calming	outside No. 80.	15/12/2015	Stage 2

Item	Ref	Road	Post-code	Topic	Request Description	Date Rec'd	SR Status
		EA)					
287	2837 4	GLASNEVIN AVENUE (NW-EA)	D9	Continuous White Line	from the junction with Ballymun Road as far as 30/32.	15/12/2015	Stage 2
288	2837 5	LORCAN AVENUE (NW-EA)	D9	Double Yellow Lines	at the junction of Lorcan Avenue and Lorcan Park.	15/12/2015	Stage 2
289	2837 6	LORCAN AVENUE (NW-EA)	D9	Yield Sign	at the junction of Lorcan Avenue and Lorcan Park.	15/12/2015	Stage 2
290	2838 2	KILSHANE ROAD (NW-EA)	D11	Traffic Calming	on the road, adjacent to No. 11.	07/12/2015	Stage 2
291	2839 3	GLASNEVIN HILL (NW-EA)	D9	Pedestrian Crossing	south of the junction with St Mobhi Drive.	24/11/2015	Stage 4
292	2840 9	DRUMCLIFFE ROAD (NW-EA)	D7	Children Crossing Sign	on the road.	15/12/2015	Stage 2
293	2841 4	SYCAMORE PARK (NW-EA)	D11	Double Yellow Lines	between Sycamore Road and first house on left.	15/12/2015	Stage 2
294	2841 8	KINVARA DRIVE (NW-EA)	D7	Speed Ramps	on the road.	07/12/2015	Stage 2
295	2841 9	FINGLAS ROAD (NW-EA)	D11	Pedestrian Crossing	Pedestrian Crossing/improve traffic flow at Finglas Road roundabout and Finglas Village junction.	15/12/2015	Stage 2
296	2845 5	OLD FINGLAS ROAD (NW-EA)	D11	Pedestrian Crossing	at the entrance to St. Mary's Secondary School.	09/12/2015	Stage 2
297	2851 7	GLENTIES PARK (NW-EA)	D11	Pedestrian Crossing	On Glenties Park at Cardiffsbridge Road junction.	15/12/2015	Stage 2
298	2853 4	FINGLAS PARK (NW-EA)	D11	Speed Ramps	on the road.	17/11/2015	Stage 2
299	2863 2	SHANLISS ROAD (NW-EA)	D9	Traffic Calming		11/01/2016	Stage 1
300	2863 3	BALBUTCHE R LANE (NW-EA)	D11	Traffic Calming	from the old Shopping Centre to Poppintree.	11/01/2016	Stage 1
301	2872 9	DALCASSIAN DOWNS (NW-EA)	D11	Double Yellow Lines	and rescindment of Pay and Display and Permit Parking opposite Nos. 11-14.	07/01/2016	Stage 2

Item	Ref	Road	Post-code	Topic	Request Description	Date Rec'd	SR Status
302	2875 2	BOTANIC ROAD NW-EA)	D9	Traffic Lights	To move the traffic lights on Botanic Road to just before the Lindsay Road junction.	18/11/2015	Stage 2
303	2875 3	BOTANIC ROAD NW-EA)	D9	Speed Ramps	on Botanic Road just before the Lindsay Road junction.	18/11/2015	Stage 2
304	2879 3	VALLEY PARK ROAD (NW-EA)	D7	Children Crossing Sign	on the road.	19/01/2016	Stage 2
305	2880 7	DRUMCLIFFE ROAD (NW-EA)	D7	Children Crossing Sign	on the road.	19/01/2016	Stage 2
306	2880 9	ASHINGTON AVENUE (NW-EA)	D7	Pedestrian Crossing	on the road.	19/01/2016	Stage 2
307	2881 5	BLACKHORSE AVENUE (NW-EA)	D7		various as part of Blackhorse Avenue Scheme.	12/01/2016	Stage 2
308	2881 6	DALCASSIAN DOWNS (NW-EA)	D11	Pay & Display & Permit Parking	Request to review the Pay and Display and Permit Parking opposite Nos. 12-14.	11/01/2016	Stage 2
309	2901 6	WOODHAZEL CLOSE (NW-EA)	D9	Parking Prohibition	Parking prohibitions for Woodhazel Close, Ballymun.	16/01/2016	Stage 2
310	2904 9	KEMPTON WAY (NW-EA)	D7	Double Yellow Lines (Extend)	on Kempton Way.	19/01/2016	Stage 2
311	2908 5	BOTANIC AVENUE (NW-EA)	D9	Right Turn Filter Light	from Botanic Avenue onto Saint Mobhi Road.	26/11/2015	Stage 2
312	2916 2	PINE HURST (NW-EA)	D7	Yellow Box	east side of Ratoath Rd, at entrance to Pinehurst Estate.	28/01/2016	Stage 2
313	2927 7	DUNARD AVENUE (NW-EA)	D7	Speed Ramps	Requesting speed ramps be installed on Dunard Avenue coming off Blackhorse Avenue entrance	01/02/2016	Stage 1
314	2928 5	GLENTIES DRIVE (NW-EA)	D11	Children Crossing Sign	"Children-at-play" sign for Glenties Drive.	01/02/2016	Stage 1
315	2930 2	MARLBOROUGH MEWS (NW-EA)	D7	Parking Prohibition	Request for parking prohibition on Marlborough Mews. Cars parked there causing problems for residents of NCR with rear access thru Marlborough Mews.	01/02/2016	Stage 1
316	2932 3	CABRA DRIVE (NW-EA)	D7	Double Yellow Lines	Problem with access to Cabra Drive as cars parking at entrance	02/02/2016	Stage 1

Item	Ref	Road	Post-code	Topic	Request Description	Date Rec'd	SR Status
317	2935 1	RATOATH ROAD (NW-EA)	D7	Yellow Box	Request for yellow box at entrance to Pinehurst Estate	03/02/2016	Stage 1
318	2937 2	DUNARD ROAD (NW-EA)	D7	Double Yellow Lines	DYs for Dunard Rd, close to Tesco's, on the corners heading into the cul-de-sac at Nos. 78 & 50.	04/02/2016	Stage 1
319	2940 2	DUNARD AVENUE (NW-EA)	D7	Speed Ramps	Dunard Avenue, at the Blackhorse avenue entrance.	05/02/2016	Stage 1
320	2944 2	WEST PARK DRIVE (NW-EA)	D11	Parking Prohibition	from junction with Ballygall Road East eastwards for a length of about 7 cars, both sides of street.	09/02/2016	Stage 2

**The Chairman and Members of
North West Area Committee.**

Meeting: 15th March 2016

Item No: 13.

PUBLIC DOMAIN REPORT

North West Area Complaints received via CRM

The CRM is the system used by Dublin City Council Customer Services Centre and all departments to log and track complaints. Please see details below of the number of complaints received/investigated and closed by the North West Area Office from 1st February to 29th February.

<i>Type of Complaint</i>	<i>Count of Incidents</i>
Abandoned Vehicle Inspection	3
Community Cleanups	3
Electoral Poster Complaint	14
FYS: Illegal Dumping	1
Footpath Issues	1
Footpath/Tree Trip	2
Illegal Dumping	94
Manhole	1
Pothole	2
Public Lighting Repairs	5
Repair Existing Road Sign	1
Report Dead Animal	1
Report Graffiti	12
Report Gully Problem	2
Report Litter Offence	4
Sweep Your Street	6
Tree Maintenance	2
Weed Control	1
Total	155

It is important to note that a significant number of additional complaints were also investigated as all area staff pick up complaints when carrying out daily duties but due to lack of resources all complaints are not logged.

Team Dublin Clean Up 2016 Reminder

This event will take place on Saturday 26th March 2016, between 11am and 1pm. There is still time for community/environmental groups to register at www.teamdublincleanup.ie or by phoning 01 222 2222 and selecting a particular street or area that they wish to clean. Dublin County Council Waste Management will provide cleaning equipment to all groups and will arrange for litter to be collected afterwards.

National Spring Clean Up

April is the month for the National Spring Clean, when community/environmental groups are asked to participate in clean ups in their own area. Over 5,000 events were held nationwide in 2015, collecting over 5000 tonnes of litter.

Groups register online at www.nationalspringclean.org or at 01 4002219 and receive clean up kits and information. We will contact residents associations and environmental groups in the area with a view to maximising participation within the area and will make arrangements for the collection of litter.

For further information in Finglas/Cabra/Navan Road area phone 222 5412/6754, for Ballymun/Drumcondra/Whitehall phone 2225715.

Enforcement

Targeted enforcement action is continuing in selected residential locations within the area. Residents are initially informed of the requirement that they as a holder of waste must have their waste collected by an approved collector or disposed of at an approved facility. Surveys are then conducted to identify households who may not be in compliance. Authorised Officers will then call to households to check for compliance, issue warning letters to give householders an opportunity to put a waste collection system in place and then if necessary fines for breaches of the bye-laws will be issued.

Lane Enhancements

Enhancement/cleanup works have been conducted in a number of laneways in the North West Area. Fergal's Lane, off Wellmount Road, which is heavily used by children travelling to and from local schools, has been cleaned, had its walls and utility boxes repainted and bushes cut back. It will be monitored in the coming weeks and graffiti painted over as required. Annamore Lane has been cleaned, had bushes cut back and bollards repositioned to enhance vehicular access for cleaning. Work is also due to commence shortly on further restricting vehicular access to prevent fly tipping in the lane at Cabra Park.

Improvements in Drumcondra

Dublin City Council Contractors have recently completed a deep cleaning of Drumcondra Bridge. This bridge is especially prone to discoloration from exhaust fumes generated by the high level of passing vehicular traffic. Works to replace the four seats on the outbound side of Drumcondra Road Upper, opposite the Cat and Cage pub are due to commence shortly.

Anti Graffiti Measures

Extensive work has been conducted around the area to combat the ever present problem of graffiti. A large amount of graffiti has been removed from around the Ballymun Shopping Centre and along the Swords Road near the Omni Shopping Centre. Wall painting was also undertaken on the Tolka Valley Road, which has both enhanced the location and aided the future removal of tagging as it occurs. It should be noted that some locations within the area are especially prone to graffiti and a considerable level of resources are dedicated to combating this problem.

John Twamley
PUBLIC DOMAIN OFFICER
NORTH WEST AREA

**The Chairman and Members of
North West Area Committee Meeting:**

Item No: 15th March 2016

Item No: 14

Sports and Wellbeing Partnership Report

- **Gold Boxing Programme:** This programme is with Our Lady of Victories Ballymun, St. Canice's Finglas and St. Josephs Poppintree. Gold boxing sessions are also commencing for Transition Year students at Scoil Eoin Finglas, Trinity Comp Ballymun and Scoil Chiarain's in Glasnevin. Bronze Boxing sessions are continuing in Ballymun Youthreach. The Startbox programme will commence on Wednesday 6th April in Christ the King Boys National School.
- **Cricket:** We are in the process of developing a new club in Poppintree. The aim is to have it up and running for Summer 2016.
- **Mid Term Easter Activity Camp:** will take place in Poppintree Sports Centre, Trinity Sports pitches Santry, Aquatic Centre, Jump Zone Santry and Trinity Comprehensive Sports between 15th and 30th March.
- **Pop up Rugby:** every Monday from 5 – 6pm at Poppintree Sports Centre and on Thursday from 4 – 5pm in Trinity Sports Grounds Santry, in partnership with Leinster Rugby.
- **Boxing Classes:** every Wednesday from 11am – 12pm at Poppintree Sports Centre in partnership with Ballymun Education Support Training.
- **Under 10's Activity Programme:** at Poppintree Sports Centre on Wednesdays and Thursdays from 3 – 4pm in partnership BRYSR.
- **Comhairle na nÓg:** As part of the programme each year, members are brought on a personal and team development programme to Carlingford Adventure Centre during the Easter holidays (29th & 30th March). The purpose of the trip is to help members develop effective working relationships and further develop the skills of cooperation, communication and team building. Carlingford Adventure Centre offers a range of fun and challenging activities designed specifically to encourage a team to take risks, build trust and communicate with each other. Participating in team building activities further develops the member's communication skills, problem solving skills and builds trust within the group. Maz Reilly DCC Sports Officer, will be attending this programme thereby continuing her work with Comhairle na nÓg.
- **Easter Activities:** A diverse range of fun, friendly and active sports sessions will be organised for young people in the Cabra area during the Easter Holidays this year.

Activities will include bubble football, soccer, dodgeball, cricket, basketball, badminton, golf, and kayaking. For further information on activities please contact Maz Reilly, Dublin City Council Sports Officer for more details.

- **Soccer Coaching:** sessions take place on Tuesday mornings from 9 – 11am in Virgin Mary Girls School Ballymun, 10.45am – 12.30pm in Trinity Comprehensive School Ballymun and 8.50am to 12pm in St Kevins College Ballygall Road.
- **Soccer Coach Education:** FAI Youth Certificate at Ballymun United FC from Tuesday 29th March to Friday 1st April.
- **Child Welfare Workshop:** taking place at Leisure Point Finglas on Monday 4th April.
- **Soccer Sisters Easter Camp:** Taking place on 22nd, 23rd and 24th March from 10am – 1pm at Trinity College Sports Grounds, Santry Lane, Ballymun.
- **Late Night League:** The finals will take place in Irishtown Stadium on Friday 8th April, time TBC.

Contact details

Niamh Redmond, Communications Officer: niamh.redmond@dublincity.ie

Maz Reilly, Sports Officer: marielouise.reilly@dublincity.ie

Niall Mc Donald, Sports Officer: niall.mcdonald@dublincity.ie

John McDonald, Sports Officer: john.mcdonald@dublincity.ie

Eileen Gleeson, Sports Officer: eileenb.gleeson@dublincity.ie

Jamie Wilson, FAI Soccer: jamie.wilson@fai.ie

Paul Whelan, FAI Soccer: paul.whelan@fai.ie

Oisín Fagan, Boxing: oisinfagan@gmail.com

Fintan McAllister, Cricket: fintan.mcallister@cricketleinster.ie

Stephen Maher, Rugby: stephen.maher@leinsterrugby.ie

Report by

Niamh Redmond
Communications Officer
Dublin City Sport & Wellbeing Partnership

**To the Chairman and Members of
The North West Area Committee**

Meeting: 15th March 2016

Item No: 15

Current motions submitted to City Council from the North West Area

Ref	Motion	Area Committee Date	Comment
NW/230/15	<p><u>Motion in the name of Councillor Anthony Connaghan</u></p> <p>That the Manager arranges for a full review of litter bins in the Northwest Area. Can the Manager arrange for bins which were removed in recent times to be replaced. There is an large amount of dog dirt being bagged and dropped around the place which might be avoided if bins were in place to put the bags into.</p> <p>ORDER: Report to Councillor. It was agreed to forward this motion to the City Council.</p>	September 2015	Motion dealt with under the Environment Strategic Policy Committee. (December 2015). It will be removed from City Council Agenda.
NWA/301/15	<p><u>Motion in the name of Councillor Teresa Keegan</u></p> <p>That the Manager arrange immediate briefing session for residents in respect of the proposed modular housing developments in both Finglas and Ballymun in order to address concerns.</p> <p>ORDER: Motion to be submitted to the City Council. Chair to seek</p>	November 2015	Both of these motions will be responded to at the Special Area Committee Meeting of the North West Area Committee.

	<p>responses from the Housing & Residential Department on issues previously raised by the Councillors at a briefing given by the Assistant Chief Executive of Housing & Residential Services. Briefings will be held for Councillors and residents when designs for the proposed modular housing development are available.</p>		
NWA/15/16	<p><u>Motion in the name of Councillor David Costello</u></p> <p>That this committee supports the introduction of long term social and affordable housing as part of mixed tenure development and requests that the principals of social mix is adhered to in the North West Area.</p> <p>The principal and evidence is outlined out in the NESC report Paper No.8 July 2015.</p> <p>ORDER: Recommend to City Council</p>	January 2016	

Current Practice: Priority of motions is determined by date of adoption at North West Area Committee Meetings.

Aidan Maher
Assistant Area Manager

**The Chairman and Members of
North West Area Committee.**

Meeting: 15th February 2016

Item No: 16

BALLYMUN LOCAL AREA PLAN

THE CHIEF EXECUTIVE'S REPORT ON THE SUBMISSIONS RECEIVED FOR THE PRE DRAFT PUBLIC CONSULTATION ISSUES PAPER

Contents:

1.0 Introduction

- 1.1 The Role of the Issues Paper
- 1.2 Public Consultation on the Issues Paper

2.0 Submissions Received

- 2.1 List of Submissions Received
- 2.2 Summary of Issues Raised by Elected Members
- 2.3 Summary of Issues Raised by Prescribed Bodies / State Agencies
- 2.4 Civic Alliance
- 2.5 Summary of Key Issues Raised by Members of the Public / Interested Parties, by Theme

3.0 Conclusion and Chief Executive's Recommendations

Appendix 1: Ballymun LAP Area - Draft

1.0 INTRODUCTION

Dublin City Council (DCC) is preparing a Local Area Plan (LAP) for Ballymun. The preparation of an LAP is identified as an objective of the current Dublin City Development Plan 2011-2017.

The proposed plan area covers an area of approx. 270 hectares (see Appendix no. 1). On the eastern side of Ballymun Road, the boundary is set by Santry Avenue to the north and by the residential estates of Shanliss and Oldtown to the east and south. On the western side of Ballymun Road, the area is bounded by the realigned St. Margaret's Road to the north, Jamestown Road to the west and the residential estates of Oakwood, Cedarwood, Pinewood and Willow Park to the south. Both the northern and western boundary corresponds with the administrative boundary between Dublin City Council and Fingal County Council.

In 1997 a government decision was made to regenerate the area of Ballymun. Dublin City Council set up Ballymun Regeneration Limited (BRL) to oversee and implement the regeneration process. The Ballymun Masterplan was produced in 1998 following consultation with the local community, and over the next 17 years BRL successfully implemented the key objectives of this plan which sought to enhance the economic, social, environmental and physical character of Ballymun. With the winding down of Ballymun Regeneration Limited and the transfer of its functions and responsibilities to Dublin City Council it is timely that a new plan for Ballymun is prepared which will build on the successes of the Masterplan and address its future challenges. The preparation of the Local Area Plan will safeguard the significant investment made in the area to date and ensure the regeneration is brought to a successful conclusion.

The LAP will review the progress made in implementing the aims and objectives of the Ballymun Masterplan, and provide an updated strategy for the future development and management of the area to meet the needs of the existing and future population.

1.1 The Role of the Issues Paper

An important step in making a Local Area Plan is to identify the issues for the local area from the point of view of local residents, business people, land owners, state bodies operating services in the area, and other interested stakeholders.

To assist this process, Dublin City Council called for submissions on matters which the plan should address and prepared an Issues Paper document to assist and encourage such submissions. This process ensures that important and informed local issues identified from a

wide variety of sources are identified at an early stage to help the preparation of the draft plan.

1.2 Public Consultation on the Issues Paper

A presentation was given to the North West Area Committee (NWAC) on the 16th June 2015, regarding the stages involved in making a Local Area Plan, the proposed process for pre-draft public consultation, and important items to be included in the published Issues Paper were discussed.

The Issues Paper (i.e. pre-draft local area plan) public consultation was launched on the 5th November 2015 with the publication of a public notice and the Issues Paper document. A display was provided in the Civic Offices in Wood Quay and at the Civic Offices, Main Street, Ballymun. The NWAC Councillors were circulated with a copy of the Issues Paper and the statutory notice. The Ballymun Civic Alliance (see section 2.4) and a range of pertinent stakeholders including social and community groups, schools, businesses and sport clubs were notified (with assistance from the Ballymun and Finglas Area offices). The Issues Paper and details on how to make a submission were posted on the Dublin City Council website. Use was also made of the DCC social media accounts (facebook and twitter) to help to notify members of the public. Posters on the consultation process were erected in eleven locations throughout Ballymun, including AXIS, Ballymun Library, Poppintree Sports and Community Centre and also the local shops and community buildings. Members of the Planning Department were available locally in the area to assist with any queries on the following public consultation dates: -

1. Friday 6th November: 10am - 1pm
2. Thursday 12th November: 1pm - 4pm
3. Saturday 21st November: 10am – 12pm
4. Thursday 26th November: 7pm - 9pm

23 people signed the attendance sheets over the four periods.

A total of four weeks (from Thursday 5th November 2015 to Thursday 3rd December 2015) was allowed for making submissions.

2.0 SUBMISSIONS RECEIVED

A total of 29 submissions were received by Dublin City Council during the consultation period. The purpose of this report is to briefly summarise these submissions and present the Chief Executive's recommendation. Those issues raised by elected members and prescribed bodies are summarised individually while all other submissions are summarised under the various themes which emerged.

2.1 List of Submissions Received

Below is the list submissions received from councillors, local residents, residents groups, agents and state bodies etc. listed in the order received.

Table 1: List of Submissions

ID	Title	First Name	Last Name	Organisation / Individual
1	Mr.	Robert	McMahon	Ballymun resident
2	Ms.	Tracy	Smith	Unnamed
3	Mr.	Sean	Tyrell	Ballymun resident
4	Cllr	Noeleen	Reilly	Councillor for Ballymun and Ballymun resident
5	Ms.	Karen	O'Driscoll	Ballymun resident
6	Mr.	Roger	Warburton	Rediscovery Centre
7	Mr.	John	Herbert	Ballymun resident
8	Mr.	Desmond	Malley	Ballymun / Santry resident
9		Unnamed	Unnamed	Unsigned - Ballymun resident
10	Mr.	Peter	Byrne	Fingal County Council
11	Mr.	David	Mangan	Sandyhill Shangan Football Club
12	Ms.	Patricia	O'Leary	Department of Arts, Heritage and the Gaeltacht
13	S.J.	Kevin	O'Higgins	Jesuit University Support and Training, Ballymun (J.U.S.T)
14		Ballymun	Tidy Towns	Ballymun Tidy Towns
15	Ms.	Suzanne	Dempsey	Irish Water
16		Unnamed	Unnamed	Willows Football Club
17	Mr.	Niall	O'Byrne	New Generation Homes

18	Mr.	Noel	Breslin	3 Bridges Boxing Club
19	Cllr.	Andrew	Montague	Councillor for Ballymun and Ballymun resident
20	Mr.	Mark	O'Brien	AXIS Ballymun
21	Ms.	Fiona	Descoteaux	Innovate Dublin
22	Mr.	John	Dunne	Ballymun Job Centre Co-op Society Limited (BJC)
23	Ms.	Aideen	O'Hora	The Green Way
24	Mr.	Jimmy	Dignam	Workers' Party Dublin North West Representative
25	Mr.	Cian	O'Mahony	Environmental Protection Agency
26	Mr.	David	Clements	National Transport Authority
27	Mr.	Binesh	Tholath	Santry Cross Management Company Ltd. Representing Santry Cross Apartments
28	Mr.	Liam	Barry	Economic Sub-Committee, Ballymun Civic Alliance
29		Unnamed	Unnamed	Unsigned

2.2 Summary of Issues Raised by Elected Members

A number of issues were raised by the elected representatives, noted below.

Cllr. Noeleen Reilly (Submission 4)

- Concern regarding unfinished regeneration process

Economic Development & Employment

- Ballymun Shopping Centre, old Garda station and Health Centre need to be demolished
- Development of Balcurris site for retail and office space to provide a low cost supermarket
- Provision of additional shops for clothing, footwear, hardware, café etc. and limit the number of existing businesses
- Resolution of legal disputes of vacant commercial units and leasing of these units
- Review of the rents of the Dublin City Council properties
- Improvement of car parking facilities at shopping centre in the short-term
- Develop M50 lands as industrial cluster, with greater co-operation between DCC and FCC

- Training for unemployed
- Improve maintenance of vacant land

Housing and Tenure Diversity

- All private housing developments should have an element of social housing
- Issue of tenure diversity should be addressed through job creation
- Rent Allowance ban should be lifted - no impact on existing tenure diversity
- Portion of available land in Shangan should be utilised for one bedroom senior citizen housing to facilitate downsizing
- Additional student housing

Social, Community, Recreation and Cultural Development

- Provision of additional playing fields
- Relocation of Ballymun Kickhams into the heart of Ballymun – Balbutcher Lane flats cited as a possible location
- Transfer of land around Setanta GAA to the club
- Improve security for Poppintree Park

Infrastructure and Movement

- Completion of Hampton Wood link road

Cllr. Andrew Montague (Submission 19)

- Sets out a vision for the area. Highlights the positives and achievements, and the failures and concerns of the area.

Economic Development & Employment

- Focus development on Main Street and M50 lands
- Address shortcomings of the Poppintree industrial estate - rezone to residential or mixed-use
- Provision of jobs that match the skill sets of the unemployed
- Missing services in the area include restaurants, cafes, pubs, bookshops, supermarket, hardware, dry cleaning etc.

Housing and Tenure Diversity

- Additional senior citizen, co-operative and student housing
- Provide different houses sizes and types
- No change to the rent supplement policies
- Family friendly home zones - car parking is kept separate from the residential streets
- Provision of purpose built rental accommodation where the developer builds and maintains the accommodation

Infrastructure and Movement

- Connect Shangan Rd to slip road at the back of the Civic Centre
- Reduce speeds and car domination on Main Street – segregated bike lanes, narrowing of carriageways for cars
- Bus service improvements: No. 4 should extend to the airport; No. 17A should extend to the DART in the east; More direct link to Blanchardstown SC
- Dublinbike stations on Main Street and in each of the neighbourhood centres
- Segregated bike lane provision on Ballymun Rd, Santry Avenue, Balbutcher Lane, Balbutcher Lane North, Sillogue Rd, Shangan Rd
- New cycle route along Santry River to Saint Anne's Park which connects into Ballymun through Santry Woods

Design, Public Realm and Environmental Improvements

- Ensure new developments 'design out' anti-social behaviour (e.g. overlook public spaces or re-imagine vacant land/spaces for community gardens etc)
- Upgrade plaza
- Improve public realm in the courts
- Universal access in all new buildings
- Taller buildings and higher densities along Main Street
- Plant more trees
- Improve Balcurris Park, Shangan Park, Whiteacre Park
- Examine the land and use of the spaces at: -

(a) Educational Training Board (ETB), Main Street

(b) Virgin Mary NS and St. Joseph's NS

(c) St. Margaret's Halting Site

2.3 Summary of Issues Raised by Prescribed Bodies / State Agencies

(a) Fingal County Council (Submission no. 10)

- Fingal County Council (FCC) and Dublin City Council (DCC) should agree clear objectives for the development of the DCC owned lands (located within the administrative boundary of FCC).
- When a clear planning strategy is in place for Ballymun (lands both within DCC and FCC), FCC and DCC might consider a joint initiative to attract economic development in Ballymun.
- Planning strategy for Ballymun should aim to optimise the relationship of future development with new Metro North and to maximise the benefits of having a high capacity public transport system running through the area.

(b) Department of Arts, Heritage and the Gaeltacht (Submission no. 12)

- LAP should comply with the new Dublin City Development Plan 2016-2022.
- LAP is adjacent to Santry Demesne, a proposed Natural Heritage Area; bats may be an issue and should be considered in the LAP.
- LAP is adjacent to the Santry River and its role as an ecological corridor as envisaged under Article 10 of the Habitats Directive should be maintained and enhanced.
- Additional guidance provided in relation to nature conservation and the making of the LAP.

(c) Irish Water (Submission no. 15)

- Irish Water is currently carrying out a Drainage Area Plan for the Sutton Pump Station which will include the North Fringe Sewer (NFS) and the North Dublin Drainage Sewer (NDDS).
- Irish Water are preparing to carry out investigate surveys and drainage models that will take account of the future development requirements in Ballymun.

(d) Environmental Protection Agency (Submission no. 25)

- 'Integration of Environmental Consideration' document provided to be taken into account in the preparation of the Strategic Environmental Assessment and the Draft Local Area Plan.

(e) National Transport Authority (Submission no. 26)

- 'Draft Transport Strategy for the Greater Dublin Area 2016-2035' (published October 2015) includes a proposal for a light rail line from St. Stephen's Green to Swords, via Dublin Airport and Ballymun, known as the new Metro North.
- The new Metro North will require a new route options assessment exercise and the preparation of a new planning application.
- Clarity on the new Metro North in terms of alignment, station locations and construction type (underground, at grade or elevated sections) will emerge in late 2016.
- Taking this into account, the practical approach may be to align the LAP and the new Metro North preliminary design work as closely as possible, and the Draft LAP is finalised once the preliminary design drawings are available for the section within the Ballymun LAP lands.

2.4 Ballymun Civic Alliance

Ballymun Regeneration Limited (BRL) has wound down and all of the roles and responsibilities of the regeneration company are transferred into Dublin City Council. The Ballymun Civic Alliance was set up to assist this process and ensure that the aims of the Ballymun Masterplan were pursued locally. The Civic Alliance comprises Elected Members, local authority representatives, pertinent stakeholders and local people. There is an overall Board with three thematically focused sub-committees: -

1. Economic
2. Social
3. Physical

Updates are provided by the Planning Department at each of the Physical Sub-Committee meetings, which take place every eight weeks, regarding the preparation of the LAP and also on the Retail Study (A separate retail study is being carried out by consultants on behalf

of Dublin City Council to accurately measure and evaluate the retail market in Ballymun. This information will assist the preparation of the LAP and will be included as an appendix to the LAP). A planning update was also provided to the overall Civic Alliance, which take place approximately once a quarter, on the 1st October 2015 and the 28th January 2016.

The Economic Sub-Committee provided a submission on the Issues Paper and the main points are as follows: -

- Ballymun is a low income community with limited disposable income. Aims for improving the area are as follows: -
 - (a) increase the level of income by creating employment opportunities
 - (b) increase the overall population
 - (c) improve the tenure diversity
 - (d) improve educational standards
- Achieve the above by attracting private investment into the area and/or developing Ballymun as a destination (e.g. building on existing initiatives such as the Rediscovery Centre – greenway cluster and AXIS)
- The LAP can stimulate development of the vacant sites by clearly identifying the land uses.
- Consideration should be given to the City Council's role in: -
 - (a) Becoming a developer of the remaining sites as opposed to relying on the private sector – this could be a innovate and bold move, and
 - (b) Making the vacant sites more saleable
- Creation of a focal point in the heart of Ballymun to attract passing trade and visitors. Improve the physical attributes of the Plaza and redevelop the shopping centre site to create a vibrant village streetscape along Main Street
- M50 lands should be utilised for employment generating uses for large commercial activities. Residential uses should be closer to the town centre
- Resolution of the ongoing legal issues of the unoccupied retail space and incentivise their occupancy (e.g. voucher towards marketing, fit out the unit etc)
- Establishment of an enterprise park incorporating food-start up space
- Further develop links with DCU and provide start-up space for enterprise

- Production of a marketing brochure of the comparative advantages of locating in Ballymun and circulation to IDA etc. Additional marketing and branding can be achieved once free WIFI is available on the plaza.
- Missing services/businesses include food, clothing, retail, cafes and restaurants
- Co-op housing to help retain local people in the area who have a viable option of purchasing

2.5 Summary of Key Issues Raised by Members of the Public / Interested Parties, by Theme

Having reviewed all of the submissions, a number of key themes were identified as matters to be considered in the preparation of the Draft Local Area Plan. The themes closely follow the issues and matters identified in the Issues Paper and reflect a good understanding of the matters to be addressed.

2.5.1 Vision for Ballymun

2.5.2 Economic Development and Employment

2.5.3 Housing and Tenure Diversity

2.5.4 Infrastructure and Movement

2.5.5 Social, Community, Recreation and Cultural Development

2.5.6 Public Realm and Environmental Improvements

2.5.7 Key Sites

2.5.8 Implementation of the LAP

2.5.1 Vision for Ballymun

Having regard to the submissions received there is a desire to: -

1. Improve the image of the area
2. Create a centre / heart / focal point / CBD in Ballymun
3. Provide local employment

The disappointment regarding the lack of development on the shopping centre lands and the poor retail offering was clearly conveyed in the submissions. Demolishing the shopping centre and the adjoining buildings is seen as one of the priority projects for the area and developing a proper Main Street.

Additional measures are needed to tackle anti-social behaviour, especially for young people. Education and employment are viewed as two key drivers in addressing this issue and achieving successful social regeneration.

2.5.2 Economic Development and Employment

There is a desire to see economic development in the area. The main focus for development is identified as being on the shopping centre site and M50 lands. These sites are highlighted as being the hub locations for local employment.

The submissions were extremely strong on the need for local employment and economic activity in the area to: -

- (a) Improve the image of the area
- (b) Improve the business atmosphere
- (c) To reduce anti-social behaviour

The strategic location and the local authority ownership of the land were noted as being advantageous in a number of submissions. The LAP should consider opportunities for the local authority to retain ownership of the land and to develop the land in tandem with state agencies to provide employment. There is a desire for the LAP to support collaboration between agencies to provide locally based employment initiatives and longer-term strategies to improve the skill levels and assist local communities in accessing future labour markets.

In terms of the green economy, a submission from The Green Way proposed the generation of renewable energy on a commercial sale (solar or wind) within some of the sites in Ballymun, namely the M50 lands. This provision could be examined at the Development Plan level or within the confines of the LAP providing site specific objectives. Innovate Dublin recommended that Ballymun become a test bed for innovation and provide more flexible and competitively priced space for the location of start-ups. 'Destination Ballymun', one of previous aim's of the Ballymun Masterplan was reiterated as a means of attracting investment and reducing the dependency on local authority supports.

The level of vacancy in commercial properties was noted. Requests were made to address the legal matters precluding the use of some of the vacant units and activating these units for innovative uses, start-ups, advertise local events, and local social / community uses. More favourable rental or lease agreements were cited as possible means of improving the occupancy of these units. There was also a recommendation to penalise the owners of the units that are left vacant.

The development of a new shopping centre is identified in numerous submissions as a requirement for the area. The submissions identify that additional retail (supermarket and clothes shops), cafes; restaurants; public houses are required in the area. In terms of the provision of complementary leisure uses, one of the submission notes that the leisure element (i.e. cinema and bowling) is provided in two adjoining centres – Omni and Charlestown, and as such is not required in the area. Furthermore the provision of the shopping centre should be integrated with the provision of additional office space providing local employment (emphasising the desire for local employment).

2.5.3 Housing and Tenure Diversity

Submissions on housing stressed the need to provide additional housing in the area, with student, private and social housing required. More mixed housing options, innovative housing ownership models such as co-operatives and new housing finance models supporting home ownership and local people who have the economic capacity to live in the area were highlighted in a number of submissions.

Tenure Diversity was stated as a means of assisting local business and new residential developments. The Santry Cross Managed Company highlighted again the strategic location of Ballymun as an advantage of attracting residential development and improving tenure diversity.

New Generation Homes suggested that some of the western lands of the Poppintree Industrial site; i.e. the former 'Mouldpro' site is considered for redevelopment (i.e. housing

and health/community uses) and that the employment/enterprise generating land use is unnecessarily restrictive.

In relation to the existing housing stock, requests were made to generally improve the maintenance of the existing housing stock including improvements to the existing 1960's housing of Sandyhill and Shangan.

2.5.4 Infrastructure and Movement

Metro North

Submissions welcome the new Metro North proposal and request that the Metro is fully integrated into the heart of Ballymun fully servicing the area. The Worker's Party Dublin North West would like the metro to be located at surface and a park and ride.

Bus

A request was made by the Worker's Party Dublin North West not to privatise the bus networks.

Movement

A submission was received to improve transport links between the City and Fingal County. A separate submission specially highlights the creation of a link from Ballymun into Santry Demesne (i.e. within the administrative area of FCC).

2.5.5 Social, Community, Recreation and Cultural Development

Social and Community

The submissions stressed the importance of education as a key element of social regeneration, while simultaneously addressing/assisting employment prospects and economic development. J.U.S.T considers that a visible and centrally located education/lifelong learning facility would assist this process and make a major contribution to the area.

Funding is required to support the local social and community sectors. The LAP should ring-fence the monies obtained from land sales for social regeneration, in a similar fashion to the model utilised by BRL.

New Generation Homes called for additional health/community and leisure facilities specifically within the Jamestown area and on the former 'Mouldpro' site in Poppintree industrial estate.

Recreation

The provision of additional community facilities for young people should be provided for by the Local Area Plan. Further playing pitches were also requested, based on the census figures and the level of social housing in the area. Options which were presented include the land at Naul Park; the former Balcurris flat sites (i.e. the last flat block demolition) and the provision of an all-weather pitch(es) in the Shangan area. Willows Football Club requested the use of the site adjoining their club house on Jamestown Road and 3 Bridges Boxing Club requested a club premises, as they are currently based in Virgin Mary School. One submission called for the inclusion of outdoor sports equipment in the local parks, as provided in Malahide Park and along Clontarf strand.

Cultural Development

AXIS provided a detailed submission on how the LAP can promote culture and tourism in the area. There is a desire to brand Ballymun as a hub for cultural, arts and innovation with AXIS becoming the lead agent and the resource for the north side of the city. This idea is explored further with potential ideas of creating a cultural corridor on the north side with AXIS and Rediscovery Centre, linking into Grangegorman, Parnell Square and out to the Docklands; or the idea of twinning Ballymun and Docklands together as the two main access points into the city – i.e. the port and the airport.

2.5.6 Public Realm and Environmental Improvements

A number of the submissions received would like to see the retention and improvement of the space in front of AXIS as a cultural, performance and external café space. To assist this, improved signage and architectural treatment would be required. The potential of linking this into a smaller space on the opposite side of the road was also promoted.

The provision of a local collection point for bulky goods (i.e. goods that don't fit into the black bins) which is tied into a local environmental initiative was recommended.

2.5.7 Key Sites

The shopping centre and the M50 lands are seen as key sites in the area. One of the submissions suggested the exploration of 'meanwhile' uses for the Shopping Centre site that includes and involves the community.

In relation to future of the key sites, Innovate Dublin recommends the establishment of a participatory consultation process inviting non-traditional stakeholders into the process.

2.5.8 Implementation of the LAP

With regards to the implementation of the LAP one submission states that there should be more involvement of local people in the social/economic/political development and establishment of a Ballymun "Central Committee".

3.0 CONCLUSION AND CHIEF EXECUTIVE'S RECOMMENDATIONS

All submissions received have been reviewed and all the comments received will be taken into consideration in the preparation of the Draft Local Area Plan.

The comments received and key themes identified will be important in the preparation of the Draft Local Area Plan and in particular will be considered in the formulation of policy in several areas including: -

- Strengthening the economic role of the area
- Improving retail provision
- Fostering and strengthening the public transport provision in the area
- High quality urban design implementation
- Community/cultural/recreational focal points
- Prioritising remaining projects for the area and progressing remaining demolitions
- Reviewing housing models and options for the area
- Improving the public realm

It should be noted that receipt and analysis of these submissions forms one important part of the overall pre-draft preparation stages. The Local Area Plan team will continue to consult and meet with all relevant stakeholders and state bodies up to the publication of a Draft Local Area Plan.

These meetings will seek to achieve a balance and consensus in progressing policies and action on the issues raised during the Issues Paper consultation, and having regard to the proper planning and sustainable development of the area.

The proposed Draft Local Area Plan will be presented to the Area Committee prior to its official display. This is envisaged to be later in 2016, having regard to the preparatory work yet to be undertaken, and the submission received by the National Transport Authority.

Chief Executive's Recommendations:

It is recommended to the Council that

- a) The LAP proceed to draft stage, based on the existing LAP boundary (see Appendix 1) and taking on board the comments and submissions received during the public consultation stage, as summarised above, and
- b) The Draft LAP is prepared in compliance with EU directives including Strategic Environmental Assessment, Appropriate Assessment and Flood Risk Assessment processes, legislation and the Dublin City Development Plan.

Jim Keogan

A/Assistant City Manager

Appendix 1

Ballymun LAP Area – Draft (as per the Issues Paper)

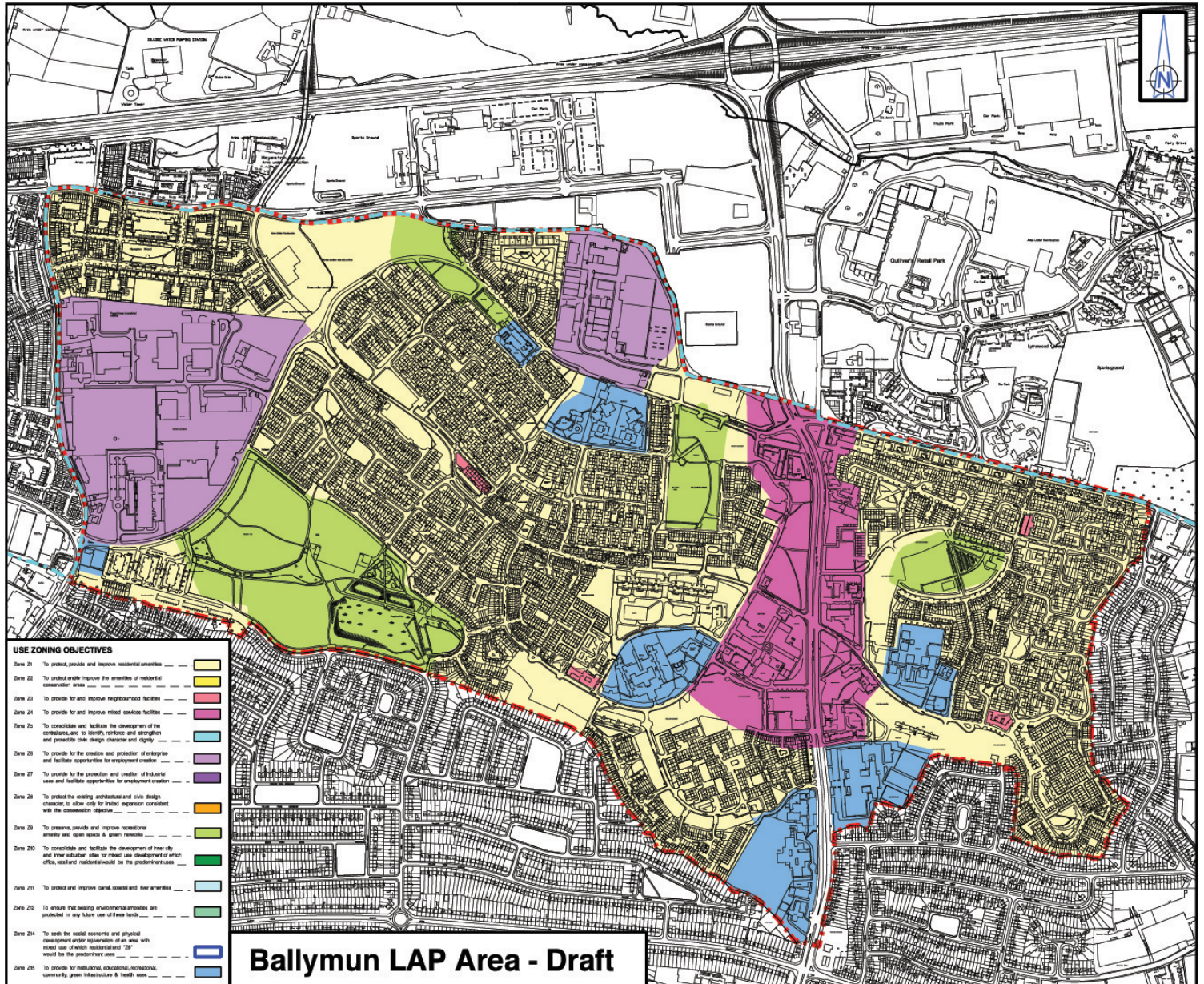

**The Chairman and Members of
North West Area Committee.**

Meeting: 15th March 2016

Item No: 17

Ballymun Area Office Report March 2016

- 1. Community Update**
- 2. Housing/Estate Management**
- 3. Ballymun Town Civic Alliance**
- 4. Safer Tallyman Drumcondra Glasnevin**
- 5. Other Significant Updates**

1. Community Update

The New Community Development Team has met with a number of community groups in relation to the following:

1916 Commemoration Events: The Community Development Team has been liaising with all 23 community organisations that received funding through the 1916 fund so as to better support and promote their event where necessary.

Community Garden proposal for Sandyhill Area: The Community Development Team has met with the community garden committee in relation to a proposal that was sent in before Christmas which outlined a plan for upgrading the grassed area in front of Sandyhill Gardens by including community allotments in the area. Since then, a number of site meetings have taken place and commitment has been made by Housing/Public Domain to improve the dumping and footpath situation. A revised plan for upgrading smaller grassed areas in the Sandyhill area is being considered by the group.

Older Persons Dance Project: Two meetings were attended in relation to this joint project by Arts Office, Sports Development and Community Development.

Environmental Initiatives: The team are linking in with the Seven Oaks Environmental Group who is looking to plant small shrubs, and pruning trees to enhance their area.

A team member has been linking with IKEA sustainability officer, around an environmental initiative whereby 50 trees will be donated and planted in the local area. This has been linked to the new residents of Rapid Housing Project for homeless families. It has been agreed that the trees will be planted in the back gardens of each new unit.

Work has also commenced with residents around a planting project in Marewood Crescent.

Rapid Build Housing, Poppintree (22 new Units): Two meetings were attended centrally in relation to the new Rapid Build Housing Units. Subsequent follow up work for the Community Team involved putting together an information booklet for new tenants of the area and a number of visits to the site. The Community Team members will assist the new residents to assimilate into the area by providing ongoing information and invites to community events. They will link closely with dePaul's local outreach staff and various other local services. Liaising with the Sustainability Officer in IKEA has resulted in them committing to providing a welcome pack (with cutlery etc) for new residents.

Summer Project Meetings: Two meetings have taken place with the Crosscare representative from voluntary summer projects in the wider Ballymun Area. There are now five voluntary summer projects: Virgin Mary, Holy Spirit, Greenfields, the Larks and Gaeltacht Park. It has been decided to set up a Network Meeting for these projects so as to provide a space for the exchange of valuable ideas and supports. The first meeting took place on Monday the 7th March. The community team members will meet the non voluntary summer projects on a separate basis. These are: Poppintree Youth Project, Poppintree Sports Centre, Aisling Project and BRYR. There is a possibility that an additional music project will run from Setanta this year. A meeting in relation to this has taken place.

Good Citizen Awards: The community Development Team has been promoting these awards and has emailed all our community groups in relation to this.

Ballymun Festival Steering Committee: Two meetings have already taken place with this group. A Community Team member is chairing the meeting. Meetings are focusing on the

LIFT Festival and Otherworld Festival. Other members include project workers from local youth organisations and Axis Community Arts Officers.

Beo Ballymun: This festival, which focuses on Irish Traditional Music, is jointly organised by Dublin City Council, Axis and Setanta GAA. It takes place in early June. Two meetings about this event have been attended by community team members.

Active Living: This group have their weekly walk on Tuesday mornings from 10.30am-11.30am and have a tea/coffee and chat afterwards in the Axis Centre. They are also learning a new activity this year which is Tai Chi. They will begin their classes next month.

U3A: This group is working on a project for the 1916 rising. They are planning on compiling a booklet from their research on the women in 1916 and will include them in the exhibition taking place the week of the 18th April in the Civic Offices.

Events

Albert College Senior Citizens Complex: The Community Development Team has been working for a number of weeks with the new Liaison Officer to build up the use of the community room in Albert College. To date there has been three weekly coffee/social mornings where staff meet and chat to residents and provide information about very local events and initiatives. There are approximately ten residents at these mornings. A Fair-trade breakfast morning will be held there on Thursday the 3rd March.

Fair-trade Fortnight: Apart from the above event, two more community events will involve a fair-trade talk, which will be provided by the community team members.

Snooker Event: The Community Development Team in conjunction with the Sports Development Officer arranged a snooker event in Cross Guns Snooker Hall and Civic Offices. Approximately 30 men attended the local event which took place on Tuesday the 19th January from 2:30pm-4:30pm.

Trinity Comprehensive 1916 Commemoration Event: The Community Development Team members worked closely with and strongly supported Trinity Comprehensive with a fantastic Commemoration Event which took place on Tuesday the 9th February in the school. At this event four classrooms were totally transformed and people were transported back in time to the pre 1916 era and the events of the Rising. This event was acted out by the young people of the school and all local schools and community organisations were invited to attend. Approximately 400 people attended on the day and it was a huge success.

1916 Event (Ballymun Civic Centre): The Community development Team is planning a big event for Monday April the 18th from 6:30pm. At this event, the 1916 mural by renowned artist Muriel Brant will be unveiled in the Atrium of the Civic Centre and a display of 1916 projects undertaken by local community groups/organisations will be launched. One of the main highlights will be an arts/crafts project whereby a number of local community organisations will design handkerchiefs (similar to those used during the 1916 era to pass on hidden messages) and these will be displayed together. There will also be music and refreshments served. 200 people will be invited. The Lord Mayor will open this event. This event is being jointly organised by Ballymun Community Team and the Arts Office.

Other 1916 Events: A 1916 Café event took place on March the 8th in the Sillogue Neighbourhood Centre, local women were invited to dress up in old style clothes and celebrate Ballymun women of the last 100 years. This was co-organised by Community Team members and the Sillogue Ladies Group.

International Women's Day Event: Apart from the above, a second International Women's Day event will take place at the Shangan Family Centre. This event will display art and other items representing the plight of the Women of the Rising. Community team members have assisted with this event and will also attend.

LIFT: The LIFT Youth Arts Festival this year will take place from the 16th -23rd March. Programme planning and budget planning is ongoing at the moment. Activities will be open to all young people and will take place either in local youth organisations or the Axis Theatre. There will be a strong focus on mental health this year.

Drumcondra/Glasnevin Community Report

1916 Commemoration Events have commenced. ATeam Dublin Clean - Up in Iona, Claremont and Phibsborough is being promoted. Phibsborough Tidy Towns are also having their own Clean-Up, followed by a major musical event in the Library Garden. Also, we are discreetly promoting nominations for the Good Citizen Awards.

Events to watch out for:

City Council Local History Walk 1916 in Phibsborough led by Pat Liddy on Saturday 16th April 11.00 am with complimentary refreshments afterwards.

2. Housing/Estate Management Updates

C.C.T.V

The C.C.T.V system is working well. The system will undergo scheduled PPM in the coming weeks – this work includes checking all of the cameras and updating the monitoring station in the control room.

Cleansing/Waste Management

Waste Management and the Area Office are continuing to combat illegal dumping at open spaces. These measures include using the C.C.T.V system to monitor and identify those responsible. The Area Office has targeted illegal dumping in St Margaret's Road at the Balbutcher Lane junction and around Musgraves. Green spaces opposite St. Joseph's School, Whiteacre and Knowth Court were also monitored over the last month and this resulted in a number of tenants being called in and warned about illegal dumping.

Public Domain

Complaints relating to public domain issues can now be logged by calling in to the public counter in the Ballymun Area Office or by phoning 222 5610. Issues that can be reported include illegal dumping, graffiti, broken footpaths and open spaces.

Pyrite

Remediation works are on-going in Owensilla and Balbutcher Way. Four families moved temporarily to Hampton Woods for the duration of the works. The works are expected to be completed in another 4-6 weeks. Surveys for Pyrite are at an advanced stage in other locations in Owensilla and Carton estates and the results are expected in about 6 weeks.

Shangan Avenue

Shangan area is being closely monitored by the Waste Management Section and the Area Office after a sharp rise of household waste being illegally dumped in recent weeks.

The Solar Contractor will be on site in two weeks to replace solar panels and water pumps in various units.

Missing and broken bollards will be replaced in the Shangan area over the next two weeks.

The walk through between Whiteacre Place and Shanliss Grove will be resurfaced and the old bollard removed.

Magenta Crescent

An Bord Pleanála has made a determination in relation to the cost of the pedestrian crossing on the Swords Road and it is envisaged that the crossing will be in place by the summer. The residents are preparing for a clean up ahead of the 1916 festival and Dublin City Council are supporting them with the supply of any equipment and planting material requested.

Poppintree

Dublin City Council will be surveying the open stairways in the Poppintree Crescent area with a view to installing gates in order to stop or reduce antisocial behaviour. Community groups in the Poppintree area are active with cleaning common areas and preparing for spring planting in the area. Dublin City Council erected fencing and kissing gates to further protect these areas especially Knowth Court.

A large clean up by the Area Office removed several lorry loads of illegal dumping from Carton Terrace, Termon Court and the waste lands in the area over the past two weeks.

Ballymun Rent Assessment Update – February 2016

Assessments	315
Permission To Resides	17
Refunds	8
Opening of Accounts	5
Closing of Accounts	6
Front Counter Calls	447
Window Replacements	4

Ballymun Lettings February 2016

Allocation Category	Housing List	Transfer List
Band 1 Priority	0	0
Welfare	2	0
Travellers	0	0
Surrendering Larger	0	0
Medical	1	1
Homeless	3	0
Band 2	1	0
Band 3	1	0
Sub Total	8	1
Total Lettings	9	

Estate Management February 2016

No of Anti social complaints per 1997 act Drug Related	4
No of Anti social complaints per 1997 act Not Drug Related	22
No of other Complaints	0
Total Complaints	26
No of Anti Social Interviews per 1997 act	14
No of Other Interviews	10
Total Interviews	24
No of Requests for mediation	0
No of Complaints referred to central unit for Action	0
No of Section 20 Evictions	0
No of excluding Orders applied for by Tenant	0
No of Excluding orders applied for by DCC	0
No of surrender of Tenancies due to Anti Social Behaviour	0
No of Notice to Quits sent to Central Unit	0
No of Court Orders Granted	0
No of Appeals / Judicial Reviews Challenges	0
No of Warrants executed (Evictions)	0

3. Ballymun Town Civic Alliance

1. Economic Strategy

A draft 5 year economic plan has been completed. The plan was reviewed and discussed by the Economic Sub-Committee on 6th November 2015. The committee provided input and feedback which will be incorporated into the plan and reviewed again before submission to the Civic Alliance in March 2016. The Economic Development Officer has already commenced implementing some of the economic objectives.

2. Stimulating economic activity

i. Free Wi-Fi for Plaza – a license agreement has been agreed with Magnet Networks for the installation and provision of free Wi-Fi on the Plaza. An installation was agreed between the architect and Magnet Networks. However when Airfibre came out to survey the site there realised there would be difficulty penetrating the steep girdle. The architect is now looking at an alternative approach to get access under the window sill. The revised specification is now with the Dublin City Council's Structural Engineer.

ii. Vacant Neighbourhood retail units – The Economic Development Officer now has access to all available units. A brochure has been produced to market each of the units and 'To Let' signs have been produced. The current status of vacant Dublin City Council units is:

Location	Status	Comments
Coultry Unit B	T&C's offered for a new café	A Planning application has been submitted for change of use.
Coultry Unit C & D	Vacant	Units require remedial works and will be available for let in Feb 2016
Shangan Court Unit 2	This unit is now back on the market after the deal for a new barber shop didn't go ahead.	Available
Turnpike Santry Cross Unit 3	Pieta House have now moved to Coultry Neighbourhood Centre	Available
Silloogue, Unit 3	T&C's offered and accepted for a barber shop	Shop will be ready for opening in Jan 2016

There are only 2 units in Coultry under the remit of Dublin City Council available to rent. There is remedial works being carried out on these units and once completed 'To Let' signs will be displayed and we will be in a position to start generating interest.

iii Event – 'StartUp Ballymun' 14th April 2016

Following on from the Succeed in Business Event in October 2015 and event titled 'StartUp Ballymun' will be held in the Council Chamber on 14th April 2016. The objective of the event is to promote enterprise and business opportunities by:

- Inviting successful entrepreneurs and founders to speak as role models.
- Provide information from readily available services of Dublin City Council, the LEO and other partner supports.

Our target audience is people from Ballymun and the Northside interested in starting up a business in Ballymun and nearby.

The date was changed due to a clash with the LEO's City-wide Enterprise Week. To date we have 3 businesses speakers and 5 business support organisations confirmed for the event. A 'StartUp Ballymun' Facebook and Twitter account has been set up to help promote the event. Bookings can be made through the Facebook page and Eventbrite.

iv. Enterprise Unit database

A database of all publicly and privately owned units in Ballymun is near completion. The database will include:

- Location map
- Drawings
- Photos
- Owner details
- Status (Receivership / available etc.)

v. CoderDojo www.coderdojo.com

CoderDojo is a global movement of free, volunteer-led; community based programming clubs for young people. At a Dojo young people between 7 and 17 learn how to code, develop websites, apps, programs, games and explore technology in an informal and creative environment. In addition to learning to code attendees meet like minded people and are exposed to the possibilities of technology.

Within the CoderDojo Movement there is a focus on community, peer learning, youth mentoring and self led learning, with an emphasis on showing how coding is a force for change in the world.

The Economic Development Officer has been to see a 'Dojo' in action in the Dogpatch Labs at the CHQ building, IFSC. There is also a Dojo being run in DCU and they have invited the Economic Development Officer to attend and share some advice on recruiting mentors and promoting a Dojo. Their Dojo takes place on Saturdays and a visit will take place over the next few weeks.

vi. Enterprise Space

The retail units in Shangan will become available in 2017 once the Rediscovery Centre relocates to the old Boiler House. The Economic Development Officer will be exploring different options to make best use of this space

3. [Ballymun4Business](#)

To date we have had 4 B4b meetings take place. They have been hosted in both the Council Chamber and the Social Innovation Hub also on the 1st floor.

We now have active engagement with 24 local businesses. The group have agreed a vision and some objectives:

- Increase foot-fall
- Community Engagement Initiatives
- B2b networking

The B4b website www.b4b.ie has been reactivated and the Facebook page is now back in use. An executive Committee has been formed comprising of:

Chairman	Richard Murphy, Super Valu
Secretary	Liam Barry, Economic Development Officer
Treasurer	Patrick Devaney, Ballymun Credit Union
Marketing	Dean Kearns, DMK Food Supplies and Smart Bits

Actions Agreed:

- B4b sponsorship of 20 hanging baskets to be hung outside local businesses
- Ballymun Communications commissioned to do 90 second video case studies of local business to be posted on Social Media and B4b website
- Revamp of the website and marketing plan to be drafted
- Creation of a tag-line for the network and promotional material

The plan for B4b over the coming months will be to:

- Increase membership
- Invest in promotional material such as banners/business cards
- Carry out case studies of local business to feature on the website and social media

The next Civic Alliance Meeting will be held in April 2016 when Deiric O'Broin, CEO NorDubco will chair his first meeting.

There was a meeting of the Physical/Environmental Sub Committee on 25th February. The development proposed for the Northern Site is likely to be a 4 story building consisting of 5 retail units and a food anchor with offices overhead. The developer has eight weeks to lodge a planning application and the pre-planning meeting went well. AIB is constructing a unit in the Civic Centre and the fit out should take 8 weeks. Sarah Miller gave an update on the Rediscovery Centre, the builders are on site since January and all is going well.

There was a meeting of the Economic Sub Committee on 25th February. Feedback was invited from the members of the committee on the Economic Development Plan. An update on Ballymun Town Centre Wi-Fi was given. There is an installation issue with the access point on the building which needs to be resolved; the structure of the building is providing challenges. The Ballymun4 Business Network has been re-activated and has held 3 meetings so far. A business event, 'Start-up Ballymun' will be held on 14th April in the Council Chamber, Civic Offices. An update on the Retail Strategy for Ballymun was given; the final report is being prepared by AECON consultants after presenting a final draft to both the Civic Alliance Committee and NWA Committee. The consultants have agreed to factor in the development of the Northern Site into the final report.

There was a meeting of the Social Sub Committee on 29th February. There was a presentation by Eleanor McClorey on YoungBallymun, who are in a challenging situation awaiting a decision regarding future funding. Eleanor gave a background to the start up of YoungBallymun and the services it provides, including prevention and early intervention programmes. The Social Sub Committee agreed to make a case for the continuation of funding of YoungBallymun. There was a report on the facilitated workshop held in December where there was a poor turnout by the statutory agencies. Education will be placed on the Agenda and Trinity Comprehensive will give an update at the next meeting.

3. Safer Ballymun

The latest meeting of the Safer Ballymun Community Safety Forum took place on Tuesday February 9th in the Council Chamber in Ballymun Civic Centre. Donal Barron Dublin City Council chaired the meeting and Garda David Moore gave the statistics for the period from December 20th to February 8th. The main issues discussed on the night were crime and anti-social behaviour in the parks.

4. Drumcondra Glasnevin Community Forum

The next meeting of the Drumcondra Glasnevin Community Forum will take place on Wednesday March 30th in the Maples Hotel, Drumcondra.

5 Other significant updates

Ballymun Shopping Centre and surrounds:

Work is due to commence in the next few weeks on the demolition of the old Ballymun Swimming pool.

Significant progress has been made with the HSE in relation to the disposal of the old Health Centre to the City Council.

Preparatory work on the proposed compulsory purchase of the remaining occupied units in the shopping centre is ongoing.

An on-site meeting in the car park on the south west of centre was held on 8th March with a view to the resurfacing and installation of paid parking in this area, most likely at the lowest rate of 60c per hour. Warning notices were placed on cars parked in the paid parking areas on street beside Supervalu and enforcement action will be taking place in this location in order to free up spaces for shoppers rather than all day parking.

Mary Taylor
Assistant Area Manager

**To the Chairman and Members of
The North West Area Committee**

Meeting: 15th March 2016

Item No: 18

With reference to the proposed grant of 3 year licence of Workshop 3, & 4 Poppintree Neighbourhood Centre, Ballymun, Dublin 9, to Poppintree Environmental Project Limited.

Poppintree Environmental Project Limited currently holds a licence for 12 months of Workshops 3 & 4 Poppintree Neighbourhood Centre Ballymun, Dublin 9. The licence will terminate on the 31st March 2016.

For administrative and cost effective purposes it is now proposed to grant a further licence for the longer term of 3 years for Workshops 3 & 4 to Poppintree Environmental Project Limited, which is shown, outlined red and coloured yellow on attached map subject to the following terms and conditions.

1. The licence shall be for 3 years from 1st April 2016 to 31st March 2019.
2. The licensed areas shall be used by Poppintree Environmental Project Ltd as an office and storage area.
3. The licence fee for both units shall total €260.00 per annum (two hundred and sixty euro), payable quarterly in advance.
4. The units may be used from 9.00 am to 8.00 pm daily. The licensed areas may only be used outside of those hours with the expressed permission of the City Council.
5. Keys to the units shall only be held by official representatives of Poppintree Environmental Project Ltd who shall be responsible for their use and all security issues associated with their use.
6. The licence can be terminated by either party on giving the other one months notice in writing.

7. The licensee shall be responsible for all outgoings including electricity, water, rates and any taxes or charges which may be due on the licensed areas.
8. The licensee shall be responsible for its own waste removal from the units and shall make its own arrangements for same.
9. The licensee shall not assign sublet or otherwise part with any part of the licensed areas.
10. The licensee shall keep the licensed areas in good condition and repair during the term of the licence and shall not make any material changes to the subject property without the prior consent of the Council.
11. The licensee shall abide by all protocol, systems and procedures laid down by Dublin City Council in relation to the premises.
12. The licensee shall obtain a high level of public liability insurance and employer's liability insurance (if applicable) which shall indemnify the Council against any and all claims arising from the licensee's use of the premises. The Council will have an absolute right to set a minimum level of public liability and employer's liability insurance and to review the figures on a yearly basis (the current minimum levels are €6.4million and €13million respectively).
13. The licensee shall sign a Deed of Renunciation document.
14. On termination of the licence, the licensee shall be responsible for the removal of all their materials not belonging to the City Council from the premises.

The grant of the licence shall be subject to such conditions as to title to be furnished as the Law Agent in his discretion shall stipulate.

The dates for the performance of any of the requirements of the proposed agreement may be amended at the absolute discretion of the Executive Manager.

No agreement enforceable at law is created or intended to be created until an exchange of contracts has taken place.

Paul Clegg

Executive Manager

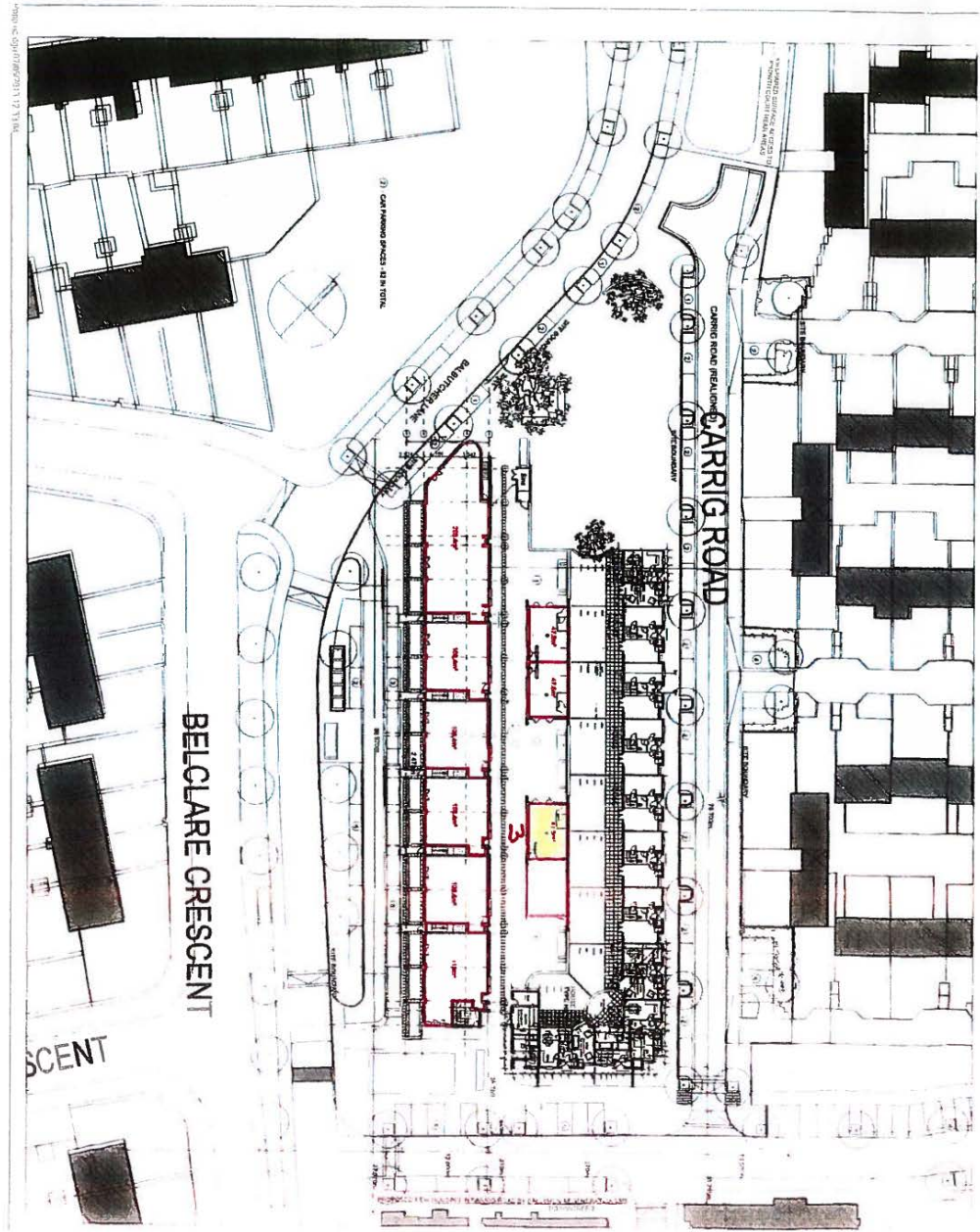

**The Chairman and Members of
North West Area Committee.**

Meeting: 15th March 2016

Item No: 19

Naming Proposal for Plaza on Ballymun Road, Dublin 9 - Cearnóg an tSeachtar Laoch

This is an area of open space to the front of the Civic Centre on Ballymun Road, Dublin 9. A request was received to name the area in memory of the Seven Signatories of the 1916 Proclamation, after whom the 7 towers in Ballymun were also named. The area is indicated on the attached Drawing R.M. 36477.

The proposed name is Cearnóg an tSeachtar Laoch. The Heritage Officer considers the proposed name appropriate.

The name Cearnóg an tSeachtar Laoch is considered suitable and is recommended for adoption.

Dave Dinnigan

Executive Manager.

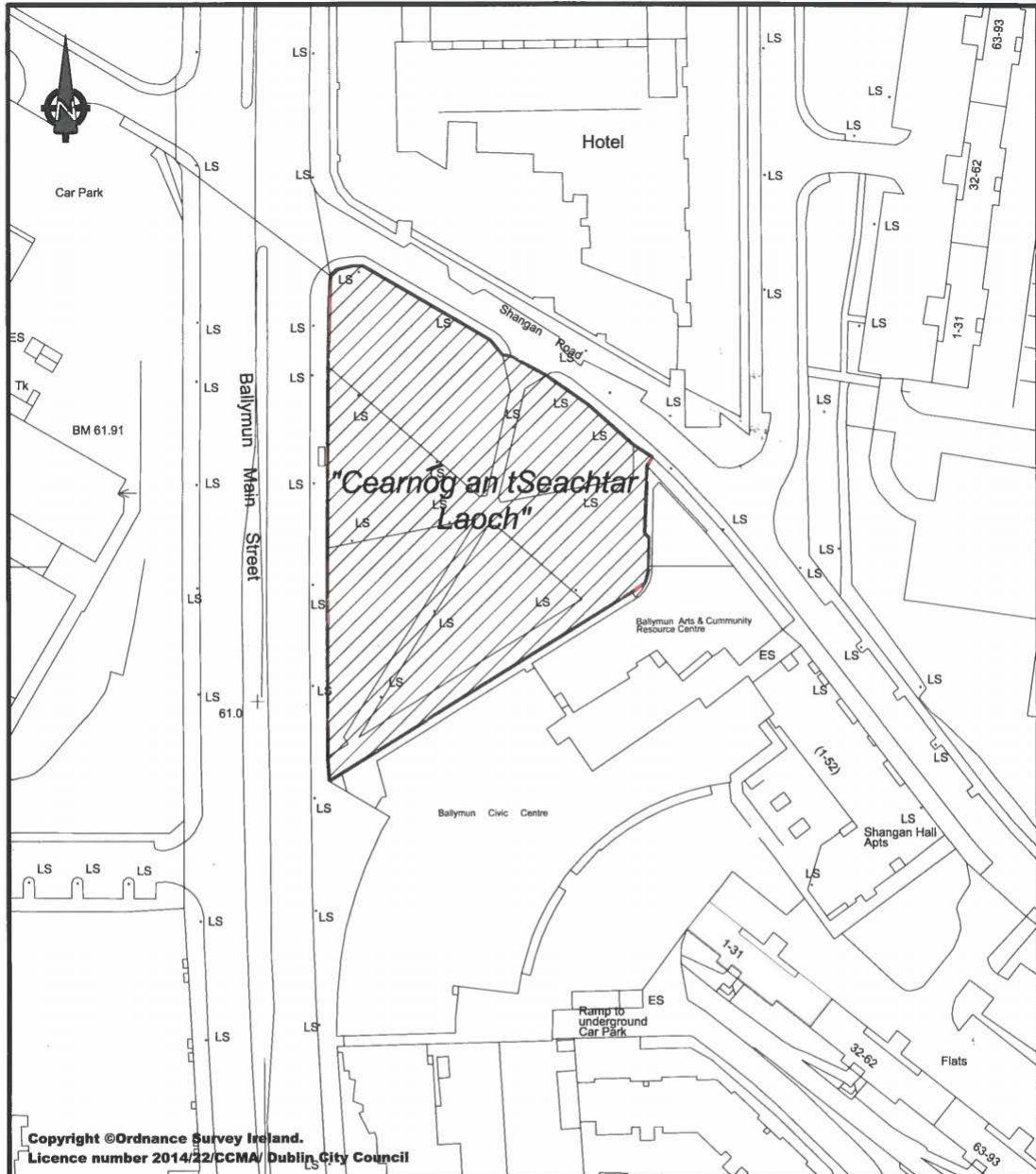

 <p>DUBLIN CITY COUNCIL Comhairle Chathair Bhaile Átha Cliath</p> <p>ENVIRONMENT & TRANSPORTATION DEPARTMENT, CIVIC OFFICES, WOOD QUAY, DUBLIN 8.</p>	<p>"Cearnóg an tSeachtar Laoch" Proposed naming</p>									
	<p>ROADS MAINTENANCE DIVISION</p>									
<p>John Flanagan EXECUTIVE MANAGER (ENGINEERING)</p>	<table border="1"> <thead> <tr> <th>C.A.D. BY</th> <th>DATE</th> <th>REVISED</th> <th>SCALE</th> </tr> </thead> <tbody> <tr> <td></td> <td>/20</td> <td>/20</td> <td>1:1250</td> </tr> </tbody> </table>	C.A.D. BY	DATE	REVISED	SCALE		/20	/20	1:1250	<p>R.M. 36477</p> <p>22/10/2015</p>
C.A.D. BY	DATE	REVISED	SCALE							
	/20	/20	1:1250							