

COISTE AN LÁRCHEANTAR

CENTRAL AREA COMMITTEE MEETING

Tuesday 8th July, 2014 at 2.30 p.m.

Agenda

- 5890 Election of Chairperson
- 5891 Election of Vice-Chairperson
- 5892 Minutes of the Central Area Committee meeting held on 13th May, 2014
(Attached) pages 4-8
- 5893 Questions to the Area Manager
(Attached) pages 64-67

Planning and Development Matters

- 5894 With reference to the proposed Demolition of St. Mary's Terrace, Dorset Street, a 2-storey block comprising 12 one-room units at ground floor level and 12 on the first floor (total 24 units) - in compliance with the provisions of the Local Government Act 2001 and Part 8 of the Planning and Development Regulations 2001 as amended.
(Report & Map Attached) pages 11-14
- 5895 With reference to the the proposed amalgamation of 68 no. bedsits and refurbishment of 1 no. 1-bed apartment, into 35 no. 1-bed apartments at the Senior Citizens Complex, St. Brigid's Park, (Block 1, nos. 27 – 50, Block 2, nos. 51 – 72, and Block 3, nos. 73 – 96), Arbour Hill, Dublin 7. - in compliance with the provisions of the Local Government Act 2001 and Part 8 of the Planning and Development Regulations 2001 as amended
(Report & Map Attached) pages 15-19
- 5896 With further reference to the proposed grant of a licence of land for a community garden at the rear of Summer Street North / Sean O'Casey Avenue, Dublin 1.
(Report & Map Attached) pages 20-22
- 5897 With reference to Derelict Sites quarterly report.
(Report Attached) pages 23-27

Roads & Traffic Department Matters

- 5898 With reference to the minutes of the Traffic Advisory Group meetings held on 27th May and 24th June, 2014
(Report Attached) pages 28-51

Central Area Matters

- 5899 With reference to the nominations for the following boards:
 - (a) Dominick Street Regeneration Board (1 member)
 - (b) North Inner City Community Policing Forum (2 members)
 - (c) North Inner City Drugs Task Force (4 members)

- 5900** Updates on the following:
Environmental Services Unit **pages 52-57**
North East Inner City Housing Issues **pages 58-60**
North West Inner City Housing Issues **pages 61-63**
(Reports Attached)

Motions

5901 Motion in the name of Councillor Ciaran Cuffe

This Central Area Committee calls on the Chief Executive to put in place a Traffic Management Plan in regard to the development of Grangegorman, to cope with the arrival of a 1,000 Institute of Technology students plus staff from September next, and to clarify what consultation measures has the City Council had with the surrounding communities.

5902 Motion in the name of Councillor Ciaran Cuffe

This Central Area Committee gives consideration to naming the new green area on King Street North, Dublin 7 after Brigadista Doyle.

5903 Motion in the name of Councillor Nial Ring

That this Committee requests that a full review of any proposed plans by Dublin City Council for a cycle lane along the Linear Park on Royal Canal Bank be carried out immediately. This review should include consultation with all stakeholders, especially the local community who currently use this splendid facility and who have rightly expressed concern that the introduction of a cycle lane in such a narrow area would have a detrimental effect on their enjoyment of the amenity.

5904 Motion in the name of Councillor Nial Ring

That this Committee instructs the Manager to write to David Franks, Chief Executive of Iarnród Éireann requesting him to immediately address the problem of persistent graffiti on the bridge over St. George's Avenue by way of cleaning/painting of the bridge and the installation of a long term security solution to prevent access thereto.

5905 Motion in the name of Councillor Nial Ring

That this Committee supports the recent formation of the 1916 Relatives Group whose objectives is primarily to compile a database of relatives of those who fought for Irish freedom in 1916, whether in the various Dublin Garrisons or in country units and to canvas the Government directly and through the state commemorations committee to ensure that, contrary to rumours circulating that relatives will not be invited to planned commemoration/celebration ceremonies such as Arbour Hill and the GPO Commemorations in 2016, relatives/descendants will be consulted, listened to and invited to partake in the ceremonies in a meaningful and inclusive basis.

5906 Motion in the name of Councillor Gary Gannon

That this Committee asks the Chief Executive to recognise that the privatisation of waste management services has been an unmitigated failure and seeks to reclaim waste management services for public ownership.

5907 Motion in the name of Councillor Gary Gannon

That this Committee agrees that fines should be increased for any waste service provider who fails to collect appropriately tagged waste bags on the allocated day.

5908 Motion in the name of Councillor Gary Gannon

That this Committee calls on Dublin City Council to allocate the appropriate funds to redevelop and open up vacant properties throughout the Central Area. Though not entirely sufficient to resolve the on-going housing crisis, this measure may go some way towards alleviating the burden.

5909 Motion in the name of Councillor Gary Gannon

That this Committee calls on Dublin City Council to expedite the necessary redevelopment of the Constitution Hill flat complex.

5910 Motion in the name of Lord Mayor Christy Burke

That this Committee agrees to call on Senior Garda management to patrol the stairways of flat complexes in the North Inner City in order to help prevent anti-social behaviour.

5911 Motion in the name of Lord Mayor Christy Burke

That this Committee agrees to debate the future of the erection of election posters in the city.

5912 Motion in the name of Councillor Ray McAdam

That this Area Committee rejects the Chief Executive's plans to close the Cabra Area Office in light of the huge role staff play in assisting the needs of the community across Cabra but also the way in which staff regularly meet with and assist residents' associations and community groups across the North-West Inner City. Given the huge investment that is being made across Cabra and the North-West Inner City with the opening of the Grangegorman campus and the Luas Cross City to Broombridge for example, it is the wrong decision that the Cabra Area Office be closed and we call for it to be maintained.

5913 Motion in the name of Councillor Ray McAdam

That this Area Committee rejects the decision of the Planning Department not to hold an Oral Hearing into the application by Aiken Promotions and Croke Park for five concerts at the end of July. Given the level of concern in the community about this process and the large number of submissions made, an Oral Hearing should have been held. This Committee calls on the Chief Executive to direct the Planning Department to organise the holding of an Oral Hearing as a matter of priority.

Next Meeting Tuesday 9th September, 2014

CLOSING DATE FOR RECEIPT OF MOTIONS AND QUESTIONS

12 noon on Friday 29th August, 2014

**CENTRAL AREA COMMITTEE
COISTE AN LÁRCHEANTAR**

CENTRAL AREA COMMITTEE MEETING

Tuesday 13th May, 2014 at 2.30 p.m.

Minutes

- 5869** Minutes of the Central Area Committee meeting held on 8th April, 2014
ORDER: Agreed.
- 5870** Questions to the Area Manager
ORDER: Noted.

Planning and Development Matters

- 5871** With reference to the proposed grant of a 3 year licence of the premises at 117-119 North King Street, Dublin 7 to the North West Inner City Network Ltd.
ORDER: Agreed. Recommend to City Council.
- 5872** With reference to Planning Enforcement quarterly report.
ORDER: Report noted.

Roads & Traffic Department Matters

- 5873** With reference to the minutes of the Traffic Advisory Group held on 29th April, 2014
ORDER: Report noted.

Central Area Matters

- 5874** With reference to allocation of funding to Central Area for a spending programme under various categories.
ORDER: Report noted and agreed.
- 5875** With further reference to a proposal for the Extinguishment of the Public Right of Way over the laneway to the rear of 28-39 Abbey Street Lower, including portion to the side of 111 and 112 Marlborough Street, and 1-11 O'Connell Street Lower, known as Harbour Court, Dublin 1
ORDER: Agreed not to proceed with the Extinguishment of the Public Right of Way.
- 5876** With reference to a proposal to initiate the procedure for the Extinguishment of the Public Right of Way over the laneway over Proby's Lane off Upper Liffey Street, Dublin 1.
ORDER: Agreed to initiate the procedure.
- 5877** Updates on the following:
Environmental Services Unit
NEIC Projects
North West Area (including HARP) Housing Issues
North East Inner City Housing Issues
North West Inner City Housing Issues
ORDER: Reports noted.

Motions

5878 Motion in the name of Councillor Christy Burke

This Central Area Committee agrees to identify a pathway or a site for a memorial to organ donors.

ORDER: Agreed.

5879 Motion in the name of Councillor Seamas McGrattan

This Committee calls on DCC and Irish Rail to upgrade the Liam Whelan Bridge in Cabra following the recent respect shown by local residents and clubs to the Bridge and the Whelan family.

ORDER: Agreed. Letter to be sent to Irish Rail.

5880 Motion in the name of Councillor Cieran Perry

This Committee calls for the retention of the Dublin City Council local area office in Cabra.

ORDER: Report to Councillor.

5881 Motion in the name of Councillor Mel MacGiobuin

This Committee calls on Dublin City Council to maintain the integrity of the entire battlefield site of Moore Street and adjacent laneways including at its centre the National Monuments of the final Headquarters of the Irish Provisional Government of 1916 Easter Rising and that any development is in full keeping with that integrity of 'the most important site in modern Irish History'.

ORDER: Report to Councillor.

5882 Motion in the name of Councillor Padraig McLoughlin

This Committee would support further limits on the placing of posters during Election Campaigns and asks that proposals and arrangements for this be made as soon as possible.

ORDER: Report to Councillor.

5883 Motion in the name of Councillor Padraig McLoughlin

This Committee expresses alarm at the high number of areas with repeated missed refuse collections in the North Inner City area and asks that the Local Area Office liaise with interested parties to find a solution to this growing problem.

ORDER: Report to Councillor.

5884 Motion in the name of Councillor Cieran Perry

This Committee calls on Payzone to instruct the shops using their service to cease imposing a charge on their customers – some retailers implement an additional charge per bill for those using the service.

ORDER: Agreed. Letter to be sent to Payzone.

5885 Motion in the name of Councillor Nial Ring

That this Committee welcomes the decision of the Minister for Arts, Heritage and the Gaeltacht, Jimmy Deenihan, to approved revised designs submitted by the owners of the National Monument at Nos. 14 – 17 Moore St for the restoration of the monument buildings and the creation of a 1916 commemorative centre on the site and agrees that the commemorative centre, when built, should be operated by Dublin City Council in line with the recommendations of the DCC Moore Street advisory Committee.

ORDER: Report to Councillor.

5886 Motion in the name of Councillor Nial Ring

That this Committee requests the Dublin Institute of Technology (DIT, in conjunction with the Grangegorman Development Agency (GGDA), to develop a student behaviour code of conduct to ensure that anti-social behaviour in the area is minimised and that students are fully aware of their responsibilities to their neighbours. Furthermore, that the code of conduct details sanctions available such as suspension and expulsion and highlights the duty of care both the GGDA and DIT have to the local community.

ORDER: Agreed. Letters to be sent to the Grangegorman Development Agency and the Dublin Institute of Technology.

5887 Motion in the name of Councillor Nial Ring

That this Committee agrees that before installation of the "Welcome to" signs for Ballybough, East Wall and Stoneybatter, local resident associations and other interested groups be contacted/consulted on the logo design for each area

ORDER: Report to Councillor.

5888 Motion in the name of Councillor Nial Ring

That this Committee fully supports the initiative to develop Ellis Court into a multifunctional cultural centre.

ORDER: Report to Councillor.

5889 Motion in the name of Councillor Nial Ring

That this Area Committee thanks the Manager and his staff for their work for and support of Councillors over the past five years and for the professional, courteous and attentive way in which they dealt with all queries, issues and matters brought to their attention.

ORDER: Report to Councillor.

ATTENDANCE

Cllr. Padraig McLoughlin (Chairperson)

Cllr. Mary O'Shea (Vice Chairperson)

Cllr. Ray McAdam

Cllr. Christy Burke

Cllr. Mary Fitzpatrick

Cllr. Cieran Perry

Cllr. Nial Ring

Cllr. Lucy McRoberts

Cllr. Mel MacGiobúin

Apologies

Cllr. Aine Clancy

Cllr. Seamas McGrattan

OFFICIALS

Charlie Lowe, Executive Manager, Central Area
Eileen Gleeson, Senior Executive Officer, Central Area
Fergus Synnott, Administrative Officer, Central Area
Chris Butler, Area Housing Manager, Central Area
John McPartlan, Public Domain Officer, Central Area
Brian Kavanagh, Area Housing Manager, Central Area
Fiacra Worrell, Assistant Planning Enforcement Officer.
Tom Vaughan, Senior Staff Officer, Planning Department
Eoin Walsh, Assistant Engineer, Traffic Department
Cathy Cassidy, Acting Senior Staff Officer, Central Area
Sandra Walley, Assistant Staff Officer, Central Area

Councillor Pdraig McLoughlin
Chairperson
13th May, 2014

**Central Area Committee
Motions with replies
May 2014**

Item 5878

Motion in the name of Councillor Christy Burke

This Central Area Committee agrees to identify a pathway or a site for a memorial to organ donors.

Report

This is a matter for the members to agree or otherwise.

Item 5879

Motion in the name of Councillor Seamas McGrattan

This Committee calls on DCC and Irish Rail to upgrade the Liam Whelan Bridge in Cabra following the recent respect shown by local residents and clubs to the Bridge and the Whelan family.

Report

A letter will be forwarded to Irish Rail if the members agree the terms of the motion.

Item 5880

Motion in the name of Councillor Cieran Perry

This Committee calls for the retention of the Dublin City Council local area office in Cabra.

Report

In December 2013 the City Manager established a group to review the area structure (Area Review Group) and the functions carried out at area level.

Among the terms of reference for the group were :-

To review the current area boundaries and make proposals taking account of

- the experience with the operation of the current areas
- the new local electoral area boundaries that will come into operation
- the need to ensure that the workload of the areas is broadly equivalent taking account of the needs of the areas.

To review the human and financial resource cost of the areas and to make recommendations for an appropriate structure for the areas.

To review the area office arrangements mindful of the costs of maintaining and operating area offices, to make recommendations for which offices should be retained and the services to be offered at different offices. The issue of appropriate number, location and functions of area offices should be considered in the context of the proposed new area boundaries.

The review group in carrying out its work had to be mindful of the budgetary constraints the Council is operating under and the inevitability that the staff numbers will continue to decline over the medium term. Delivery of service and associated resources must be driven primarily by service quality and value for money considerations.

Following consideration of the matter by the Area Review Group their report to the City Manager(which he has accepted) recommended an examination be carried out to reduce the number of area offices which would be progressed in 2014 and in that context functions provided from the Cabra office are currently being examined.

The consultation phase of the Review Report in so far as it relates to the Cabra office has now commenced with both staff and the relevant union.

Item 5881

Motion in the name of Councillor Mel MacGiobuin

This Committee calls on Dublin City Council to maintain the integrity of the entire battlefield site of Moore Street and adjacent laneways including at its centre the National Monuments of the final Headquarters of the Irish Provisional Government of 1916 Easter Rising and that any development is in full keeping with that integrity of 'the most important site in modern Irish History'.

Report

The Councillor refers to the evacuation route from the GPO and to 14-17 Moore Street (National Monument). Dublin City Council is bound by the terms and conditions of the decision made by An Bord Pleanála , PL 29N.232347 refers. In relation to these issues, conditions 5 and 10 of that permission are relevant.

Condition 5 states-

"No works shall commence within the preservation order boundary of the National Monument at 14-17 Moore Street unless the prior Ministerial consent to such works has been obtained in accordance with the statutory requirements of section 14 of the National Monuments Act , 1930-2004".

Condition 10 states-

"Prior to the commencement of development, the developer shall submit for the written agreement of the planning authority, a detailed project proposal in which the historic significance of the critical locations along the evacuation route from the GPO through the site is featured and interpreted. The proposal shall include a detailed project concept and an implementation programme. The project shall carried out as part of the overall development"

In relation to condition 5 of An Bord Pleanála decision as outlined above, the Ministerial consent issued on 30th April satisfies this condition.

In relation to Condition 10 of An Bord Pleanála decision as outlined above, the developers are required to seek the written agreement of the planning authority, in relation to the items specified, prior to the commencement of development. A compliance submission will be required from the developers for the written agreement of Dublin City Council's before development commences on the site.

Item 5882

Motion in the name of Councillor Pdraig McLoughlin

This Committee would support further limits on the placing of posters during Election Campaigns and asks that proposals and arrangements for this be made as soon as possible.

Report

The extract below is from a letter circulated to all candidates in the upcoming Election. Proposals for further Election Campaigns should be made to the Engineering S.P.C.

“Local & European Elections 2014 - Postering

I write to seek your assistance on a number of matters relating to the erection of posters for the forthcoming Local & European Elections.

Firstly, please note, that posters will **only** be permitted on suitable lamp standards between Wednesday 23rd April 2014 and midnight on the 30th May 2014.

Any posters found to be in place at any time outside of these statutory timescales will result in the issuing of a fine of €150 per individual poster”.

To the Chairperson and Members
of the Central Area Committee.

1st July, 2014

With reference to the proposed Demolition of St. Mary's Terrace, Dorset Street, a 2-storey block comprising 12 one-room units at ground floor level and 12 on the first floor (total 24 units) - in compliance with the provisions of the Local Government Act 2001 and Part 8 of the Planning and Development Regulations 2001 as amended

In compliance with the provisions of the Local Government Act 2001 and Part 8 of the Planning and Development Regulations 2001 as amended, I hereby notify you that it is Dublin City Council's intention to carry out the following works:-

Demolition of St. Mary's Terrace, Dorset Street, a 2-storey block comprising 12 one-room units at ground floor level and 12 on the first floor (total 24 units).

(A) The Site

The site is located in the Dorset Street social housing complex. This large flat complex fronts onto Dorset Street and extends from Dominick St. Upper to St. Mary's Place North. The complex contains 206 social housing units arranged in 5-storey blocks running east-west. The application site is located at the western end of the complex and comprises a 2-storey block of 24 senior citizens bedsit units, 12 units at each level.

The buildings are bounded by an access road, St. Mary's Terrace, on the western side and a railed garden space on the eastern side.

(B) The Proposal

The Part 8 Planning Application is for the demolition of St. Mary's Terrace, a 2-storey block comprising 12 one-room units at ground floor level and 12 on the first floor (total 24 units). Following the demolition of the building it is proposed to retain the existing boundary walls and to landscape the open space, retaining the existing trees. A new low railing will be constructed at the gable ends of the demolished building to match the height and finish of the existing railing. The long wall to St. Mary's Terrace will be largely retained, but the North-East corner will be provided with a new railing to match the existing, and the palisade fencing will be removed. Access will be maintained at both ends of the grassed area, one of these being a 3metre access for maintenance at the North West corner. Two new public lighting columns will be provided, one at each end of the demolished building to replace those affixed to the building.

Site Planning History

The Dorset Street complex consists of 206 flats most of which are 2-bedroom and there are 11 voids in the complex. The flat complex has been challenging to manage and consequently difficult to let for several years and voids tend to become long-term. The lack of amenity open space is a contributory factor as is the derelict senior citizens complex which sits in front of the main entrance to the scheme. All the senior citizen bedsits have been vacant for years and it would be virtually impossible to re-tenant. It was de-tenanted following a number of long-term vacancies and aside from the current dilapidated condition it was not seen as being able to provide adequate housing for elderly tenants. In the past few years the property has been the subject of regular serious anti social behaviours including fires and break-ins. The most recent was in 2013 when part of the roof was destroyed by fire.

(C) Submissions

The proposal was advertised in the Irish Times on the 16th April 2014 inviting inspection of the proposals at the Planning Department from 16th April 2014 to 4th June 2014 (excluding 18th and 21st April, 5th May and 2nd June) and requesting written submissions not later than 18th June 2014.

Third Parties:

One written observation was received noting that the site notice gives no reason or explanation for the proposal and outlining concerns which may be summarised as:

- Queries why the units are being demolished and if they are substandard
- Queries whether there are definite plans to provide 24 units elsewhere as there is a shortage of housing in the city
- Queries if the proposed use as landscaped open space is the best use for a residential site in the inner city

The Housing Department responded to the submission by pointing out that the demolition of these units has been anticipated for some considerable time and they have been vacant for many years and the Council has provided housing in the area including 28 units at Sheridan Place which were occupied during 2007. The units cannot be brought up to standard at a reasonable and economic cost, and the provision of a small number of infill units was considered but was not regarded as the best use of the space created by the demolition. It was considered important to provide open space for the residents of Dorset Street flats including St. Mary's Place which is a relatively densely developed scheme (comprising 113 units) and which has been suffering with issues related to the location of this block of flats for some time.

(D) Evaluation

In the Dublin City Development Plan 2011 – 2017 the site is zoned Z1 – To protect, provide and improve residential amenities.

The Planner has visited the site and noted the condition of the building, in particular the significant fire damage and the fact that the sheeted openings have been interfered with to provide unauthorised access. It appears that the building is a constant target for vandalism and anti social behaviour. It is clear that this presents a significant problem for the residents of the complex.

The existing units are not fit for purpose, and it is therefore considered that the proposed demolition is acceptable. There are no current proposals to replace the 24 units, or to provide a net increase in the number of dwelling units. The Housing Department states in its submission that:

‘Dorset St has little in the way of private open space and the complex has limited access to communal open space. Given the inadequacy of the existing open space for the overall scheme, it is considered by Housing that the space freed up by the demolition of these 24 bedsits should be used to provide additional open space for the remainder of the complex rather than trying to use the space to replace the 24 units. A pocket park is proposed for the space’.

In this regard it is considered that the provision of additional amenity space for the residential area is in accordance with Dublin City Development Plan policy GC14 ‘To seek the provision of additional space in areas deficient in public open space by way of pocket parks’.

The Planning Authority considers the proposal to be consistent with the Dublin City Development Plan 2011 – 2017 and in accordance with the proper planning and sustainable development of the area, and should proceed having regard to the recommendations and requirements of the Air Quality and Noise Control Section, Drainage Section and the Planning Department.

This report is submitted to the Central Area Committee for approval.

If this proposal is agreed at Area Committee it is intended that a further report will be brought to the City Council meeting in September 2014 in compliance with the provisions of the Local Government Act 2001 and Part 8 of the Planning and Development Regulations 2001 as amended

Gerry Geraghty

Executive Manager

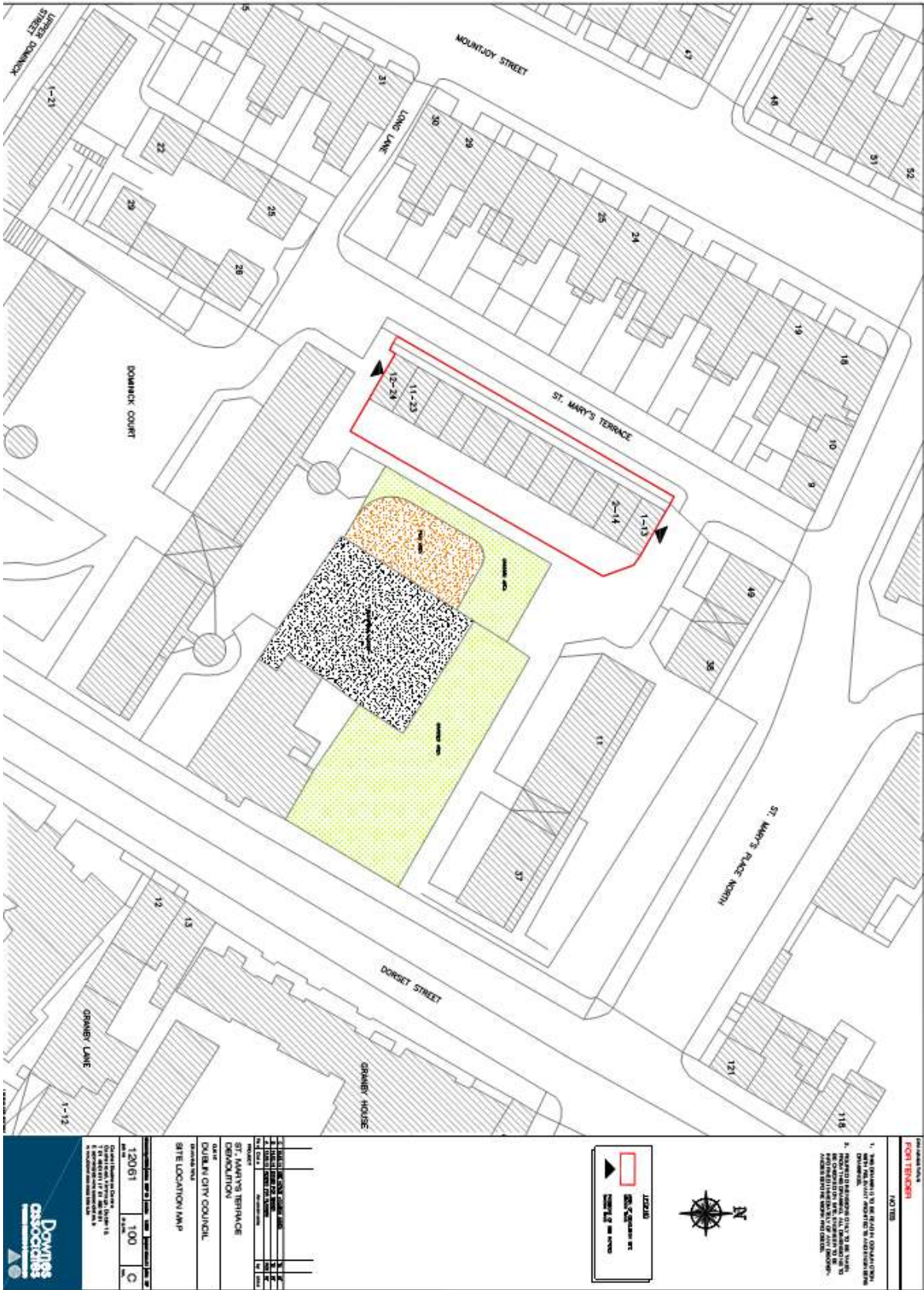

2nd July, 2014

To the Chairperson and Members of
The Central Area Committee.

With reference to the the proposed amalgamation of 68 no. bedsits and refurbishment of 1 no. 1-bed apartment, into 35 no. 1-bed apartments at the Senior Citizens Complex, St. Bricin's Park, (Block 1, nos. 27 – 50, Block 2, nos. 51 – 72, and Block 3, nos. 73 – 96), Arbour Hill, Dublin 7. - in compliance with the provisions of the Local Government Act 2001 and Part 8 of the Planning and Development Regulations 2001 as amended

In compliance with the provisions of the Local Government Act 2001 and Part 8 of the Planning and Development Regulations 2001 as amended, I hereby notify you that it is Dublin City Council's intention to carry out the following works:-

The proposed amalgamation of 68 no. bedsits and refurbishment of 1 no. 1-bed apartment, into 35 no. 1-bed apartments at the Senior Citizens Complex, St. Bricin's Park, (Block 1, nos. 27 – 50, Block 2, nos. 51 – 72, and Block 3, nos. 73 – 96), Arbour Hill, Dublin 7. The amalgamation of the apartments results in a new overclad and insulated North-East facing elevation. The South-West elevation has minor alterations incorporating the existing balcony spaces into new bedrooms and winter gardens. There are minor external works for the provision of level access to all ground floor apartments. There are no proposed works to the existing community facility.

(A) The Site

In the Dublin City Development Plan 2011 – 2017 the site is zoned Z1 – To protect, provide and improve residential amenities

The site has a stated area of 0.4634 hectares and is located in St. Bricin's Park, a residential area off Arbour Hill.

The buildings comprise 3 parallel 2-storey terraces of housing units in an open landscaped setting. There is deck access to the 1st floor units from staircases at each end. The terraces are clad in brick, with tiled pitched roofs.

Each block typically contains 24 small bedsit units, each 24sq.m. The units at 1st floor level have balconies, and the ground floor units have a terrace.

There is an existing Community Centre at the south-eastern end of Block 2 which is located

in 2 of the ground floor units which were adapted and extended in the past. There is one existing 1-bed unit in Block 2

The total number of existing units is 68 bedsits and 1 no 1-bed unit.

There are 2 vehicular access routes off St. Bricin's Park. The complex has 8 existing car parking spaces, 4 between Blocks 1 and 2, and 4 between blocks 2 and 3. There are drying facilities and designated bin areas between the blocks, and tarmac surfaces throughout.

(B) The Proposal

The Part 8 Planning Application is a proposal to amalgamate each two bedsit units into one 1-bedroom unit. The existing 68 bedsits and one 1-bed unit will therefore provide for 35 1-bed units. The stated area for the units is 54.2sq.m. The revised internal layouts are fully accessible.

This is a popular Senior Citizen's Complex in a quiet cul-de-sac. A summary of the proposed works is as follows:-

- Removal of internal non-loadbearing partitions and all services
- Provision of new fire doors and fire detectors / alarms
- Insulation of walls, attic and ground floor slab together with soffits of access decks
- New energy efficient boilers and controls
- Installation of extract ventilation and humidity vents to bathrooms and kitchens
- New double-glazed south-facing wintergarden windows.

It is proposed to construct a railed entrance deck on each block providing level access into the ground floor units. A new ramp on each block is to provide access to the entrance deck.

(C) Submissions

The proposal was advertised in the Irish Times 2nd May 2014. The closing date for submissions or observations was Tuesday 1st July 2014. No submissions or observations were received.

(D) Evaluation

In the Dublin City Development Plan 2011 – 2017 the site is zoned Z1 – To protect, provide and improve residential amenities.

Interdepartmental Reports

An observation from the Roads and Traffic Planning Division notes that a car parking space is to be designated as a disabled space and has no objection to the proposal

Appropriate Assessment Screening

Appropriate Assessment was introduced by Article 6(3) of the Habitats Directive and is essentially a tool to determine if a plan or project is likely to have a significant effect on a designated Natura 2000 site. The nearest Natura sites are located at Dublin Bay at the eastern end of the city.

Owing to a combination of significant distance from any Natura 2000 site, the existing connections to the city drainage system, and the nature of the proposed development i.e. a reduction in the number of housing units from 68 to 35, there is no significant potential for direct, indirect, or cumulative impact on these identified Natura 2000 sites. As such an Appropriate Assessment is not required for the development.

Assessment

The location is in a quiet landscaped area, which has passive supervision from the surrounding 2-storey houses.

The existing units are substandard in terms of size and thermal performance and are not accessible. The proposed units will provide very high quality accommodation. The proposal is an excellent example of sustainable refurbishment of the City Council's housing stock.

The works primarily impact existing structures and do not include for proposed alterations to the setting surrounding them. It is considered that there is potential to provide for some planter areas and outdoor seating which would enhance the amenity of the complex for the residents. These could easily be incorporated in the tarmac areas no longer in use as drying yards.

Recommendation:

The proposed development has been assessed and it is considered that it would be consistent with the Dublin City Development Plan 2011 – 2017 and with the proper planning and sustainable development of the area. Therefore, the Planner recommends that the proposed development should proceed having regard to the following recommendations and considerations:

1. An amenity area incorporating planters and seating shall be provided in each of the former drying yards located between the blocks in consultation with the Parks and Landscape Services Division.

Reason: In the interests of the amenities of the residents

2. (a) The site and building works required to implement the development shall only be carried out between the hours of:

Mondays to Fridays - 7.00am to 6.00pm

Saturday - 8.00 a.m. to 2.00pm

Sundays and Public Holidays - No activity on site.

(b) Deviation from these times will only be allowed in exceptional circumstances where prior written approval has been received from Dublin City Council. Such approval may be given subject to conditions pertaining to the particular circumstances being set by Dublin City Council.

Reason: In order to safeguard the amenities of adjoining residential occupiers.

This report is submitted to the Central Area Committee for approval.

If this proposal is agreed at Area Committee it is intended that a further report will be brought to the City Council meeting in September 2014 in compliance with the provisions of the Local Government Act 2001 and Part 8 of the Planning and Development Regulations 2001 as amended.

Gerry Geraghty

Executive Manager

Notes:
 1. DO NOT SCALE FROM THIS DRAWING.
 2. WORK ONLY FROM FIGURED DIMENSIONS. ALL DIMENSIONS TO BE REPORTED TO THE ARCHITECT.
 3. THIS DRAWING IS TO BE READ IN CONJUNCTION WITH ALL OTHER DRAWINGS.

Legend:
 - - - - - Level Lines
 - - - - - DEC LANDS
 - - - - - LAND WHERE WORKS ARE TAKING PLACE

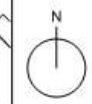

| | |
|--|------------|
| A. Issue and Part | |
| NO. | DATE |
| 1 | 10/10/2014 |
| PREPARED BY: [Name] CHECKED BY: [Name] APPROVED BY: [Name] | |

Dublin City Council
 COUNCIL OF ARCHITECTS AND PLANNERS
CITY ARCHITECTS DIVISION
 RAHWINDO BUILDING, 10A, BATHURST STREET
 DUBLIN 2, DUBLIN
 TEL: 01 224 2244 FAX: 01 224 2245
 WWW.DUBLINCITYCOUNCIL.IE

PROJECT NO: 15/16/0014
 PROJECT DESCRIPTION: ST BRICIN'S PARK
 CLIENT: DUBLIN CITY COUNCIL
 DATE: 10/10/2014
 DRAWN BY: AL

Site Plan
 CA1311 P03 A

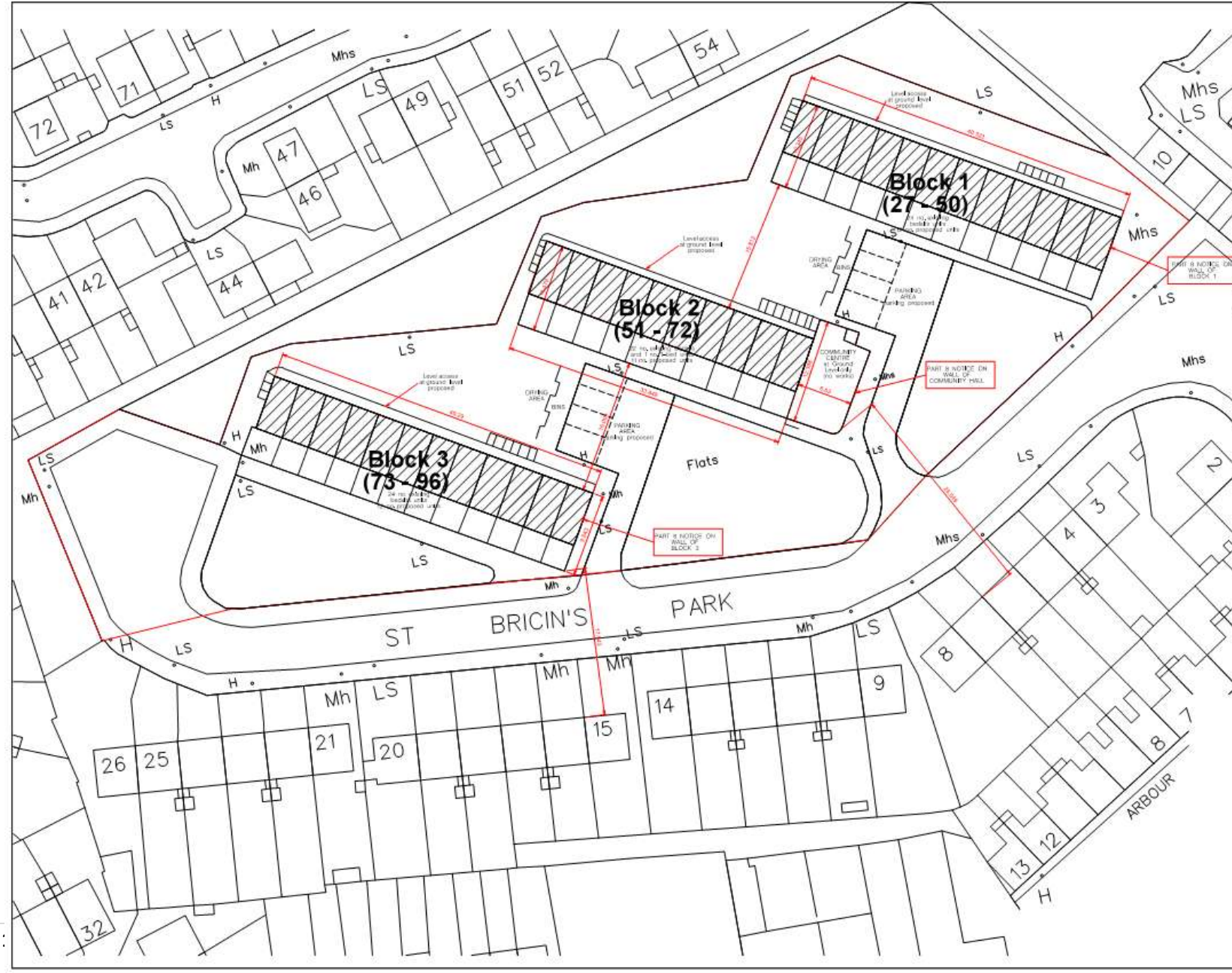

27th May 2014

**To The Chairperson and Members of
Central Area Committee**

With further reference to the proposed grant of a licence of land for a community garden at the rear of Summer Street North / Sean O'Casey Avenue, Dublin 1.

Dublin City Council at its meeting on 10th September 2012 approved the grant of a licence of a plot of land at the rear of Summer Street North and Sean O'Casey Avenue, Dublin 1 which said plot is more particularly delineated on Map Index No. 17505 to Representatives of the Summer Street North Residents Committee for use as a community garden for a term of 2 years commencing on 7th November 2012 and subject to a licence fee of €200.

This licence expires on 6th November 2014. The Area Manager has no objection to the licence being renewed and accordingly it is proposed to grant a further two year licence of the land at Summer Street North to Mr Kevin Downey and Mr Garvan Gallagher on behalf of the Summer Street North Residents Committee subject to the terms and conditions:

1. The licence shall be for a period of two years from 7th November 2014.
2. The land shall be used solely as a community gardening facility.
3. The land may be used between the hours of 9am and 5pm daily during the winter months and from 9am to 9pm during the summer months.
4. The Council is entitled to terminate the licence at any time (upon giving one months notice).
5. The licence fee shall be €200.00 payable in advance
6. The licensee shall be responsible for fully insuring the property and shall indemnify Dublin City Council against any and all claims arising from its use of the property. Public Liability insurance in the amount of €6.4 million shall be required.
7. The licensee shall not sublet or part with possession of the property or part thereof without obtaining the written consent of the City Council.
8. The licensee will be responsible for the maintenance and upkeep of the property and any boundary treatments.
9. Existing access rights of the residents whose properties back onto the land shall not be compromised and walkways kept clear.

10. The licensee will be responsible for ensuring that the access points to the property are secured appropriately and that the gate onto Summer Street North is kept closed.
11. The licensee must comply with the manufacturer's recommendations in the use of any chemical herbicide or pesticide and take all necessary safety precautions to ensure that the gardeners, Council staff and members of the public are not exposed to the effects of chemicals used.
12. The licensee shall comply with Health and Safety laws and exercise a "Duty of Care" towards themselves and the general public.
13. Any outgoings which may be charged on the land, such as rates, taxes etc. shall be the responsibility of the licensee.
14. The licensee shall not erect any buildings or structures whatsoever on the land.
15. The licensee shall be responsible for the removal of all weeds from the land.
16. That the licensee shall be required to sign a Deed of Renunciation in respect of the licensed area.
17. Each party shall be responsible for its own legal costs in this matter.
18. The licence will be subject to any other terms and conditions deemed appropriate by the Council's Law Agent.
19. Should the property cease to be used for community gardening purposes it will revert free of charge to Dublin City Council.
20. The disposal shall be subject to such conditions as to title to be furnished as the Law Agent in his discretion shall stipulate.

Jim Keogan

Executive Manager

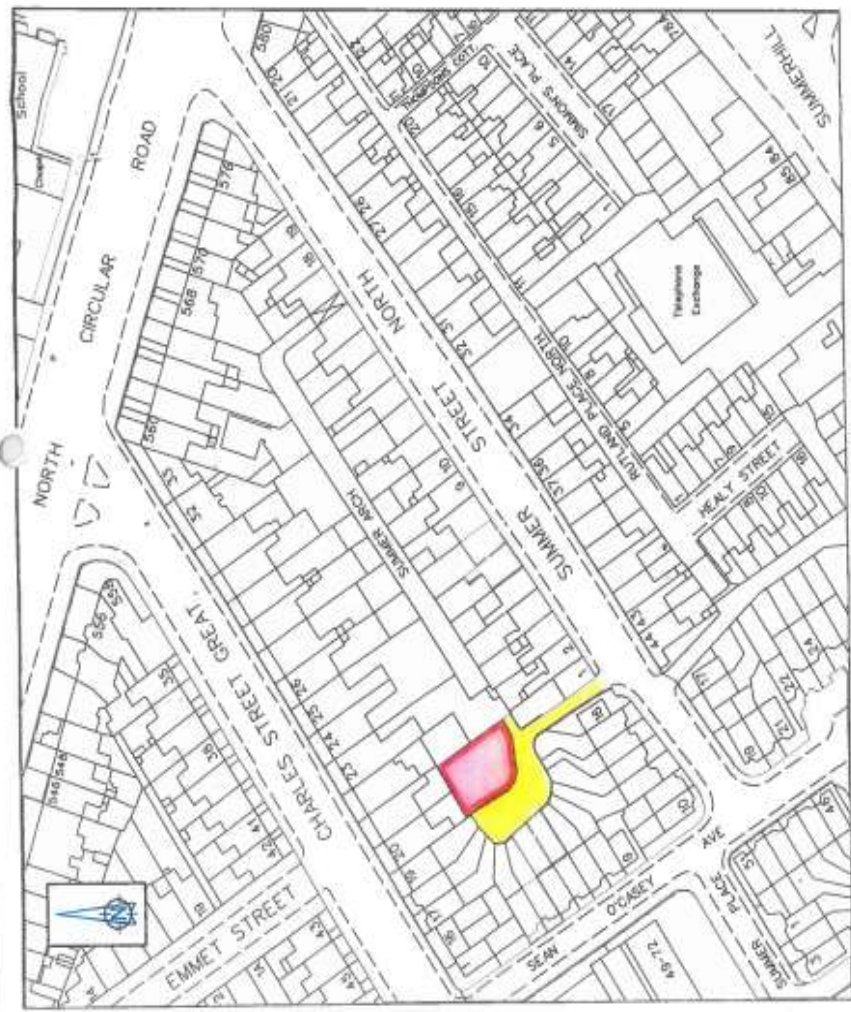

LOCATION MAP Scale 1:1000

LAND AT REAR OF SUMMER STREET NORTH
 2 YEAR LICENCE TO KEVIN DOWNEY AND GARVAN GALLAGHER ON
 BEHALF OF THE SUMMER STREET NORTH RESIDENTS COMMITTEE



LICENCE AREA

ACCESS TO LICENCE AREA

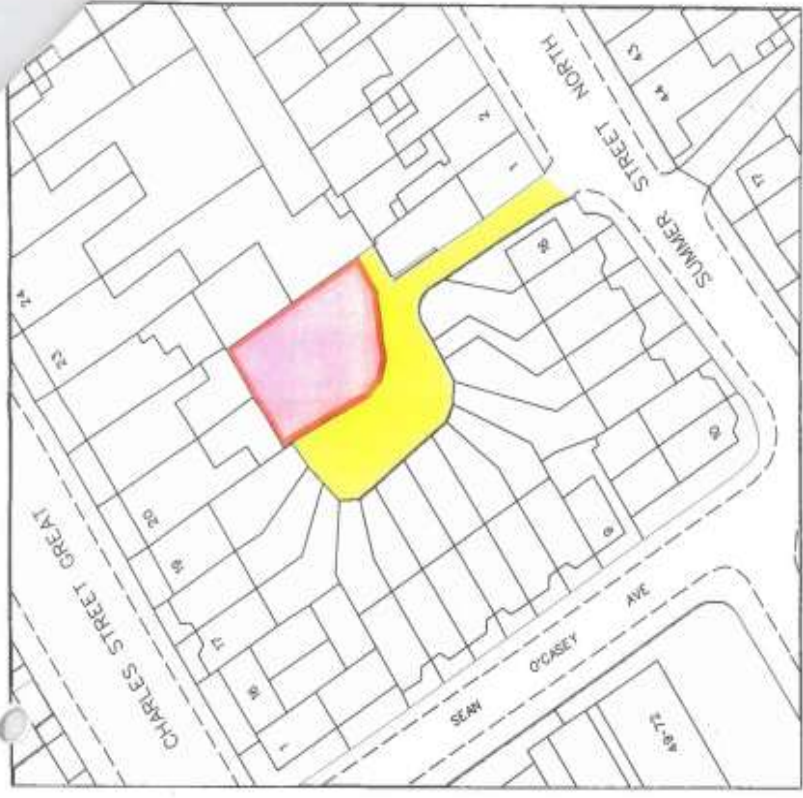

ENLARGEMENT Scale 1:600

DUBLIN CITY COUNCIL
 Comhairle Cathrach Bhaile Atha Cliath
 ENVIRONMENT AND ENGINEERING DEPARTMENT
 An Roinn Comhshaoil agus Inneoinéireachta
SURVEY AND MAPPING SERVICES DIVISION
 Roinnán Scrúdaí Suirbhéireachta agus Léarscáilithe



| | | | |
|-------------------------|----------------------------|---------|-----------|
| Drawn By M. PHILIPPS | Produced By M. PHILIPPS | SCALE | INDEX No. |
| CITY ENGINEER | | 1:600 | 17505 |
| DATE 03.08.2005 | | 1:10000 | |
| FC | | | |

If OGS data included: © Ordnance Survey Ireland. All rights reserved. Licence Number 2000 20732326/Dublin City Council

**Development Department,
Derelict Sites Section,
Block 3, Floor 2,
Civic Offices.**

25th June, 2014

**To the Chairperson and Members of
The Central Area Committee**

Derelict Sites Quarterly Report

I attach details of sites in the Central Area currently under review, together with a list of the sites in the area currently entered on the Derelict Sites Register.

**Jim Keogan
Executive Manager**

Sites on Derelict Sites Register in Central Area

| Address: | Entered | Outstanding Levies |
|--|----------------|---------------------------|
| Ballybough Road 22b, D3 | 25/06/2009 | €5,760.00 |
| Fairfield Road 19A, D9 | 02/12/2011 | €19,148.00 |
| Frederick Street North 30, D1 | 24/03/2011 | €15,638.00 |
| Great Charles Street 32, D1 | 15/08/2011 | €10,463.00 |
| Hawthorn Avenue, 1, East Wall, D3 | 12/11/2003 | €71,800.00 |
| Oxmantown Lane, (rear 6-11 Hendrick Street), D7 | 21/12/2010 | €5,940.00 |
| Poplar Row 14A, D3 | 20/07/2012 | €3,075.00 |
| Terrace Place (6), rear 23 Rutland St., D1 (Owner unknown) | 20/10/2008 | €14,260.00 |
| Terrace Place (7), rear 24 Rutland St., D1 (Owner unknown) | 18/04/2008 | €14,290.00 |
| Terrace Place (8), rear 25 Rutland St., D1 | 18/04/2008 | €18,160.00 |
| Nelson Street 8, D7 | 12/09/2013 | €5,300.00 |

DERELICT SITES QUARTERLY REPORT CENTRAL

Location

Current Position

Dublin 1

Abbey Street Lower 28 /
109 Marlborough Street

Notice served of intention to enter on Derelict Sites Register

Seville Place 45

Owner requested to cut back overgrowth.

Dublin 3

Church Road / East Wall Road (Cahill's) Litter removed as requested.

Church Road 118

Receiver requested to remove litter in front garden.

Church Road 130

Owner requested to cut back vegetation.

Whitworth Place 4

Ownership details requested from Law Department.

Dublin 7

Annamoe Terrace 11

On Derelict Sites Register since March 2014.

Brunswick Street North 100-102 /
Church Street 114-116

Owner requested to cut back overgrowth

Dublin 7 (contd.)

Location

Current Position

| | |
|------------------------------------|---|
| Navan Road 132-134 / Nephin Road | Notice served of intention to enter on DS Register. |
| North Circular Road 310 | Refurbishment commenced following service of DS Notice. |
| Phibsborough Road 113 / 113A | Work carried out following service of DS Notice. |
| Prussia Street 24-25 | Work carried out following service of DS Notice. |
| Bannow Road (Dublin Discount Club) | Owner requested to remove overgrowth and litter. |
| Blessington Street 23 | Some work carried out - being kept under review. |
| Broombridge Road 32 | Letter issued to solicitor. |
| Grangegorman Upper (rear 232 NCR) | Ownership details requested from Law Department. |
| Innisfallen Parade 3 | Ownership details requested from Law Department. |
| Kirwan Street 20 | Ownership details requested from Law Department. |
| Kirwan Street 23 | Owner requested to carry out repair works. |
| Kirwan Street 24 | Owner requested to carry out repair works. |
| Kirwan Street 5 | Owner requested to carry out repair works. |

Location

Current Position

Dublin 7 (contd.)

Phibsboro Road 197-198

ESB requested to clear site.

Manor Street 30

Owner requested to remove graffiti and repair window.

Manor Street, rear 26-29

Notice served requiring removal of overgrowth, litter etc.

Dublin 9

Prospect Avenue 50

Warning letter issued to owner.

Minutes of Traffic Advisory Group meeting held on 27/05/14

| Item | Request Category | Ref | Road | Post-code | Topic | Request Description | Request by | TAG Result | TAG Comments | S e c | Date Rec'd |
|------|-----------------------|-------|---------------------------|-----------|------------------------|--|-----------------|-----------------|--|-------|-------------|
| 1 | Pedestrian Facilities | 8535 | CAPEL STREET (C-EA) | D1 | Zebra Crossing | at the junction of Parnell Street and Little Britain Street. | cllr | Not Recommended | Any changes to the layout of this junction would be premature pending completion of the Luas Cross City associated North City Traffic Management works. | 4 | 04/09 /2013 |
| 2 | Parking Prohibitions | 11292 | CONYNGHAM ROAD (C-EA) | D8 | Clearway (Amend Hours) | to rescind the morning clearway. | resident | Not Recommended | It is not recommended to remove the morning clearway from this location. | 0 | 24/03 /2014 |
| 3 | Miscellaneous | 12149 | DOMINICK PLACE NEW (C-EA) | D1 | Multiple | No Entry/Stop Sign and Double Yellow Lines as part of new link road associated with LUAS Cross City. | dcc traffic mgt | Recommended | 1. No Entry, on Dominick Place New, at its junction with Dominick Street Lower, facing south west. 2. Stop Sign, on Dominick Place New, at its junction with Dominick Street Lower, facing north east. 3. Double Yellow Lines, on Dominick Place New, from its junction with Dominick Street, to its junction with Dominick Place Granby Lane. | 0 | 06/05 /2014 |

| | | | | | | | | | | | |
|---|----------------------|-------|-------------------------|----|---------------------|------------------------------------|-----------------|-----------------|---|---|-------------|
| 4 | Traffic Signs | 10559 | HILL STREET (C-EA) | D1 | 3 Tonne Limit | at the junction of Parnell Street. | dcc area office | Recommended | Recommended to install a 3t ban on Hill St, from it's junction with Parnell St and running North to it's junction with Gardiner Place. Recommended to install RUS 015 (3.5t) facing South on Hill St at the junction with Parnell St. facing North on Hill St at the junction with Gardiner Place. facing East on Grenville St at the junction with Gardiner St | 0 | 05/02 /2014 |
| 5 | Parking Prohibitions | 12255 | LEIX ROAD (C-EA) | D7 | Double Yellow Lines | at the junction | cllr | Not Recommended | Under The Road Traffic (Traffic & Parking) Regulations, Section 36 paragraph(2) c; "A vehicle shall not be parked within 5 metres of a road junction; Infringements of the Act should be reported to the Gardai or Dublin Street Parking Services Ph.6022500 for enforcement under the law. This issue has been referred to Dublin Street Parking Services. | 0 | 13/05 /2014 |
| 6 | Parking Prohibitions | 11920 | MILLMOUNT AVENUE (C-EA) | D9 | Parking Prohibition | | resident | Recommended | Recommended to install double yellow lines from the south east corner of the junction of Millmount Ave and Millmount Terrace running 5m east and then | 0 | 24/04 /2014 |

| | | | | | | | | | | | |
|---|----------------------|-------|--------------------------|----|---------------------|-------------------------------------|----------|-----------------|---|---|-------------|
| | | | | | | | | | 2m north so as to meet the existing Double Yellow Lines on the south west corner of the junction of Millmount Ave and Drumcondra Road Upper. | | |
| 7 | Parking Prohibitions | 12050 | QUARRY ROAD (C-EA) | D7 | Double Yellow Lines | at the junction of Faussagh Avenue. | resident | Not Recommended | Under The Road Traffic (Traffic & Parking) Regulations, Section 36 paragraph(2) i; "A vehicle shall not be parked on a footway, a grass margin or a median strip;" It is not recommended to introduce parking restrictions where restrictions are already covered under the law, such as placing Double Yellow Lines along footpaths, as this would lead to a proliferation of same and additional expense due to maintenance etc. Infringements of the Act should be reported to the Gardai or Dublin Street Parking Services Ph.6022500 for enforcement under the law. This issue has been referred to Dublin Street Parking Services. | 0 | 29/04 /2014 |
| 8 | Traffic Conditions | 11827 | SAINT ANNE'S ROAD (C-EA) | D9 | Speed Ramps | on the road. | resident | Not Recommended | Due to the short length of St Anne's Rd and the restricted road width due to parking both sides and the build out at the road | 0 | 15/04 /2014 |

| | | | | | | | | | | | |
|----|----------------------|-------|----------------------------|----|--------------------------------|---|----------|-----------------|---|---|-------------|
| | | | | | | | | | entry from Drumcondra Rd Lwr the vast majority of vehicle speeds are well below the 50kph. As ramps are only effective at reducing speeds to a minimum of 50kph they are not recommended at this location. Instances of dangerous driving is a matter for enforcement and should be reported to An Garda Siochana. This issue has been referred to An Garda Siochana | | |
| 9 | Traffic Signs | 11828 | SAINT ANNE'S ROAD (C-EA) | D9 | Children Crossing Sign | on the road. | resident | Not Recommended | Dublin City Council does not generally recommend Children at Play signs as they have been shown to be ineffective at reducing speeds. The installation of "Children Crossing" signs is not recommended at this location. | 0 | 15/04 /2014 |
| 10 | Parking Prohibitions | 12295 | SAINT IGNATIUS ROAD (C-EA) | D7 | Pay & Display & Permit Parking | and rescindment of Disabled Parking Bay outside No. 56. | resident | Recommended | Recommended to rescind disabled parking bay on St Ignatius Road, south side, starting from the common boundary of property Nos. 56 and 57 and running west for 6m. Recommended to install Pay & Display & Permit parking operating Mon-Fri 08.00-18.30 at same location. | 0 | 13/05 /2014 |

| | | | | | | | | | | | |
|----|--------------------|-------|-------------------|----|-------------|----------------------------|----------|-----------------|--|---|-------------|
| 11 | Traffic Conditions | 11221 | STONE ROAD (C-EA) | D3 | Speed Ramps | on the road. | resident | Not Recommended | It is not recommended to install speed ramps at this location as the narrow nature of the road does not allow for vehicles to routinely exceed 50km/h and ramps are ineffective at reducing speeds below 50 km/h. Incidents of Dangerous and Reckless driving should be reported to An Garda Síochanna for enforcement under the law. This matter has been referred to An Garda Síochanna | 0 | 19/03 /2014 |
| 12 | Traffic Conditions | 12221 | WALSH ROAD (C-EA) | D9 | Speed Ramps | in the vicinity of No. 27. | cllr | Not Recommended | It is not recommended to install any additional ramps on Walsh Rd as the road already has ramps. | 0 | 12/05 /2014 |

Minutes of Traffic Advisory Group meeting held on 24th June, 2014

| Item | Request | Ref | Road | Post-code | Topic | Request Description | Request by | TAG Result | TAG Comments | S e c | Date Rec'd |
|------|----------------------|-------|--------------------------------|-----------|-------------------------|---|------------------|-------------|--|-------------|---------------|
| 1 | Parking Prohibitions | 12739 | CHURCH STREET NEW (C-EA) | D7 | Coach Parking (Rescind) | Relocation of Disabled Parking bay from north to south side of road to facilitate coach turning | dcc traffic mgt. | Recommended | Recommended to rescind 6m of Coach Parking on south eastern end of New Church St. Starting from a point 1m East of PLS #3 and running west for 6m. Recommended to install disabled parking bay at south eastern end of New Church St. Starting from a point 1m East of PLS #3 and running west for a distance of 6m (1.2m Buffer Zone at South Eastern end to be retained). Rescind Disabled Parking Bay (previously recommended though not installed) as follows: south east end, from 4.3 metres of PLS 3, westwards for 5m. | 0 | 10/06 /2014 |
| 2 | Parking Prohibitions | 12085 | CUMBERLAND STREET NORTH (C-EA) | D1 | Coach Parking | Westside, rescind pay and display parking between the junctions of Parnell Street and Britain Place and replace with Coach Parking. | dcc traffic mgt. | Recommended | Rescind Pay and Display parking on west side of Cumberland Street North, between Parnell Street and Britain Place, and replace with No Parking Except for Coaches operating 24hrs/7 days. | 0 | 01/05 /2014 |

| | | | | | | | | | | | |
|---|----------------------|-------|----------------------------|----|--|---|----------|-----------------|--|---|-------------|
| 3 | Parking Prohibitions | 12376 | DE COURCY SQUARE (C-EA) | D9 | Disabled Parking Bay (Rescind Residential) | outside No. 36. Pay and Display and Permit Parking will have to be installed. | resident | Recommended | Recommended to rescind disabled parking bay on the south side of De Courcy Square South from the common boundary of Nos.35/36 and running west for 6m. Recommended to install Pay & Display & Permit parking at same location. | 0 | 08/05 /2014 |
| 4 | Traffic Conditions | 11866 | DORSET STREET UPPER (C-EA) | D1 | Yellow Box | at the junction of Bethesda Place. | cldr | Recommended | Recommended to install a yellow box on Dorset St Upper covering the two inbound lanes across the junction with Bethesda Place. | 1 | 16/04 /2014 |
| 5 | Traffic Conditions | 12809 | FOSTER TERRACE (C-EA) | D2 | Traffic Calming | Request for additional traffic calming measures. | t.d. | Not Recommended | Due to the presence of parked vehicles further narrowing the effective road width and the presence of speed ramps; it is not recommended to introduce further traffic calming measures at this location. | 0 | 12/06 /2014 |
| 6 | Parking Prohibitions | 12301 | MAYOR STREET LOWER (C-EA) | D1 | Loading Bay | reps for Loading Bay on Mayor Street Lower | business | Not Recommended | Under Section 5 (2)(e) of the ROAD TRAFFIC (TRAFFIC AND PARKING) REGULATIONS, 1997 http://www.irishstatutebook.ie/1997/en/si/0182.html#zsi182y1997a5 " a prohibition on the parking of a vehicle imposed by article 36(2)(a) (Double Yellow Lines) shall not apply to a vehicle parked while goods are being loaded in or on to it | 0 | 11/05 /2014 |

| | | | | | | | | | | | |
|---|----------------------|-------|-------------------------|----|--------------------------------|--------------|-----------------|-----------------|---|---|------------|
| | | | | | | | | | <p>or unloaded from it, for a period not exceeding thirty minutes from the commencement of the parking. "</p> <p>People making deliveries to the square should also be made aware of the contents of Section 36 of the same act, in particular parts (c),(g),(i) & (k) As there is multitude of Loading Bays along Mayor Street and suitable sections of Double Yellow Lines to allow loading at the rear of Mayor Square it is not recommended to install any additional loading bays.</p> | | |
| 7 | Admin | 11921 | MILLMOUNT AVENUE (C-EA) | D9 | Buildout | | resident | Recommended | A build out at this location has been added to a list of potential future works in the area. In the meantime it has been recommended to install Double Yellow Lines at this location so as to make it an offence to park at this location. After the installation of the Double Yellow Lines the issue will be monitored and reviewed. | 0 | 24/04/2014 |
| 8 | Parking Prohibitions | 9994 | MILLMOUNT PLACE (C-EA) | D9 | Pay & Display & Permit Parking | on the road. | resident | Recommended | Accepted at ballot, hours Mon-Fri 07.00-19.00. 23 on register of electors, 21 votes returned, 11 for, 7 against and 3 received late. | 0 | 18/12/2013 |
| 9 | Traffic Conditions | 12615 | QUARRY ROAD (C-EA) | D7 | Speed Ramps | on the road. | dcc area office | Not Recommended | There is no record of any previous recommendations | 0 | 28/05/2014 |

| | | | | | | | | | for ramps to be installed on Quarry Road and there are no plans to introduce ramps on Quarry Road at this time. | | |
|------|-----------------------|-------|---------------------------|-----------|------------------------|--|-----------------|-----------------|--|-------|------------|
| | | | | | | Central Area Agenda from May TAG 27/05/14 | | | | | |
| Item | Request Category | Ref | Road | Post-code | Topic | Request Description | Request by | TAG Result | TAG Comments | S e c | Date Rec'd |
| 1 | Pedestrian Facilities | 8535 | CAPEL STREET (C-EA) | D1 | Zebra Crossing | at the junction of Parnell Street and Little Britain Street. | cllr | Not Recommended | Any changes to the layout of this junction would be premature pending completion of the Luas Cross City associated North City Traffic Management works. | 4 | 04/09/2013 |
| 2 | Parking Prohibitions | 11292 | CONYNGHAM ROAD (C-EA) | D8 | Clearway (Amend Hours) | to rescind the morning clearway. | resident | Not Recommended | It is not recommended to remove the morning clearway from this location. | 0 | 24/03/2014 |
| 3 | Miscellaneous | 12149 | DOMINICK PLACE NEW (C-EA) | D1 | Multiple | No Entry/Stop Sign and Double Yellow Lines as part of new link road associated with LUAS Cross City. | dcc traffic mgt | Recommended | 1. No Entry, on Dominick Place New, at its junction with Dominick Street Lower, facing south west. 2. Stop Sign, on Dominick Place New, at its junction with Dominick Street Lower, facing north east. 3. Double Yellow Lines, on Dominick Place New, from its junction with Dominick Street, to its junction with Dominick Place Granby Lane. | 0 | 06/05/2014 |
| 4 | Traffic Signs | 10559 | HILL STREET (C-EA) | D1 | 3 Tonne Limit | at the junction of Parnell Street. | dcc area office | Recommended | Recommended to install a 3t ban on Hill St, from it's junction with Parnell St and running North to it's | 0 | 05/02/2014 |

| | | | | | | | | | | | |
|---|----------------------|-------|-------------------------|----|---------------------|-----------------|----------|-----------------|--|---|-------------|
| | | | | | | | | | junction with Gardiner Place. Recommended to install RUS 015 (3.5t) facing South on Hill St at the junction with Parnell St. facing North on Hill St at the junction with Gardiner Place. facing East on Grenville St at the junction with Gardiner St | | |
| 5 | Parking Prohibitions | 12255 | LEIX ROAD (C-EA) | D7 | Double Yellow Lines | at the junction | cllr | Not Recommended | Under The Road Traffic (Traffic & Parking) Regulations, Section 36 paragraph(2) c; "A vehicle shall not be parked within 5 metres of a road junction; Infringements of the Act should be reported to the Gardai or Dublin Street Parking Services Ph.6022500 for enforcement under the law. This issue has been referred to Dublin Street Parking Services. | 0 | 13/05 /2014 |
| 6 | Parking Prohibitions | 11920 | MILLMOUNT AVENUE (C-EA) | D9 | Parking Prohibition | | resident | Recommended | Recommended to install double yellow lines from the south east corner of the junction of Millmount Ave and Millmount Terrace running 5m east and then 2m north so as to meet the existing Double Yellow Lines on the south west corner of the junction of | 0 | 24/04 /2014 |

| | | | | | | | | | | | |
|---|----------------------|-------|--------------------------|----|---------------------|-------------------------------------|----------|-----------------|---|---|-------------|
| | | | | | | | | | Millmount Ave and Drumcondra Road Upper. | | |
| 7 | Parking Prohibitions | 12050 | QUARRY ROAD (C-EA) | D7 | Double Yellow Lines | at the junction of Faussagh Avenue. | resident | Not Recommended | Under The Road Traffic (Traffic & Parking) Regulations, Section 36 paragraph(2) i; "A vehicle shall not be parked on a footway, a grass margin or a median strip;" It is not recommended to introduce parking restrictions where restrictions are already covered under the law, such as placing Double Yellow Lines along footpaths, as this would lead to a proliferation of same and additional expense due to maintenance etc. Infringements of the Act should be reported to the Gardai or Dublin Street Parking Services Ph.6022500 for enforcement under the law. This issue has been referred to Dublin Street Parking Services. | 0 | 29/04 /2014 |
| 8 | Traffic Conditions | 11827 | SAINT ANNE'S ROAD (C-EA) | D9 | Speed Ramps | on the road. | resident | Not Recommended | Due to the short length of St Anne's Rd and the restricted road width due to parking both sides and the build out at the road entry from Drumcondra Rd Lwr the vast majority of vehicle speeds are well below the 50kph. As ramps | 0 | 15/04 /2014 |

| | | | | | | | | | | | |
|----|----------------------|-------|----------------------------|----|--------------------------------|---|----------|-----------------|---|---|-------------|
| | | | | | | | | | are only effective at reducing speeds to a minimum of 50kph they are not recommended at this location. Instances of dangerous driving is a matter for enforcement and should be reported to An Garda Siochana. This issue has been referred to An Garda Siochana | | |
| 9 | Traffic Signs | 11828 | SAINT ANNE'S ROAD (C-EA) | D9 | Children Crossing Sign | on the road. | resident | Not Recommended | Dublin City Council does not generally recommend Children at Play signs as they have been shown to be ineffective at reducing speeds. The installation of "Children Crossing" signs is not recommended at this location. | 0 | 15/04 /2014 |
| 10 | Parking Prohibitions | 12295 | SAINT IGNATIUS ROAD (C-EA) | D7 | Pay & Display & Permit Parking | and rescindment of Disabled Parking Bay outside No. 56. | resident | Recommended | Recommended to rescind disabled parking bay on St Ignatius Road, south side, starting from the common boundary of property Nos. 56 and 57 and running west for 6m. Recommended to install Pay & Display & Permit parking operating Mon-Fri 08.00-18.30 at same location. | 0 | 13/05 /2014 |
| 11 | Traffic Conditions | 11221 | STONE ROAD (C-EA) | D3 | Speed Ramps | on the road. | resident | Not Recommended | It is not recommended to install speed ramps at this location as the narrow nature of the road does not | 0 | 19/03 /2014 |

| | | | | | | | | | | | |
|----|--------------------|-------|-------------------|----|-------------|----------------------------|------|-----------------|---|---|-------------|
| | | | | | | | | | allow for vehicles to routinely exceed 50km/h and ramps are ineffective at reducing speeds below 50 km/h. Incidents of Dangerous and Reckless driving should be reported to An Garda Siochanna for enforcement under the law. This matter has been referred to An Garda Siochanna | | |
| 12 | Traffic Conditions | 12221 | WALSH ROAD (C-EA) | D9 | Speed Ramps | in the vicinity of No. 27. | cllr | Not Recommended | It is not recommended to install any additional ramps on Walsh Rd as the road already has ramps. | 0 | 12/05 /2014 |

Traffic Service Requests, Status Report at 15th June, 2014, for Central Area Committee Meeting on 8th July, 2014.

Traffic Advisory Group (TAG) Service Request Statistics

| | |
|--|-----|
| Total TAG Requests received Central Area From 1 st Jan, 2013 – 15 th June, 2014 | 492 |
| Requests Completed between 1 st Jan, 2013 – 15 th June, 2014 | 337 |
| Requests received (16 th May, 2014 – 15 th June, 2014) | 29 |
| Total Requests currently on Sharepoint | 155 |
| Breakdown of Requests currently on Sharepoint | |
| Stage 1 | 6 |
| Stage 2 | 55 |
| Stage 3 | 6 |
| Stage 4 | 68 |
| Stage 5 | 20 |

Non TAG Service Requests Statistics

| | |
|--|-----|
| Total Non- TAG Requests received South East Area From 1/1/2013 – 15/06/2014 | 786 |
| Requests Completed | 655 |
| Requests currently on Sharepoint | 131 |

Traffic Advisory Group Status Reports

Explanation of Stages:

- Stage 1 - Set up file, Assignment to Engineer, etc
- Stage 2 - Assessment, Site surveys, review statutory orders, etc

- Stage 3 - Consultations, with Garda, Dublin Bus, LUAS, NTA, Local residents / businesses, etc
- Stage 4 - Decision, TAG group, statutory orders, etc

| Item No. | SR No. | Road | Postcode | Topic | Request Description | Date Received | SR Status |
|----------|--------|--------------------------|----------|--|---|---------------|-----------|
| 1 | 5682 | CHURCH STREET (C-EA) | D7 | Pedestrian Crossing | At junction with LUAS tracks on southern side of LUAS tracks | 08/01/2013 | Stage 4 |
| 2 | 5793 | FAUSSAGH AVENUE (C-EA) | D7 | Traffic Calming | at Gaelscoil Bharra | 14/01/2013 | Stage 4 |
| 3 | 6001 | STONEYPATTER (C-EA) | D7 | Yellow Box | at the junction of Stoneybatter and Arbour Place. | 24/01/2013 | Stage 4 |
| 4 | 6328 | RIVER ROAD (C-EA) | D15 | Speed Ramps | additional Ramp around the corner from Pelletstown Manor. | 25/02/2013 | Stage 3 |
| 5 | 7188 | ARD RI PLACE (C-EA) | D7 | Pay & Display & Permit Parking (change of hours) | extension of hours. | 14/05/2013 | Stage 5 |
| 6 | 7610 | EMMET STREET (C-EA) | D1 | One-Way System | on Emmet Street. | 11/06/2013 | Stage 4 |
| 7 | 7925 | JERVIS STREET (C-EA) | D1 | Clearway (Rescind) | Rescind Clearway on Jervis Street | 08/07/2013 | Stage 3 |
| 8 | 7941 | KILKIERAN ROAD (C-EA) | D7 | Traffic Calming | at the junction of Kilkiernan Road and Killala Road. | 09/07/2013 | Stage 4 |
| 9 | 7953 | NEWCOMEN AVENUE (C-EA) | D3 | Double Yellow Lines | at the entrance to the road. | 09/07/2013 | Stage 4 |
| 10 | 8033 | CHURCH STREET NEW (C-EA) | D7 | Double Yellow Lines | Relocate Disabled Parking Bay and provide double yellow lines. | 16/07/2013 | Stage 5 |
| 11 | 8218 | RIVER ROAD (C-EA) | D15 | Speed Ramps | on the Finglas side of the bend at Pelletstown Manor. | 01/08/2013 | Stage 3 |
| 12 | 8263 | IONA ROAD (C-EA) | D9 | Traffic Island | Request for traffic island or build out at the junction of Crawford Avenue. | 08/08/2013 | Stage 5 |
| 13 | 8417 | CHURCH STREET (C-EA) | D11 | Right Turn Filter Light | from Church Street onto King Street North. | 23/08/2013 | Stage 2 |
| 14 | 8535 | CAPEL STREET (C-EA) | D1 | Zebra Crossing | at the junction of Parnell Street and Little Britain Street. | 04/09/2013 | Stage 4 |
| 15 | 8565 | CAPEL STREET (C-EA) | D1 | Zebra Crossing | at the junction of Parnell Street and Little Britain Street. | 06/09/2013 | Stage 4 |
| 16 | 8664 | KING STREET NORTH (C-EA) | D7 | Traffic Calming | at the junction of Queen Street. | 12/09/2013 | Stage 2 |

| | | | | | | | |
|----|------|----------------------------------|----|--|---|------------|---------|
| 17 | 8665 | OLD CABRA ROAD (C-EA) | D7 | Traffic Calming | at the junction of North Circular Road/Old Cabra Road/Prussia Street, at Hanlon's Corner. | 12/09/2013 | Stage 2 |
| 18 | 8673 | SAINT PATRICK'S ROAD (C-EA) | D9 | No Left Turn | from St. Patrick's Road onto Whitworth Road, during morning peak. | 12/09/2013 | Stage 4 |
| 19 | 8674 | SAINT BRIGID'S ROAD LOWER (C-EA) | D9 | No Left Turn | from St. Brigid's Road Lower onto Whitworth Road, during morning peak. | 12/09/2013 | Stage 4 |
| 20 | 8772 | SAINT PATRICK'S ROAD (C-EA) | D9 | No Left Turn | from St. Patrick's Road onto Whitworth Road, during morning peak. | 20/09/2013 | Stage 4 |
| 21 | 8790 | CAPEL STREET (C-EA) | D1 | Zebra Crossing | at the junction of Parnell Street and Little Britain Street. | 07/10/2013 | Stage 4 |
| 22 | 8791 | CAPEL STREET (C-EA) | D1 | | Request for a Traffic Management Plan at the junction of Capel Street and Parnell Street. | 07/10/2013 | Stage 2 |
| 23 | 8831 | RATOATH ROAD (C-EA) | D7 | Pedestrian Crossing | Request for pedestrian crossing on Ratoath Road, Cabra, in the vicinity of the Schools. | 25/09/2013 | Stage 4 |
| 24 | 8931 | STRAND STREET GREAT (C-EA) | D1 | Pay & Display & Permit Parking (Rescind) | To facilitate a bike station for the Dublin Bike Scheme. | 02/10/2013 | Stage 5 |
| 25 | 9016 | LEIX ROAD (C-EA) | D7 | Children Crossing Sign | Request for children crossign sign on Leix Road. | 08/10/2013 | Stage 4 |
| 26 | 9018 | CAPEL STREET (C-EA) | D1 | Zebra Crossing | at the junction of Parnell Street and Little Britain Street. | 08/10/2013 | Stage 4 |
| 27 | 9022 | CAPEL STREET (C-EA) | D1 | Zebra Crossing | at the junction of Parnell Street and Little Britain Street. | 08/10/2013 | Stage 4 |
| 28 | 9042 | PARNELL STREET (C-EA) | D1 | Pedestrian Crossing | on Parnell Street at the junction of Jervis Street. | 08/10/2013 | Stage 4 |
| 29 | 9133 | MAY STREET (C-EA) | D3 | Stop Sign | Request to review the 'Stop' line marking on May Street. | 18/10/2013 | Stage 4 |
| 30 | 9174 | AUGHRIM STREET (C-EA) | D7 | Double Yellow Lines | Between Nos. 66 & 67, Aughrim Street. | 23/10/2013 | Stage 5 |
| 31 | 9325 | RATOATH ROAD (C-EA) | D7 | Pedestrian Crossing | Request for pedestrian crossing on Ratoath Road, Cabra. | 08/10/2013 | Stage 4 |

| | | | | | | | |
|----|------|-----------------------------|-----|--|--|------------|---------|
| 32 | 9414 | EAST WALL ROAD (C-EA) | D3 | Yellow Box | on East Wall Road at the junction of East Road (at the Seabank Pub), heading towards Dublin Port. | 12/11/2013 | Stage 2 |
| 33 | 9421 | KILKIERAN ROAD (C-EA) | D7 | Traffic Calming | at the junction of Kilkiernan Road and Killala Road. | 12/11/2013 | Stage 4 |
| 34 | 9448 | BLACKHALL PLACE (C-EA) | D7 | Double Yellow Lines | To facilitate the servicing of a bike station under Phase 2 of the Dublin Bike Scheme. | 07/11/2013 | Stage 5 |
| 35 | 9534 | OLD FINGLAS ROAD (C-EA) | D11 | Coach Parking | Request to extend the existing 'Bus Coach' parking area outside St. Brigid's School, to be in line with opposite No. 32, Old Finglas Road. | 19/11/2013 | Stage 2 |
| 36 | 9536 | BALLYBOUGH ROAD (C-EA) | D3 | Yellow Box | On Ballybough Road at the junction of Clonmore Road, inbound lane. | 19/11/2013 | Stage 4 |
| 37 | 9577 | CLONLIFFE AVENUE (C-EA) | D3 | One-Way System | Request for one-way system on Clonliffe Avenue (see drawing attached) | 20/11/2013 | Stage 2 |
| 38 | 9599 | NORTH STRAND ROAD (C-EA) | D1 | Pay & Display Parking (change of hours) | Request to reduce the hours to the Pay and Display parking in front of No. 143 | 22/11/2013 | Stage 2 |
| 39 | 9601 | HALLIDAY SQUARE (C-EA) | D7 | Pay & Display & Permit Parking | on the road. | 21/11/2013 | Stage 4 |
| 40 | 9631 | EAST WALL ROAD (C-EA) | D3 | Yellow Box (Extend) | To cover both lanes | 25/11/2013 | Stage 2 |
| 41 | 9652 | SAINT MARY'S TERRACE (C-EA) | D7 | Pay & Display & Permit Parking (extension of area) | Request to extend Pay and Display and Permit Parking Bays on St Mary's Terrace. | 26/11/2013 | Stage 4 |
| 42 | 9717 | SUSANVILLE ROAD (C-EA) | D3 | Disabled Parking Bay (Residential) | outside No. 12. | 25/11/2013 | Stage 5 |
| 43 | 9769 | SAINT TERESA ROAD (C-EA) | D9 | Double Yellow Lines | On Saint Teresa Road from St. Teresa's Place to Botanic Road. | 03/12/2013 | Stage 4 |
| 44 | 9788 | NAVAN ROAD (C-EA) | D7 | Traffic Calming | at the Ashtown roundabout. | 04/12/2013 | Stage 2 |
| 45 | 9821 | EAST ROAD (C-EA) | D3 | Yellow Box (Extend) | to cover the entire entrance to the Hireco yard. | 06/12/2013 | Stage 2 |
| 46 | 9822 | SHERIFF STREET UPPER (C-EA) | D1 | Right Turn Filter Light | from Sheriff Street Upper onto East Road. | 06/12/2013 | Stage 4 |

| | | | | | | | |
|----|-------|----------------------------|-----|--|---|------------|---------|
| 47 | 9850 | CRAWFORD AVENUE (C-EA) | D9 | Pedestrian Crossing | on Crawford Avenue near the junction of Iona Road. | 06/12/2013 | Stage 2 |
| 48 | 9890 | MARY STREET LITTLE (C-EA) | D7 | Loading Bay | on the road. | 09/12/2013 | Stage 5 |
| 49 | 9921 | CRAWFORD AVENUE (C-EA) | D9 | Buildout | Following an inquest, the Coroner has requested road markings near the junction of Iona Road. | 06/12/2013 | Stage 5 |
| 50 | 9994 | MILLMOUNT PLACE (C-EA) | D9 | Pay & Display & Permit Parking | on the road. | 18/12/2013 | Stage 3 |
| 51 | 10048 | DRUMCONDRA PARK (C-EA) | D3 | Pay & Display & Permit Parking | on the road. | 03/01/2014 | Stage 3 |
| 52 | 10098 | EAST WALL ROAD (C-EA) | D3 | Yellow Box | opposite the Seabank House | 14/01/2014 | Stage 2 |
| 53 | 10130 | COMMONS STREET (C-EA) | D1 | Pay & Display Parking (Rescind) | Request to remove on-street car parking on Commons Street for improved local accessibility at peak hours. | 09/01/2014 | Stage 4 |
| 54 | 10185 | BALLYBOGGAN ROAD (C-EA) | D11 | Bus Lane (Removal) | on Ballyboggan Road | 14/01/2014 | Stage 2 |
| 55 | 10208 | ARD RI ROAD (C-EA) | D7 | Disabled Parking Bay (Rescind Residential) | Outside No. 7 and provide Pay and Display and Permit Parking. | 14/01/2014 | Stage 4 |
| 56 | 10243 | EAST WALL ROAD (C-EA) | D3 | Yellow Box | at the junction of East road. | 16/01/2014 | Stage 2 |
| 57 | 10403 | EAST WALL ROAD (C-EA) | D3 | Yellow Box (Extend) | to cover both sides of the road at Aldi. | 28/01/2014 | Stage 2 |
| 58 | 10430 | HALSTON STREET (C-EA) | D7 | Disabled Parking Bay (General) | Request for general use Disabled Parking Bays (x 2 requested) outside St. Michan's Church. | 30/01/2014 | Stage 2 |
| 59 | 10442 | SAINT IGNATIUS ROAD (C-EA) | D9 | Disabled Parking Bay (Residential) | Outside No. 48. Pay and Display and Permit Parking will have to be rescinded. | 30/01/2014 | Stage 4 |
| 60 | 10464 | LIFFEY STREET WEST (C-EA) | D7 | Parking Prohibition | Provide additional Pay and Display and Permit Parking. | 30/01/2014 | Stage 5 |
| 61 | 10552 | GARDINER PLACE (C-EA) | D1 | Pedestrian Crossing | at the junction | 06/02/2014 | Stage 4 |
| 62 | 10559 | HILL STREET (C-EA) | D1 | 3 Tonne Limit | at the junction of Parnell Street. | 05/02/2014 | Stage 4 |
| 63 | 10580 | FAUSSAGH AVENUE (C-EA) | D7 | Traffic Calming | update on traffic calming request at this junction | 11/02/2014 | Stage 2 |
| 64 | 10593 | HOME FARM ROAD (C-EA) | D9 | Pedestrian Crossing | at the junction of Walsh Road. | 07/02/2014 | Stage 2 |

| | | | | | | | |
|----|-------|-------------------------------|----|--|--|------------|---------|
| 65 | 10622 | WOLFE TONE STREET (C-EA) | D1 | Pay & Display & Permit Parking | extend Pay and Display and Permit Parking to facilitate residents who have reduced parking due to DublinBikes Station. | 31/01/2014 | Stage 5 |
| 66 | 10626 | HOME FARM ROAD (C-EA) | D9 | School Warden | at the junction of Walsh Road. | 07/02/2014 | Stage 2 |
| 67 | 10638 | CARNLOUGH ROAD (C-EA) | D7 | Engineer Query | query in relation to HGV use of Carnlough Rd. | 07/02/2014 | Stage 4 |
| 68 | 10710 | HALSTON STREET (C-EA) | D7 | Disabled Parking Bay (General) | at St. Michan's Church. | 12/02/2014 | Stage 2 |
| 69 | 10730 | KIRWAN STREET COTTAGES (C-EA) | D7 | Double Yellow Lines | Requesting retention of the installed dyl's. | 13/02/2014 | Stage 2 |
| 70 | 10799 | CAPEL STREET (C-EA) | D1 | Pedestrian Crossing | at the junction of Ryder's Row. | 19/02/2014 | Stage 2 |
| 71 | 10819 | CUSTOM HOUSE QUAY (C-EA) | D1 | Multiple | No Right Turn, and Contra flow bus and cycle lane. | 19/02/2014 | Stage 4 |
| 72 | 10860 | IRVINE COURT (C-EA) | D3 | Double Yellow Lines | along the outside corner at the junction of Irvine Court and Irvine Terrace. | 24/02/2014 | Stage 4 |
| 73 | 10882 | EDEN QUAY (C-EA) | D2 | Multiple | Bus Lane/Cycle Lane | 25/02/2014 | Stage 4 |
| 74 | 10901 | CABRA ROAD (C-EA) | D7 | Disabled Parking Bay (General) | outside St. Michael's House, No. 75. | 26/02/2014 | Stage 4 |
| 75 | 10978 | VIKING ROAD (C-EA) | D7 | Disabled Parking Bay (Residential) | outside No. 45. Pay and display and permit parking will have to be rescinded. | 04/03/2014 | Stage 4 |
| 76 | 10981 | WOLFE TONE STREET (C-EA) | D1 | Coach Parking | To regularise marking already in place. STAT No. 22835 refers. | 04/03/2014 | Stage 5 |
| 77 | 11045 | BAGGOT ROAD (C-EA) | D7 | Right Turn Filter Light | requesting Right Turn Filter and layout changes. | 06/03/2014 | Stage 4 |
| 78 | 11085 | WILLIAM STREET NORTH (C-EA) | D1 | Yellow Box | at the junction of Catherine Court. | 11/03/2014 | Stage 2 |
| 79 | 11170 | CONYNGHAM ROAD (C-EA) | D8 | Double Yellow Lines | on roadway at bus depot between east 'entry' gate and west 'exit' gate. | 18/03/2014 | Stage 4 |
| 80 | 11190 | WOLFE TONE STREET (C-EA) | D1 | Pay & Display & Permit Parking (change of hours) | Extend operational hours to Mon-Sun 07.00-24.00, from the junction with Parnell Street to the junction with Mary Street. | 14/03/2014 | Stage 4 |

| | | | | | | | |
|----|-------|------------------------------|----|--|--|------------|---------|
| 81 | 11221 | STONEY ROAD (C-EA) | D3 | Speed Ramps | on the road. | 19/03/2014 | Stage 4 |
| 82 | 11237 | SHERRARD STREET LOWER (C-EA) | D1 | Double Yellow Lines (Extend) | on either side of the continuous white line at the junction of North Circular Road | 19/03/2014 | Stage 2 |
| 83 | 11292 | CONYNGHAM ROAD (C-EA) | D8 | Clearway (Amend Hours) | to rescind the morning clearway. | 24/03/2014 | Stage 4 |
| 84 | 11294 | ARD RI ROAD (C-EA) | D7 | Disabled Parking Bay (Rescind Residential) | outside No. 3 | 20/03/2014 | Stage 4 |
| 85 | 11316 | DE COURCY SQUARE (C-EA) | D9 | Double Yellow Lines | at the corners. | 25/03/2014 | Stage 4 |
| 86 | 11318 | CUSTOM HOUSE QUAY (C-EA) | D1 | Bus Lane | Rescind Bus Lane and replace with "off side bus lane with flow" at same location. | 12/03/2014 | Stage 5 |
| 87 | 11377 | KEMPTON WAY (C-EA) | D7 | Speed Ramps | on the road. | 26/03/2014 | Stage 2 |
| 88 | 11398 | ORMOND QUAY UPPER (C-EA) | D7 | Yellow Box | When pulling away from the bus stop at Ormond Quay/Hotel. | 25/02/2014 | Stage 2 |
| 89 | 11415 | CLONLIFFE ROAD (C-EA) | D3 | Disabled Parking Bay (Rescind Residential) | outside No. 51. | 27/03/2014 | Stage 4 |
| 90 | 11419 | RATHDOWN ROAD (C-EA) | D7 | Pay & Display & Permit Parking | In the triangle area at the junction of Rathdown Road and Grangegorman Upper. | 27/03/2014 | Stage 2 |
| 91 | 11438 | SAINT IGNATIUS ROAD (C-EA) | D7 | Double Yellow Lines | on access to laneway adjacent to No. 24 Saint Ignatius Road. | 31/03/2014 | Stage 4 |
| 92 | 11448 | CLONLIFFE AVENUE (C-EA) | D3 | Road Closure | at the stretch of Clonliffe Avenue that leads to Clonliffe Road. | 31/03/2014 | Stage 2 |
| 93 | 11466 | MARY STREET LITTLE (C-EA) | D7 | Double Yellow Lines | on the south eastern side of Mary St Little (see attached request) | 01/04/2014 | Stage 4 |
| 94 | 11475 | SKREEN ROAD (C-EA) | D7 | Traffic Lights | at the junction of Navan Road. | 01/04/2014 | Stage 2 |
| 95 | 11485 | MILLBOURNE AVENUE (C-EA) | D9 | Pay & Display & Permit Parking | on the road. | 01/04/2014 | Stage 2 |

| | | | | | | | |
|-----|-------|-----------------------------------|-----|--|--|------------|---------|
| 96 | 11486 | DE COURCY SQUARE (C-EA) | D9 | Double Yellow Lines | at the bollards at the western side of the square. | 01/04/2014 | Stage 4 |
| 97 | 11522 | WOLFE TONE STREET (C-EA) | D1 | Pay & Display & Permit Parking (change of hours) | Extend operational hours to Mon-Sun 07.00-24.00, from the junction with Parnell Street to the junction with Mary Street. | 07/04/2014 | Stage 4 |
| 98 | 11532 | RATHDOWN ROAD (C-EA) | D7 | Pay & Display & Permit Parking | In the triangle area at the junction of Rathdown Road and Grangegorman Upper. | 07/04/2014 | Stage 2 |
| 99 | 11562 | ARBOUR HILL (C-EA) | D7 | No Left Turn | 'No Left Turn' from Arbour Hill onto Arbour Place, between 8 am to 10 am | 03/04/2014 | Stage 4 |
| 100 | 11569 | DALCASSIAN DOWNS (C-EA) | D11 | Pay & Display & Permit Parking | or double yellow lines on the road. | 08/04/2014 | Stage 2 |
| 101 | 11578 | LANGRISHE PLACE (C-EA) | D1 | Disabled Parking Bay (Residential) | Outside No. 4. Pay and Display and Permit Parking will have to be recinded. | 04/04/2014 | Stage 4 |
| 102 | 11583 | CHURCH AVENUE (C-EA) | D9 | | parking provision at the Glasnevin Educate Together National School. | 03/04/2014 | Stage 2 |
| 103 | 11619 | GLASNEVIN WOODS (C-EA) | D11 | Speed Ramps | on the road. | 07/04/2014 | Stage 2 |
| 104 | 11667 | NAVAN ROAD (C-EA) | D7 | Traffic Lights | at the exit of Mary Help of Christians Girls National School and St. John Bosco Boys School. Entrance beside the church. | 09/04/2014 | Stage 2 |
| 105 | 11705 | NORTH CIRCULAR ROAD (C-EA) | D7 | Double Yellow Lines | In order to provide a servicing area for the new Dublin Bike Station. | 10/04/2014 | Stage 5 |
| 106 | 11811 | SAINT VINCENT STREET NORTH (C-EA) | D7 | Double Yellow Lines | on Saint Vincent Street North | 16/04/2014 | Stage 4 |
| 107 | 11812 | DALCASSIAN DOWNS (C-EA) | D11 | Pay & Display & Permit Parking | or double yellow lines on the road. | 15/04/2014 | Stage 2 |
| 108 | 11813 | DALCASSIAN DOWNS (C-EA) | D11 | Pay & Display & Permit Parking | or double yellow lines on the road. | 16/04/2014 | Stage 2 |
| 109 | 11814 | O'CONNELL AVENUE (C-EA) | D7 | Double Yellow Lines | on O' Connell Avenue. | 16/04/2014 | Stage 4 |
| 110 | 11827 | SAINT ANNE'S ROAD (C-EA) | D9 | Speed Ramps | on the road. | 15/04/2014 | Stage 4 |
| 111 | 11828 | SAINT ANNE'S ROAD (C-EA) | D9 | Children Crossing Sign | on the road. | 15/04/2014 | Stage 4 |

| | | | | | | | |
|-----|-------|--------------------------------|-----|--|--|------------|---------|
| 112 | 11831 | KIRWAN STREET COTTAGES (C-EA) | D7 | Double Yellow Lines (Rescind) | Appeal installation of dyl's. | 14/03/2014 | Stage 2 |
| 113 | 11866 | DORSET STREET UPPER (C-EA) | D1 | Yellow Box | at the junction of Bethesda Place. | 16/04/2014 | Stage 4 |
| 114 | 11920 | MILLMOUNT AVENUE (C-EA) | D9 | Parking Prohibition | On Millmount Avenue. | 24/04/2014 | Stage 4 |
| 115 | 11921 | MILLMOUNT AVENUE (C-EA) | D9 | Buildout | On Millmount Avenue. | 24/04/2014 | Stage 4 |
| 116 | 11923 | DALCASSIAN DOWNS (C-EA) | D11 | Pay & Display & Permit Parking | Follow-up on request for Pay & Display Permit Parking for Dalcassian Downs. | 23/04/2014 | Stage 2 |
| 117 | 11966 | WESTERN WAY (C-EA) | D2 | Pay & Display & Permit Parking (Rescind) | To facilitate Bike Station. | 28/04/2014 | Stage 5 |
| 118 | 11976 | HARDWICKE PLACE (C-EA) | D1 | Double Yellow Lines | to facilitate a Dublin Bikes Station. | 28/04/2014 | Stage 5 |
| 119 | 12050 | QUARRY ROAD (C-EA) | D7 | Double Yellow Lines | at the junction of Faussagh Avenue. | 29/04/2014 | Stage 4 |
| 120 | 12063 | MILLBOURNE AVENUE (C-EA) | D9 | Pay & Display & Permit Parking | on the road. | 30/04/2014 | Stage 2 |
| 121 | 12065 | PRUSSIA STREET (C-EA) | D7 | Right Turn Filter Light | From Prussia Street onto North Circular Road | 13/05/2014 | Stage 2 |
| 122 | 12066 | CHURCH ROAD (C-EA) | D3 | Traffic Calming | Request for measures to reduce speeds and levels of traffic | 13/05/2014 | Stage 3 |
| 123 | 12067 | ABERCORN ROAD (C-EA) | D3 | Traffic Calming | Request for measures to reduce speeds and levels of traffic | 13/05/2014 | Stage 2 |
| 124 | 12085 | CUMBERLAND STREET NORTH (C-EA) | D1 | Coach Parking | Westside, rescind pay and display parking between the junctions of Parnell Street and Britain Place and replace with Coach Parking. | 01/05/2014 | Stage 5 |
| 125 | 12087 | NORTH WALL QUAY (C-EA) | D1 | No Left Turn (Rescind) | Rescind 'No Left Turn' for buses only, From North Wall Quay onto Samuel Beckett Bridge | 15/04/2014 | Stage 2 |
| 126 | 12100 | DRUMCLIFFE DRIVE (C-EA) | D7 | Speed Ramps | on the road. | 01/05/2014 | Stage 2 |
| 127 | 12117 | CUSTOM HOUSE QUAY (C-EA) | D1 | Bus Lane | Rescind Stat No. 25048 and replace with the following:- Off Side Bus Lane with flow, southside, (inbound) from a point 100 metres east of the junction with Memorial Road, extending westwards for 100 metres to the stop line, (Mon-Sun/24hr) | 06/05/2014 | Stage 5 |

| | | | | | | | |
|-----|-------|------------------------------|----|--|--|------------|---------|
| 128 | 12144 | LEIX ROAD (C-EA) | D7 | Double Yellow Lines | In the vicinity of No. 7. | 06/05/2014 | Stage 2 |
| 129 | 12149 | DOMINICK PLACE NEW (C-EA) | D1 | Multiple | No Entry/Stop Sign and Double Yellow Lines as part of new link road associated with LUAS Cross City. | 06/05/2014 | Stage 4 |
| 130 | 12221 | WALSH ROAD (C-EA) | D9 | Speed Ramps | in the vicinity of No. 27. | 12/05/2014 | Stage 4 |
| 131 | 12255 | LEIX ROAD (C-EA) | D7 | Double Yellow Lines | at the junction | 13/05/2014 | Stage 4 |
| 132 | 12295 | SAINT IGNATIUS ROAD (C-EA) | D7 | Pay & Display & Permit Parking | and rescindment of Disabled Parking Bay outside No. 56. | 13/05/2014 | Stage 4 |
| 133 | 12301 | MAYOR STREET LOWER (C-EA) | D1 | Loading Bay | reps for Loading Bay on Mayor Street Lower | 11/05/2014 | Stage 4 |
| 134 | 12329 | SEAVIEW AVENUE (C-EA) | D3 | Yellow Box | At junction with Haddon Park(near the Paddocks) | 19/05/2014 | Stage 2 |
| 135 | 12367 | HOME FARM ROAD (C-EA) | D9 | No Left Turn (Rescind) | From Homefarm Road onto Drumcondra Road. | 19/05/2014 | Stage 2 |
| 136 | 12376 | DE COURCY SQUARE (C-EA) | D9 | Disabled Parking Bay (Rescind Residential) | outside No. 36. Pay and Display and Permit Parking will have to be installed. | 08/05/2014 | Stage 4 |
| 137 | 12515 | RICHMOND STREET NORTH (C-EA) | D1 | School Keep Clear | Yellow zig-zag lines o/s the gates of O' Connell Christian Brothers Secondary School, North Richmond St. | 20/05/2014 | Stage 2 |
| 138 | 12517 | CUSTOM HOUSE QUAY (C-EA) | D1 | Cycle Track | Mandatory Cycle Lane, northside, from its junction with Beresford Place to its junction with Memorial Road (24hrs, Mon-Sat). | 22/05/2014 | Stage 5 |
| 139 | 12523 | EDEN QUAY (C-EA) | D2 | Loading Bay | Northside, from a point 5 metres east of Marlborough Street, running east for 13m (Rescind Loading Bay) | 21/05/2014 | Stage 5 |
| 140 | 12581 | OLD CABRA ROAD (C-EA) | D7 | Pedestrian Crossing | Pedestrian Crossing for Old Cabra Road in the Glenbeigh Area, due to heavy traffic volumes. | 23/05/2014 | Stage 2 |
| 141 | 12615 | QUARRY ROAD (C-EA) | D7 | Speed Ramps | on the road. | 28/05/2014 | Stage 4 |
| 142 | 12640 | SAINT CLEMENTS ROAD (C-EA) | D9 | Speed Ramps | on the road. | 29/05/2014 | Stage 2 |

| | | | | | | | |
|-----|-------|----------------------------------|----|--------------------------------|--|------------|---------|
| 143 | 12642 | SAINT BRIGID'S ROAD LOWER (C-EA) | D9 | No Left Turn (Rescind) | from St. Brigid's Road Lower onto Whitworth Road, during morning peak | 29/05/2014 | Stage 2 |
| 144 | 12644 | SAINT PATRICK'S ROAD (C-EA) | D9 | No Left Turn (Rescind) | from St. Patrick's Road onto Whitworth Road, during morning peak. | 29/05/2014 | Stage 2 |
| 145 | 12646 | SAINT PATRICK'S ROAD (C-EA) | D9 | Traffic Calming | on the road. | 29/05/2014 | Stage 2 |
| 146 | 12669 | LITTLE BRITAIN STREET (C-EA) | D7 | Traffic Lights | one way street sign is constantly ignored by drivers and the road is a hazard for pedestrians to cross. | 03/06/2014 | Stage 1 |
| 147 | 12716 | MARY'S LANE (C-EA) | D7 | Loading Bay | in the area opposite Nos. 8-11. | 06/06/2014 | Stage 1 |
| 148 | 12722 | IONA AVENUE (C-EA) | D9 | Pay & Display & Permit Parking | and rescindment of Disabled Parking Bay outside No. 5. | 09/06/2014 | Stage 1 |
| 149 | 12739 | CHURCH STREET NEW (C-EA) | D7 | Coach Parking (Rescind) | Relocation of Disabled Parking bay from north to south side of road to facilitate coach turning | 10/06/2014 | Stage 4 |
| 150 | 12769 | GARDINER STREET LOWER (C-EA) | D1 | School Warden Crossing Box | opposite 85 Lower Gardiner Street | 11/06/2014 | Stage 1 |
| 151 | 12789 | DORSET STREET UPPER (C-EA) | D1 | Yellow Box | at the junctiono of Bethesda Place. | 11/06/2014 | Stage 4 |
| 152 | 12790 | BETHESDA PLACE (C-EA) | D1 | Double Yellow Lines | on the road. | 11/06/2014 | Stage 1 |
| 153 | 12809 | FOSTER TERRACE (C-EA) | D2 | Traffic Calming | Request for additional traffic calming measures. | 12/06/2014 | Stage 4 |
| 154 | 12815 | OLD CABRA ROAD (C-EA) | D7 | Pedestrian Crossing | near junction with Glenbeigh Road. | 09/06/2014 | Stage 2 |
| 155 | 12869 | AMIENS STREET (C-EA) | D1 | No U Turn | at its junction with Talbot Street - cars are taking up position to turn right from Amiens St onto Talbot St. but are then doing a u turn. | 03/06/2014 | Stage 1 |

- Stage 5 - Implementation, signs, lines, construction, signal changes, certifications, etc

The Chairperson and Members of
Central Area Committee

Environmental Services Unit Report May/June 2014

N.I.C.L.A.G

As previously discussed at the May Area Committee meeting, a pilot project is now proceeding with the delivery of bins to D.C.C tenancy houses with space for bin storage in an effort to reduce the number of bags being presented on the streets. The area will be monitored after the bins are delivered to see if the desired effect is achieved.

City Neighbourhoods

Judging of the entries for the City Neighbourhoods competition took place in June. The awarding of the prizes will take place in September. The winners of each category in the Central Area will go forward to represent the area in the city wide competition.

Weed Spraying

The second weed spraying programme for the Central Area will commence on 3rd July 2014, this spray will take approximately two weeks to complete weather permitting.

Graffiti Removal

Graffiti has been removed from the following areas using the Probation Services from 1st May – 30th June

North Frederick Street, D.1
Sheriff Street Upper, D.1
Blessington Court Laneway, D.7
Lower and Upper Ormond Quay, D.7
Ormond Lane, D.7
Ormond Place, D.7
The Markets, D.7

Graffiti has been removed from the following areas using the Corporate Contractor from 1st May – 30th June

Lower Liffey Street, D.1
North Cumberland Street, D.1
Parnell Street, D.1
Killarney Street, D.1
Wolfe Tone Park, D.1

Dorset Street Lower, D.1
Great Strand Street junction, D.1
George's Avenue, D.3
Blackhorse Avneue, D.7
Dunard Park, D.7
Dunrad Walk, D.7
Royal Canal Bank, D.7
Parkgate Street, D.7
Whyte's Lane, D.7
Mountjoy Square, D.7
Phibsborough Road, D.7
Mountjoy Street, D.7
St Marys Place, D.7
Berkeley Road, D.7
North King Street, D.7
Ellis Court, D.7
Smithfield Plaza, D.7
Lower Ormond Quay, D.7
Botanic Road, D.9

***Total graffiti removed using Corporate Contractor 680sqm
Graffiti has been removed from the following areas using Dublin City Council Waste
Management Services from 1st May – 30th June***

Rutland Place, D.1.
Ryders Row, D.1
Summerhill Bridge, D.1.
Summerhill/Langrishe Place, D.1.
47/48 Parnell Square, D.1.
NCR, D.1.
Hardwicke Lane, D.1
North Lotts, rear of the bachelor pub, D.1
Castleforbes Road, D.1.
Spencer Dock Bridge, D.1.
NCR/summerhill junction, D.1
Linear Park, Guild Street, D.1
Sean MacDermott Lower, D.1.
Empress Place, D.1
Belvedere Court, D.1.
Temple Lane, D.1. graffiti in laneway.
Rutland Place, D.1.
Hyacinth Street, off Ossory Rd, D.3
Ossory Road, D.3.
West Rd, East Wall, D.3.
East Wall Road, D.3.
Annesley Close, D.3.
Ennaville Avenue, D.3.
Springgarden Street, D.3.
150 North Stand Road, D.3.
2-6 Ballybough Road, D.3
George's Avenue, Off Clonliffe Road, D.3.
Balls Lane, D.7.
Saint Peters Court, D.7.

5 Blackhall Place, D.7.
3 Manor Street, D.7
20 Manor Street, D.7
35/36 Sitric Road, D.7
Stable Lane, D.7.
Bow Lane, D.7.
Mountjoy Street, D.7.
438 NCR, D.7.
43 & 45 Kinvara Park, D.7
Beresford Street/North King Street, D.7
Brown Street North, D.7
Temple Street West, D.7.
Smithfield Plaza, D.7.
Berkeley Rd/NCR, D.7
6 Aughrim Street, D.7
Prussia Street, D.7
Prussia Street, D.7
Manor Street, D.7
Stoneybatter, D.7
Hendrick Street, D.7
Wood Lane, D.7
Benburb Street, D.7
Liffey Street West, D.7
John Street North, D.7
Lincoln Lane, D.7
1 Glenbrook Road, D.7.
Lower Ormond Quay, D.7.
Western Way, D.7.
North Brunswick Street, D.7.
Temple Cottages, D.7
Dunard Road, D.7.
Aughrim Street, D.7.
outside 46 St Mobhi Road, D.9.
Griffith Avenue and Saint Mobhi Road, D.9.
Ballymun Road, D.9.
36 DeCourcy Square, D.9
Saint Anne's Road, D.9

Environmental Response Unit

A total of 187 incidents were attended to by the Environmental Response Unit in the period 1st May – 30th June with 93 tonnes of dumped material removed.

Litter Warden Statistics

There were a total of 171 Fines and 4 Warning Letters issued by the area based Litter Wardens in the Central Area for littering offences in the period 1st May – 30th June

511 Streets were inspected by the area based Litter Wardens

1,481 Dumped bags were removed
 1,571 Dumped bags were investigated
 411 Dumped or wrongly presented bags were labelled with warning stickers
 6 Gardens were inspected

Litter Hotline/CRM

In the period 1st May – 30th June 258 incidents were reported via Litter Hotline/CRM.

| | |
|--------------------------------|-----|
| Abandoned Bicycles or Trolleys | 7 |
| Community Cleanups | 8 |
| Electoral Poster Complaint | 17 |
| FYS: Graffiti | 14 |
| FYS: Illegal Dumping | 116 |
| Illegal Dumping | 231 |
| Report Graffiti | 5 |
| Report Litter Offence | 29 |
| Sweep Your Street | 6 |
| Weed Control | 3 |

Community Forum Update

Drumcondra/Glasnevin Community Forum

The last meeting of the Drumcondra/Glasnevin Community Forum was held on 11th June 2014. The main issues raised were:

- Croke Park and associated anti-social behaviour
- Enabling works on Upper Drumcondra Road
- Litter
- Illegal parking, road markings and double yellow lines
- Road Maintenance issues

The next meeting will take place on 24th September 2014.

East Wall Community Forum

The last meeting of the East Wall Community Forum was held on 28th May 2014. The main issues raised were:

- Traffic Issues/Commuter Parking
- Dog fouling

- Road Maintenance Issues
- Illegal Dumping
- Children at Play signs

The next meeting will take place on 3rd September 2014.

Mountjoy and District Community Forum

The last meeting of the Mountjoy and District Community Forum was held on 3rd June 2014. The main issues raised were:

- Anti-social behaviour
- Illegal dumping and bin collections
- Dog fouling
- Hostels in area
- Private landlords

The next meeting will take place on 2nd September 2014

North East Inner City Community Forum

The last meeting of the North East Inner City Community Forum took place on 17th June 2014. The main issues raised were:

- Drug dealing, loitering and anti-social behaviour, particularly around the Pro-Cathedral and Talbot Street
- Illegal parking and other traffic issues
- Illegal dumping

The next meeting will take place on 23rd September 2014.

North Strand/Ballybough/East Wall Community Forum

The last meeting of the North Strand/Ballybough/East Wall Community Forum took place on 9th June 2014. The main issues raised were:

- HGVs on East Wall Road
- Illegal dumping
- Road cleaning
- Dog Fouling
- Road Maintenance Issues
- Permanent Message Boards

The next meeting will take place on 15th September 2014.

North Wall Community Forum

The last meeting of the North Wall Community Forum took place on 19th June 2014. The main issues raised were:

- Crime, drug dealing and anti-social behaviour
- Operation Spire
- The Docklands SDZ
- Royal Canal Green Route

The next meeting will take place on 25th September 2014.

Central Area Joint Policing Sub-committee

The last meeting of the Central Area Joint Policing Sub-committee was held on 30th June 2014. The main issues raised and discussed were:

- New community policing initiative – Small Areas Policing
- Various ongoing Garda operations
- Various issues relating to crime and anti-social behaviour

The next meeting will take place on 29th September, 2014.

**The Chairperson and Members of
Central Area Committee**

North West Inner City Housing Report – July 2014

Liberty House (Peadar Kearney House)

Works commenced on site on January 2nd 2013. The contract allows for a 104 week construction programme. Work is progressing well and Duggan Brothers Ltd. are confident they can complete the project on or before the scheduled programme completion.

The first phase of units were handed over in May and have been fully tenanted. The second, and final, phase is due to be completed in August/September. Circle Voluntary Housing Association is managing the complex and will be completing interviews for the second phase of units shortly. Nominations for all units were submitted to Circle in March and when all remaining nominated applicants have been interviewed Circle will confirm allocation of the units in the second phase. It should be noted that applicants who were interviewed for the first phase but were not offered a unit will be considered for suitable units in the second phase.

As part of the development a fence will be erected in front of the new building overlooking Liberty Park. This will provide a distinct boundary between the park and the complex and will increase security for residents in the complex. Some landscaping and redesign works will also be carried out in the park at the same time and for that reason the park is currently closed.

St. Mary's Mansions

As a result of internal discussions around the future of St. Mary's Mansions, a decision was made to transfer management of the complex to Cluid Housing Association. They were requested to prepare a Feasibility Study on the transfer of the complex, with the tenants in situ, by April 2013. They have now completed this report and it was submitted to Housing Development on June 2013. This report has been examined by Housing Development and a meeting was held Cluid in early July to discuss the report and try and progress the matter. Cluid were requested to revisit the report with a view to providing a more in depth response to a number of issues raised by Housing Development. They have now submitted more information and a meeting took place on October 2013 to discuss the matter further. As a result of this meeting a joint Cluid/DCC presentation and discussion took place with residents in early December. The meeting was not well attended and while residents who did attend were generally happy with the proposal many still had reservations about transferring to Cluid. As a result of the poor turnout a survey was carried out with individual tenants by DCC staff in January 2014 to gauge what level of support exists for the transfer of the complex. The results of the survey indicate overwhelming support for the proposal although it will be necessary to carry out further discussions with tenants around their individual requirements. Cluid are continuing these in depth discussions with individual residents and hope to have met with all tenants by the end of July. They also hope to have a consultant in place shortly to meet with residents and further develop the preliminary plans which residents were previously shown.. As discussed at the meeting with

Councillors in December 2014, should this proposal fall there are no alternative plans, or funding, for the redevelopment of St. Mary's Mansions.

Patrick Heeney House and Crescent

The issues in relation to heating and water ingress are still being dealt with by City Architects.

Pilot remedial works to address falling pressure in the heating system, in some units, was undertaken in mid November in one unit. The outcome of these works were being monitored to ensure that they have resolved the issue. Unfortunately the contractor experienced extreme difficulties in getting access to the unit to check whether the remedial works were successful, although the tenant has not made any further complaints since the works were carried out. A number of other units were identified for similar works but some tenants have refused to allow these works to be carried out because it involves repiping the system and installing wall mounted pipework.. City Architects are currently working through the list of units which required these works and any tenant on this list who wishes to have these works done will be facilitated in the near future.

Works to address water ingress to the roof/patio area re-commenced the week beginning June 10th. City Architects are satisfied these works have been successful and the same repairs will be carried out in the other affected units. City Architects have advised that works to all affected units will be completed by the end of July.

Summerhill

An issue in relation to litter and dirt gathering in the basement area of the 10 Houses on Summerhill, adjacent to Patrick Heeney House, has been ongoing for many years. The Attendants service have cleaned this area on occasion but for Health and Safety reasons that is no longer feasible. Following provision of funding DCC be sub divided the basement area by installation of railings, giving each tenant their own individual area which they will be responsible for keeping clean. This work has now been completed.

Father Scully House

Catholic Housing Aid Association (CHAS) have received approval and funding from the DOE to commence redevelopment of the site. The redevelopment will provide 100 social housing units for older persons. This will be comprised of 88 one bed units and 12 two bed units. CHAS have in the region of 35 tenants temporarily living in other complexes who are due to move back to the redeveloped complex. Construction commenced April 30th 2013. The project is progressing well but there has been some delay. The current completion date is now likely to be Mid August 2014.

Poplar Row, Taaffe Place, Annesley Avenue & Place – Pyrite Issues

An information meeting with residents affected by Pyrite, the Area Housing Manager and the Senior Structural Engineer was held in the Ballybough Community Centre on 18th June 2014. The purpose of this meeting was to give the residents the proposed timeframe for the resolving of these issues. A detailed survey of all affected dwellings has been carried out by a specialist contractor on behalf of Dublin City Council. The results of this survey will form the basis of works to be carried out and it is intended to start the tendering process shortly. It is proposed to carry out these works in three 10 to 12 week phases and to commence these works before the end of September 2014

A follow up meeting with the individual residents will be arranged with staff from City Architect's, the Contractor to outline the results of survey and to give a firm date on commencement of works after the tendering process has been completed.

Croke Villas

There are now 11 dwellings out of a total of 79 occupied in the complex. The Estate Manager is liaising with the remaining individuals/families in trying to identify suitable accommodation in the areas they have requested. However, this process is becoming more difficult with the remaining families in Croke Villas being very specific in where they want to be accommodated.

The Area Housing Manager is continuing to identify suitable properties for sale in Area H that would assist with the detenanting of this complex. These identified properties are submitted to Housing & Residential Services for consideration. Negotiations' between Dublin City Council and the Selling Agent's are ongoing with regard to 2 properties that have been inspected and agreement has been reached to purchase one house and one apartment to date.

A meeting was arranged with City Architects Department and all the house owners on Sackville Gardens. This meeting was held in March 2014 to discuss the Part 8 of numbers 2 – 5 Ballybough Road that was initiated by this committee at its April 2014 meeting.

Ballybough House

Housing Maintenance Division is continuing to refurbish the void dwellings in the complex.

There have been a total of two vacant dwellings broken into by a group who are known locally. These break-ins caused damage to two flats that were ready for allocation. The Estate Manager has been liaising with An Garda Siochana to try and identify the individuals involved in this criminality.

There problem of youth's from all parts of the North East Inner City Community congregating on the stairwell's in this complex has resurfaced over the past couple of months. The Estate Manager has been liaising with An Garda Siochana to identify the teenagers who have been congregating in the complex and if they are from Dublin City Council dwellings.

A meeting with residents, An Garda Siochana, Community Policing Forum and Dublin City Council staff took place on 25th June to explore ways of resolving the anti social behavior in this complex.

The Area Housing Manager & Estate Manager are continuing to meet with the Resident's Association monthly.

Nth Clarence Street/Dunne Street

There is a problem of anti social behaviour from a number of flats over the past couple of months in Dunne Street.

The Estate Manager has been liaising with An Garda Siochana to identify the individuals causing these problems in the complex and to take whatever action is required to resolve this problem.

The Area Housing Manager and Estate Manager are continuing to meet with the Resident's Association along with the Community Policing Forum.

Ballybough Road & Ballybough Avenue

Housing Maintenance Division have completed the process of improving the building energy rating (BER) by carrying out insulation works to 11 Dublin City Council houses in the above area.

Charlie Lowe
Area Manager

**The Chairperson and Members of
Central Area Committee**

North West Inner City Housing Report – July 2014

Dominick Street Lower

The new road has now been constructed as part of the Regeneration of Dominick Street Lower. Engineers from the Roads Construction Division have overseen the project and the Roads Design Division provided design support for the project. The road abandonment process and the new road opening will commence later this year.

Ongoing discussions with The Department of the Environment to identify funding for phase one. Discussions with the Department of Education regarding the disposal of part of the Dominick St site are ongoing, report to follow. Mc Closkey's have been awarded the contract for Utilities Diversion on the new LUAS Cross City Line.

Luas Cross City Works

Residents of Dominick St lower, Dominick House, Dominick Court and Dominick St Upper have been kept updated on the progress of the Luas Cross City (LCC) Project. LCC staff, the Contractor (GMC) together with D.C.C Estate Management discussed the programme of works with local residents. One Contractor is currently on-site in Dominick Street Lower/Upper.

GMC will be carrying out sewer lining works on the existing public sewers, they are currently reinforcing six chambers and numerous manholes in Dominick Street Lower. Works are soon to commence on relocating utilities such as Gas, Water and Electrics on Dominick Street Upper. These works are ongoing.

Hardwicke Street (Rory O'Connor House & Dermot O'Dwyer House)

Contractors are currently on site installing and upgrading the CCTV in the complex. Six roaming cameras and Seven fixed cameras will cover the complex and will be connected to the Housing Office Parnell Street.

Sheridan Court/Sheridan Place

Contractors are currently on site installing CCTV in the complex. Eight cameras have been installed and will be linked up to the Housing Office Parnell St. Works will be complete the first week in July 2014.

Constitution Hill

Necessary repair works on roofs on all three blocks are ongoing and due for completion the first week in July 2014.

Dorset Street

Ongoing meetings with Residents, Estate Management and An Garda Siobhan in relation to antisocial behaviour in the complex. The re-furbishment/up-grading of the complex is currently being examined, report to follow. Tenders visited the site early this year in relation to the demolition of Saint Mary Terrace No 1-24 and a Part 8 Report is before this Area Committee meeting today.

Friary Court

Works are ongoing on the installation of the "Emergency Pull Cord" system, for older persons units. Eircom have installed the new phone lines and Albert Electrical are currently working on installing the new system.

Ormond Square

The residents of Ormond Square, with the help of the Community Section, had their annual Plant Sale to raise some much needed funds, this event was a great success.

Kevin Barry House

Repair works on the roofs in Kevin Barry House are ongoing.

Summer Clubs/Events:

Hardwicke Street & Georges Place

Hardwicke St. & Georges Place have combined resources for the upcoming summer project which will commence on 7th July for 6 weeks. There will be two away trips each week for young people and their families and a variety of activities held each day in the recreation centre.

Georges Place has two women's groups who meet each Tuesday and Thursday night for social activities.

100 young people aged from 7-12 yrs old will take part in a Samba Soccer Day on Friday July 25th.

As part of National Bike Week, Hardwicke Street Recreation Centre hosted a bicycle training programme on June 17th which was attended by over 35 children and many local parents. The football pitch was converted into a bicycle obstacle course, with bikes and helmets provided by DCC.

Hardwicke Football Club currently manages and coach eight teams who train on the pitch attached to the recreation centre. At present they have 4 teenage boys on the NDSL representative team who are in Portugal for an internal football tournament. Mr. Anthony Perry (head coach) has also recently passed his FAI Youth Cert.

Dominick Street Lower

Lower Dominick Street summer project will commence on 7th July for 6 weeks. There will be two away trips each week for young people and their families. There will also be a variety of activities held each day in the recreation centre.

As part of national bike week Dominic Street Lower hosted a bicycle training programme on June 18th which was attended by 12 children, local parents and Community Garda. The football pitch was converted into a bicycle obstacle course with bikes and helmets provided by DCC.

The computer room is used regularly for ECDL (European Computer Driving Licence) examinations in association with CLIC (Computer Learning in Communities) & Dublin Institute of Technology.

The current fitness room is being re-developed thanks to a Capital Sports Grant recently awarded to the centre. The new equipment will be delivered within the next 7 weeks. It is hoped that the room will be ready for use in late August.

Each Monday & Wednesday morning a group of local women meet up and take part in a group exercise session in the hall area. Sports Development Office, Igor Khamill delivers part of the training programme on Wednesdays.

The centre is used regularly for local meetings and coffee mornings. It is also being used as a training venue for 50+ students who will work with DCC for the summer.

50 young people aged from 7-12 yrs old will take part in a Samba Soccer Day on Friday July 25th.

St. Pauls Recreation Centre, Blackhall

St. Paul's summer project will commence on 21st July for 6 weeks. There will be two away trips each week for young people and their families and a variety of activities held each day in the recreation centre.

Stoneybatter Youth Service now have their office staff (6 staff) located full time in the recreation centre and deliver high quality programmes for young people aged 10-21yrs old. The youth services have a full calendar of summer activities for a variety of communities in the Dublin 7 area.

50 young people aged form 7-12 yrs old will take part in a Samba Soccer Day on Friday July 25th.

The Following Complexes have ongoing meetings between residents and Estate Management and there are no outstanding issues.

- Chancery House
- Constitution Hill
- Dorset Street
- Henrietta House
- Blessington Street
- Dominick Court
- Dominick House/Palmerston Place
- Dominick Street Upper
- Georges Place
- Eccles Court
- Hardwicke Street
- Saint Peters Court
- Saint Michan's House
- Wolfe Tone Close
- Saint Mary's Terrace
- Kevin Barry House
- Sheridan Place/Court
- North King Street
- Blackhall Place/Marmion Court

Seán Smith

Area Housing Projects Manager

- Q1 Councillor Ciaran Cuffe**
To ask the Chief Executive (details supplied)
- Q2 Councillor Ciaran Cuffe**
To ask the Chief Executive (details supplied)
- Q3 Councillor Ciaran Cuffe**
To ask the Chief Executive (details supplied)
- Q4 Councillor Ciaran Cuffe**
To ask the Chief Executive (details supplied)
- Q5 Councillor Ciaran Cuffe**
To ask the Chief Executive (details supplied)
- Q6 Councillor Ciaran Cuffe**
To ask the Chief Executive (details supplied)
- Q7 Councillor Ciaran Cuffe**
To ask the Chief Executive (details supplied)
- Q8 Councillor Ciaran Cuffe**
To ask the Chief Executive (details supplied)
- Q9 Councillor Ciaran Cuffe**
To ask the Chief Executive (details supplied)
- Q10 Lord Mayor Christy Burke**
To ask the Chief Executive (details supplied)
- Q11 Lord Mayor Christy Burke**
To ask the Chief Executive (details supplied)
- Q12 Lord Mayor Christy Burke**
To ask the Chief Executive (details supplied)
- Q13 Lord Mayor Christy Burke**
To ask the Chief Executive (details supplied)
- Q14 Lord Mayor Christy Burke**
To ask the Chief Executive (details supplied)

- Q15** **Lord Mayor Christy Burke**
To ask the Chief Executive (details supplied)
- Q16** **Lord Mayor Christy Burke**
To ask the Chief Executive (details supplied)
- Q17** **Lord Mayor Christy Burke**
To ask the Chief Executive (details supplied)
- Q18** **Lord Mayor Christy Burke**
To ask the Chief Executive (details supplied)
- Q19** **Councillor Nial Ring**
To ask the Chief Executive (details supplied)
- Q20** **Councillor Nial Ring**
To ask the Chief Executive (details supplied)
- Q21** **Councillor Nial Ring**
To ask the Chief Executive (details supplied)
- Q22** **Councillor Nial Ring**
To ask the Chief Executive (details supplied)
- Q23** **Councillor Nial Ring**
To ask the Chief Executive (details supplied)
- Q24** **Councillor Nial Ring**
To ask the Chief Executive (details supplied)
- Q25** **Councillor Nial Ring**
To ask the Chief Executive (details supplied)
- Q26** **Councillor Nial Ring**
To ask the Chief Executive (details supplied)
- Q27** **Councillor Gary Gannon**
To ask the Chief Executive (details supplied)
- Q28** **Councillor Gary Gannon**
To ask the Chief Executive (details supplied)
- Q29** **Councillor Gary Gannon**
To ask the Chief Executive (details supplied)

- Q30** **Councillor Gary Gannon**
To ask the Chief Executive (details supplied)
- Q31** **Councillor Gary Gannon**
To ask the Chief Executive (details supplied)
- Q32** **Councillor Gary Gannon**
To ask the Chief Executive (details supplied)
- Q33** **Councillor Ray McAdam**
To ask the Chief Executive (details supplied)
- Q34** **Councillor Ray McAdam**
To ask the Chief Executive (details supplied)
- Q35** **Councillor Ray McAdam**
To ask the Chief Executive (details supplied)
- Q36** **Councillor Ray McAdam**
To ask the Chief Executive (details supplied)
- Q37** **Councillor Ray McAdam**
To ask the Chief Executive (details supplied)
- Q38** **Councillor Ray McAdam**
To ask the Chief Executive (details supplied)
- Q39** **Councillor Ray McAdam**
To ask the Chief Executive (details supplied)
- Q40** **Councillor Ray McAdam**
To ask the Chief Executive (details supplied)
- Q41** **Councillor Jonathan Dowdall**
To ask the Chief Executive (details supplied)

